





**CONSTRUCTION KEY**

-  existing retained
-  line over/under/behind
-  demolished
-  new construction

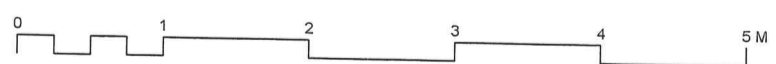
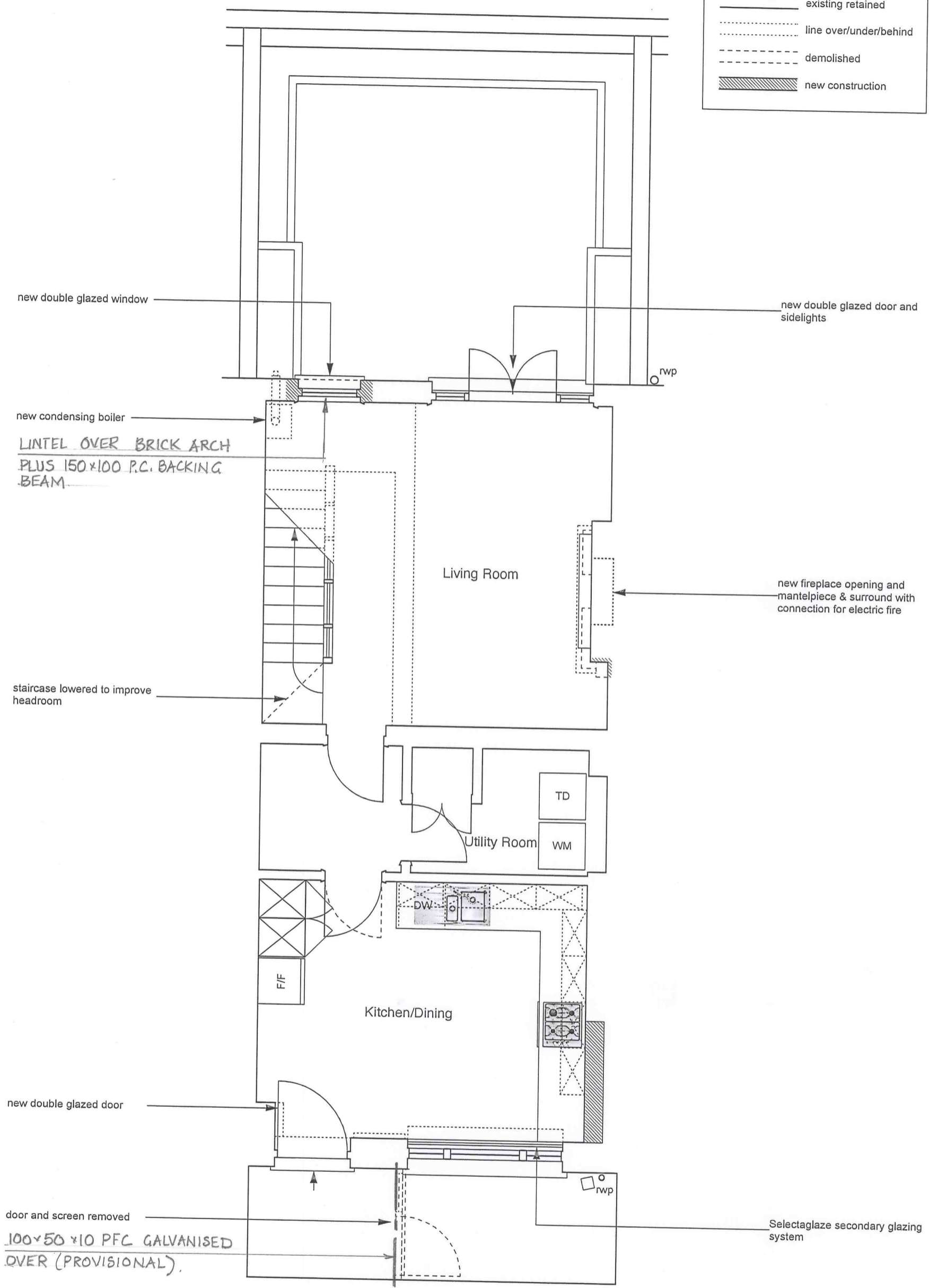

FOR NOTES SEE DWG NO SK00

	PROJECT 5 ARCHITECTURE LLP 8 Waterson Street London E2 8HL T: +44 (0)20 7739 9131 F: +44 (0)20 7739 3687 E: info@p5a.co.uk	job title 17 AMPTON STREET, LONDON WC1X 0LT
	drawing BASEMENT PLAN - PROPOSED	

<b>Ellis and Moore Ltd</b> CONSULTING ENGINEERS	Drawing No <b>14438 / Sk01</b> OPTION 1
--	---