

APPENDIX A

-

PLAN AND 3D VIEWS OF THE COMPUTER MODEL

DRAWING NOS. ROL6940_5_004 TO 006

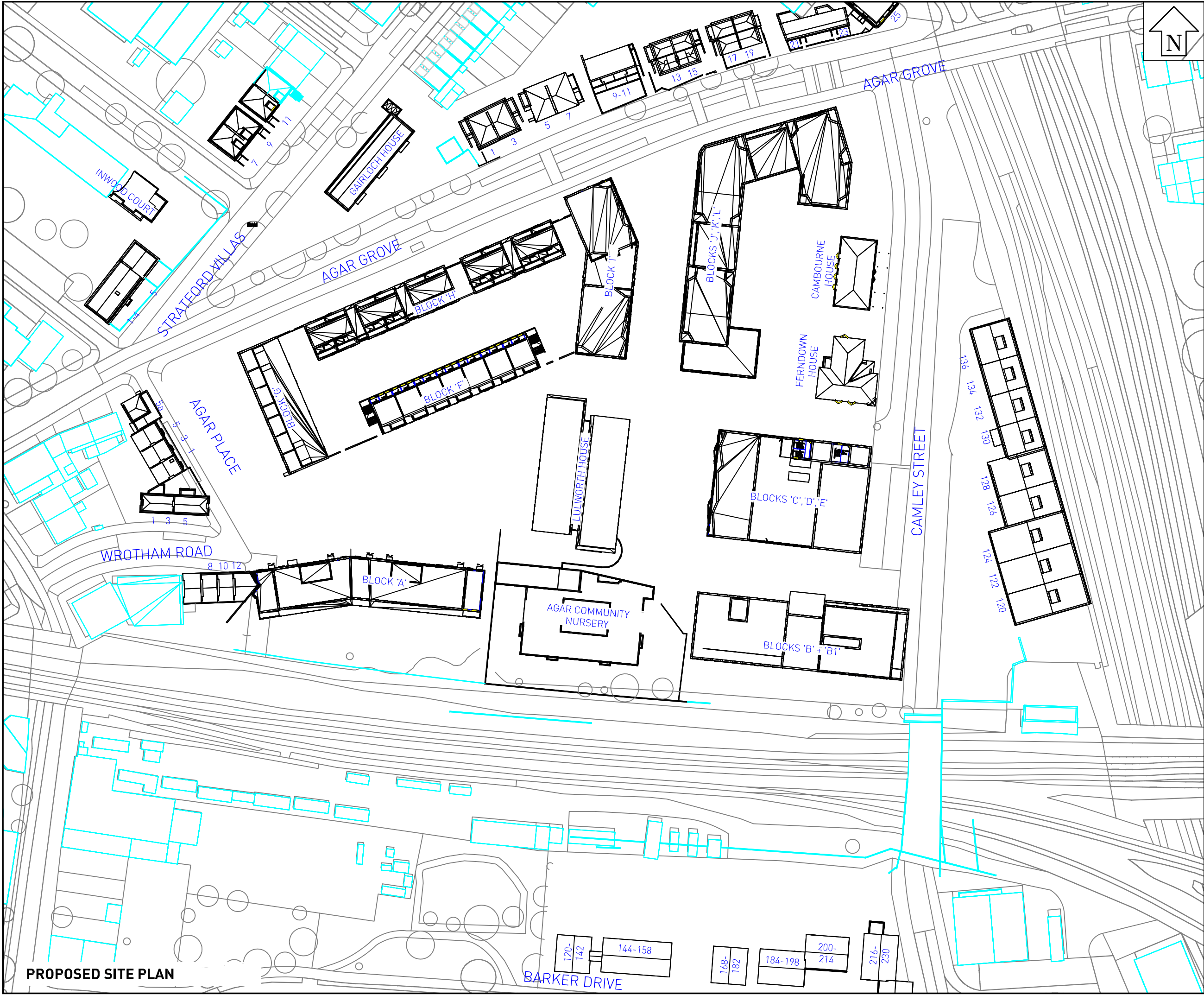

LEGEND:

- Existing
- Proposed
- Analysed
- Surrounding

SOURCES OF INFORMATION:

EXISTING, SURROUNDING & ANALYSED BUILDINGS

Greenhatch Group
3D CAD model received via e-mail on 25/07/13

Drawing reference:
18313A-Lulworth House - 3D.dwg

HawkinsBrown & MAE Architects
Sketch-up model received via e-mail on 03/07/13
(surrounding massing)

PROPOSED BUILDINGS

Cityscape
Sketch-up model received via e-mail on 10/12/13
Drawing reference: Agar Grove 2010 Full.DWG

REV	DESCRIPTION	DATE
-----	-------------	------

This drawing is the property of Anstey Home & Co. Ltd. All rights reserved.
This drawing should not be reproduced without permission.
Do not scale from this drawing.

CLIENT: LONDON BOROUGH OF CAMDEN

PROJECT TITLE: AGAR GROVE REGENERATION
CAMDEN
LONDON

DRAWING TITLE: PROPOSED SITE PLAN

PROJECT No: ROL6940	SCALE: 1:1000	DATE: 19/12/13
MODELLED BY: AW/TB	DRAWN BY: TB	SHEET SIZE: A3

DRAWING No: ROL6940_ 5 _004	REVISION:
-----------------------------	-----------

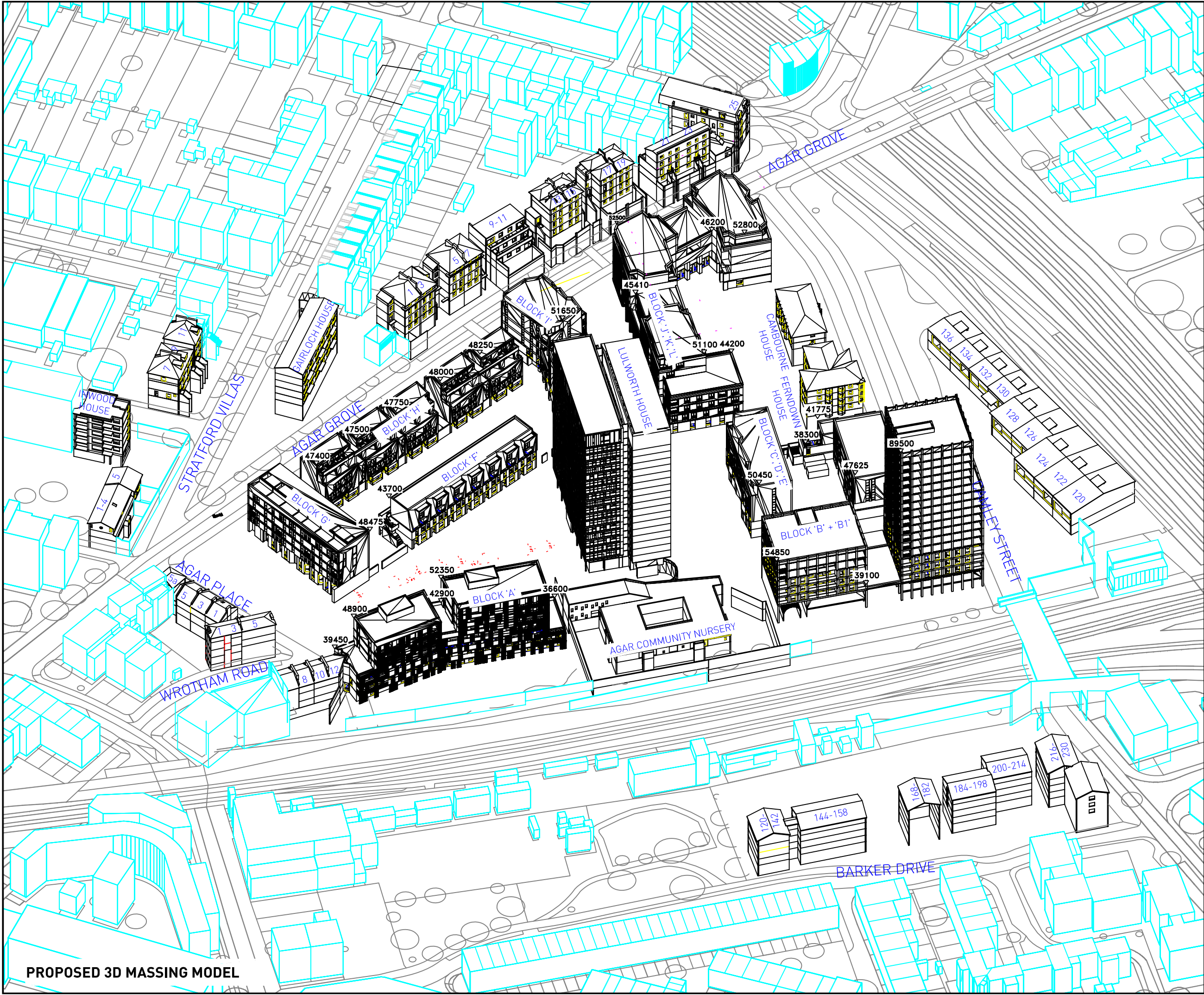

LEGEND:

- Existing
- Proposed
- Analysed
- Surrounding
- Site Boundary

SOURCES OF INFORMATION:

EXISTING, SURROUNDING & ANALYSED BUILDINGS

Greenhatch Group
3D CAD model received via e-mail on 25/07/13

Drawing reference:
18313A-Lulworth House - 3D.dwg

HawkinsBrown & MAE Architects
Sketch-up model received via e-mail on 03/07/13
(surrounding massing)

PROPOSED BUILDINGS

Cityscape
Sketch-up model received via e-mail on 10/12/13
Drawing reference: Agar Grove 2010 Full.DWG

REV	DESCRIPTION	DATE
-----	-------------	------

This drawing is the property of Anstey Home & Co. Ltd. All rights reserved.
This drawing should not be reproduced without permission.
Do not scale from this drawing.

CLIENT: LONDON BOROUGH OF CAMDEN

PROJECT TITLE: AGAR GROVE REGENERATION
CAMDEN
LONDON

DRAWING TITLE: PROPOSED 3D MASSING MODEL

PROJECT No: ROL6940	SCALE: N.T.S.	DATE: 19/12/13
MODELLED BY: AW/TB	DRAWN BY: AW	SHEET SIZE: A3

DRAWING No: ROL6940_ 5 _005

REVISION:

3D Massing Model

PROPOSED 3D MASSING MODEL

