

**Sequence of work:**

- 1 Install needles through base of wall and support these on temporary scaffold structure.
- 2 Construct temporary false floor for pedestrian access.
- 3 Install temporary steels under concrete bridge and support these on temporary Acro props (SWL=3T/prop).
- 4 Replace existing steels one at a time...
  - 4a Carefully cut out concrete around edge steel, but keep all other reinforcement intact.
  - 4b Free corroding steel and
  - 4c replace with new HDG steel min size 203x203UC46 wrapped in HDG D49 mesh.
  - 4d recast concrete surround ensuring full compaction.
- 5 Allow at least 48 hours for concrete to cure.
- 6 Remove Acro props, false floor, needles and temporary scaffold, make good holes in masonry.

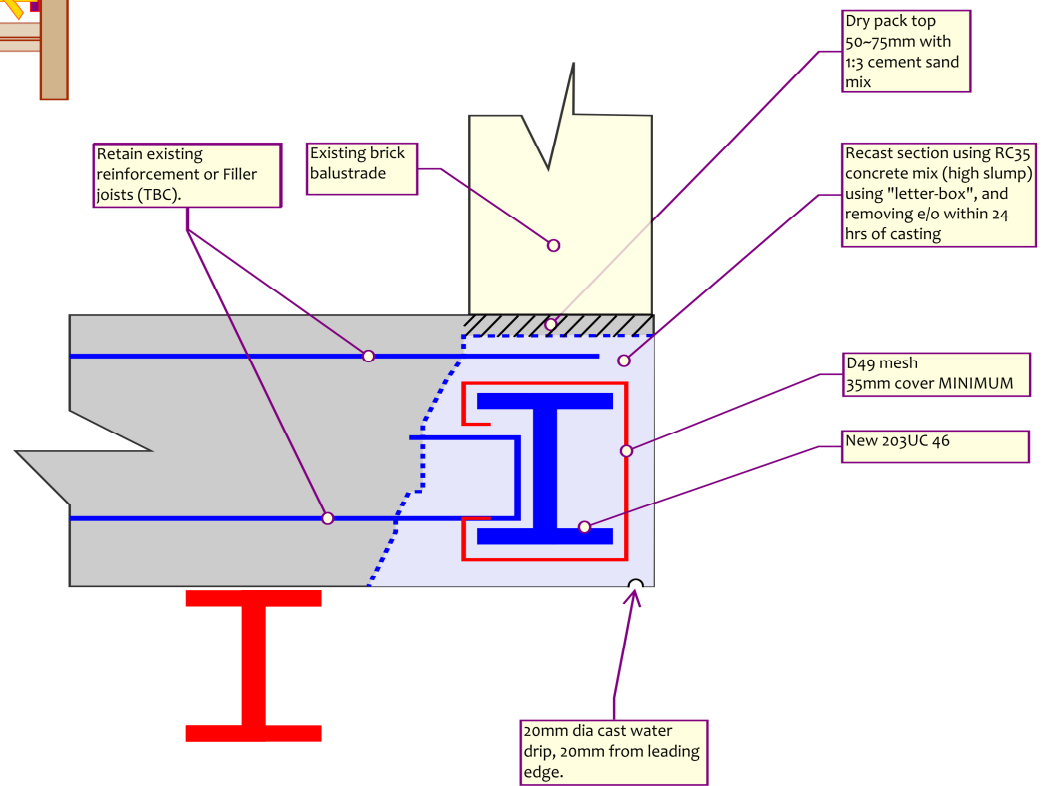
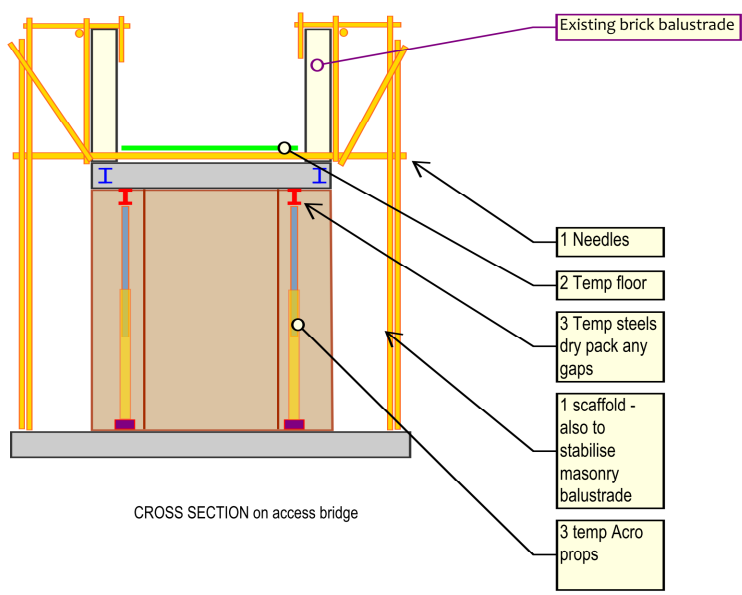

<b>Ellis &amp; Moore</b> CONSULTING ENGINEERS 9th Floor, Hill House, 17, Highgate Hill, London N19 5NA Telephone: 020 7281 4821	<b>Project</b> 48 Fortess Road <b>Entrance Bridge Repairs</b>	<b>Date</b> 05/11/13
	<b>Title</b> Plan sections and details	<b>Scale</b> NTS
		<b>Drawing No.</b> 14378/01