



CLARION BUILDING
CONSULTANTS LIMITED

This drawing remains the property of Clarion Building Consultants Ltd.
Copying and un-authorised distribution is strictly forbidden without prior
written consent.

Clarion Building
Consulting Ltd.
36 Stirling Road
St Leonards
East Sussex
TN38 9NP
(01424) 850951

Clarion Building
Consulting Ltd.
54a Church Road
Burgess Hill
West Sussex
RH15 9AE
(01444) 250722

Actual measurements to be checked onsite
Contractor to contact architect if errors are found and alternative design
is required
Structural engineers specification to take priority for detail(s)
In addition to these notes and drawings, reference shall be made to the
specification of works and the relevant Architects, Engineers and
Specialists drawings and specifications.
The contractor is responsible for verifying all site dimensions before
commencing work.
All dimensions are in millimeters unless noted otherwise
This drawing has been produced electronically and may have been
photo reduced or enlarged when printed or copied. Dimensions on this
drawing shall not be scaled. Work only to figured dimensions. Any
dimensional discrepancies, errors or omissions are to be reported to the
architect immediately.
The contractor is responsible for the stability of the building whilst the
works are in progress.

130407B

35 Swinton Road
London
NW1X 9NT

Proposed section
through

Project number 130407B

Date 29/08/13

Drawn by A Moore

Checked by CCC

130407B/SEC2/rev3

Scale 1:25 @ A3

Revision 2 - 29-09-2013 - Amended to
planners comments

Revision 3 - 20-01-2014 - Amended to
conservation design officers comments

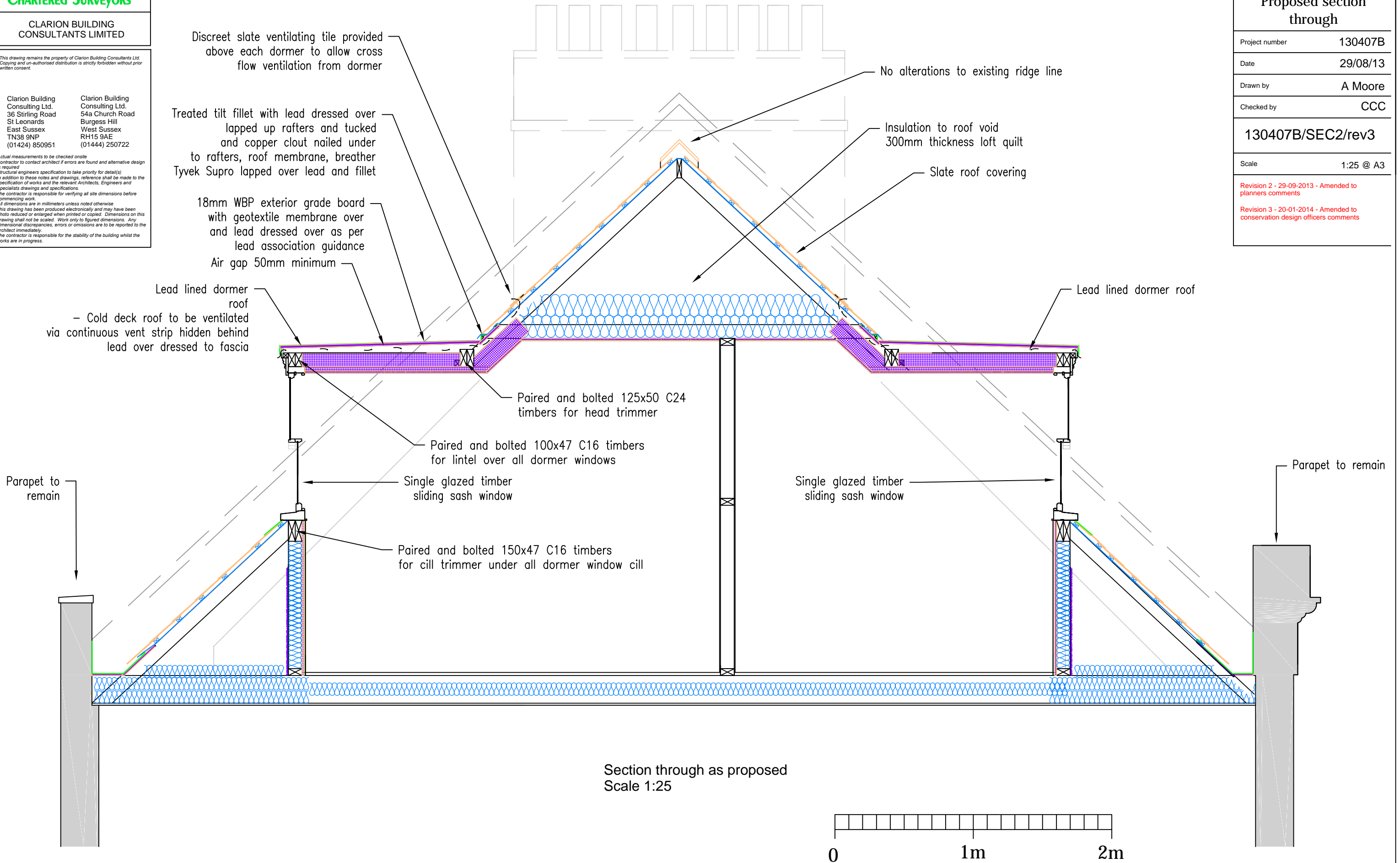

Section through as proposed
Scale 1:25

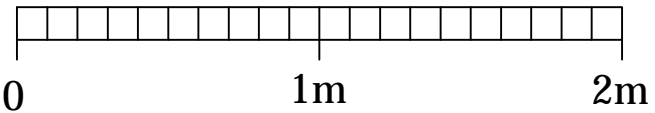

Scale bar 1:25