

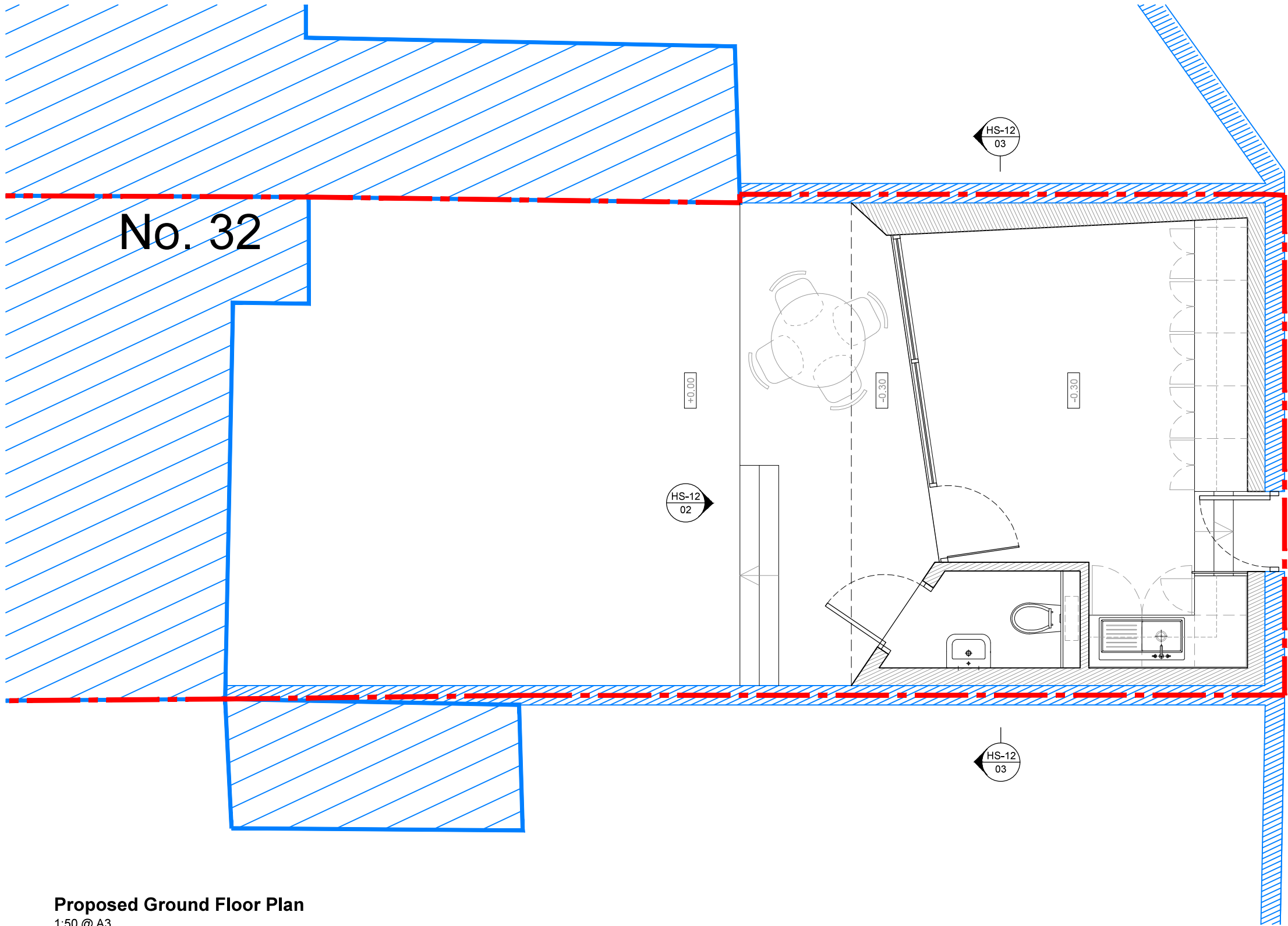

KEY

- Existing Building
- Proposed Building



Proposed Ground Floor Plan
1:50 @ A3

A ROOF AMENDED FROM PITCHED TO FLAT, PROPOSED BUILDING RECESSED 0.3M INTO GROUND 24.01.14 SR

REVISION DATE/DRAWN



PROJECT 32 HARMOOD STREET
CAMDEN
DRAWING TITLE PROPOSED GROUND
FLOOR PLAN

DATE JAN 2013 SCALE 1:50 @ A3
DRAWN SR CHECK MG
STATUS PLANNING
JOB NUMBER AL 2116
DRAWING NUMBER HS-11 REV A