

- NOTES
- 1. This drawing to be read in conjunction with all relevant Architects, Engineers and specialists drawings, details and specifications.
 - 2. Do not scale from this drawing
 - 3. All dimensions in millimeters
 - 4. Scale 1:100 unless noted otherwise

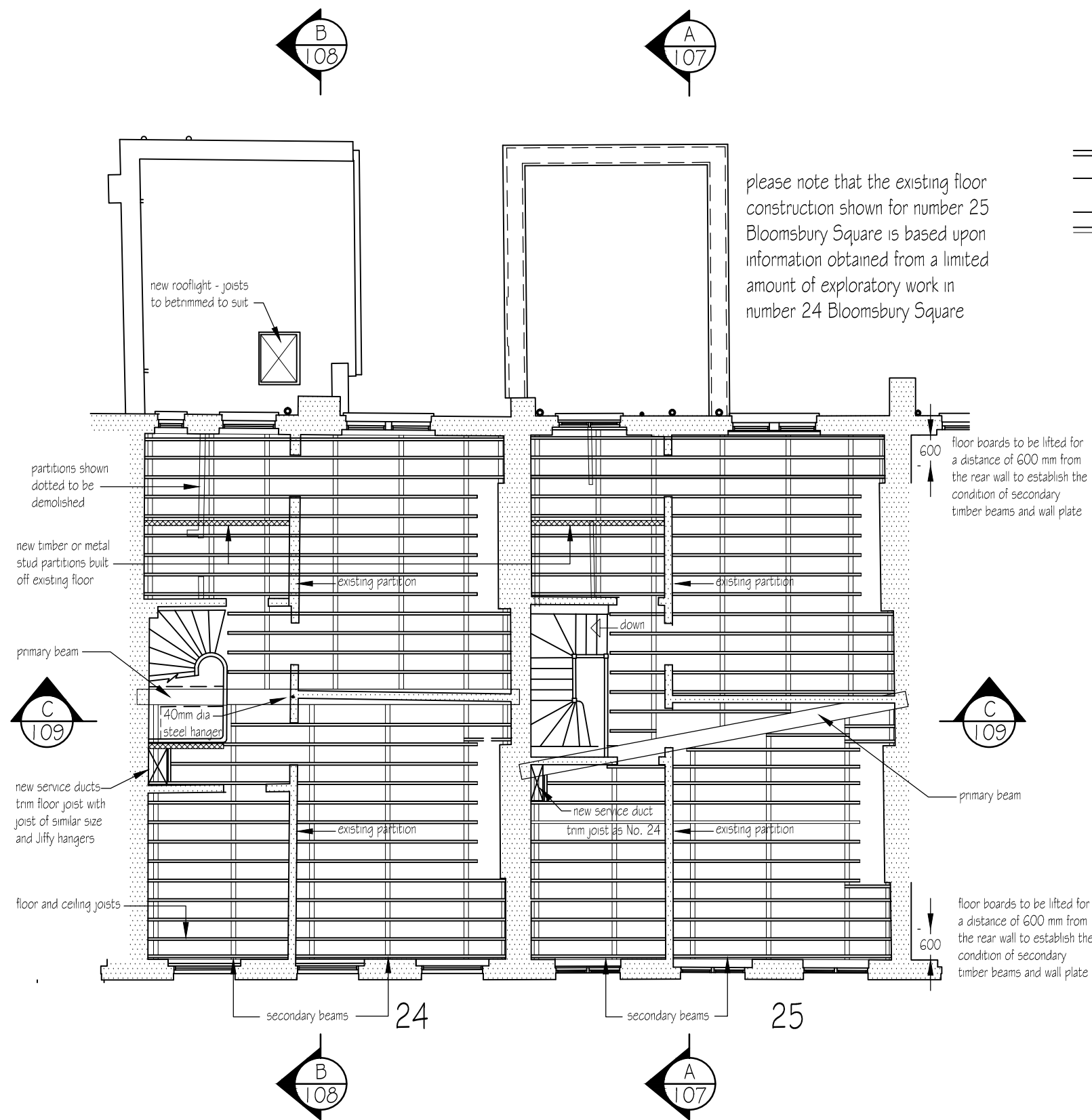

please note that the existing floor construction shown for number 25 Bloomsbury Square is based upon information obtained from a limited amount of exploratory work in number 24 Bloomsbury Square

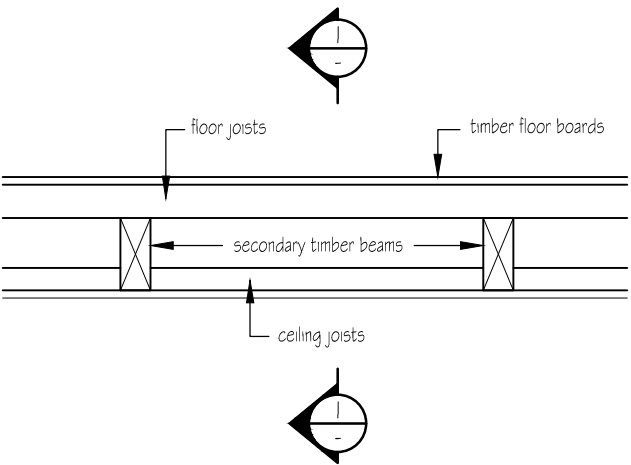

Detail of floor construction

Scale 1 - 25 @ A3

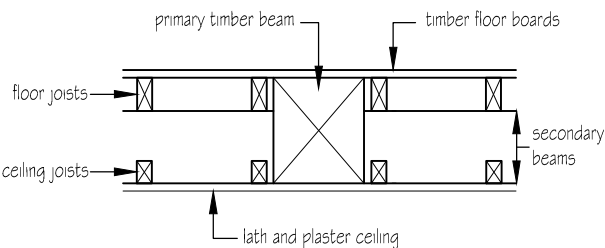

Section I

Scale 1 - 25 @ A3

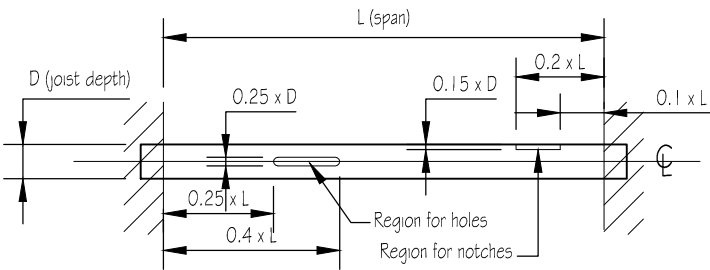

Joist Drilling and Notching Detail

Scale 1 - 50 @ A3

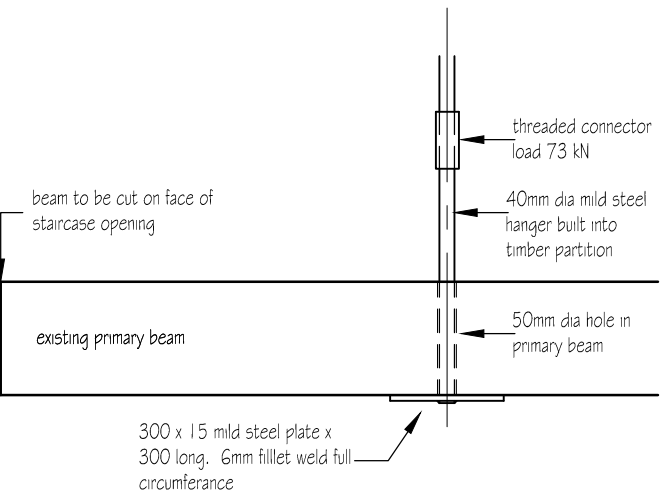

Hanger detail

Scale 1 - 20 @ A3

G	3-02-14	steel hanger added
Rev	Date	

R W A London
Civil & Structural Engineers

telephone : 020 7593 0088
e-mail : engineers@rwalondon.co.uk

Issued for TENDER

24 / 25 Bloomsbury Square

Third floor - proposed