

1 G.49 LOBBY - EXISTING GA PLAN  
6410 1:50 @ A1

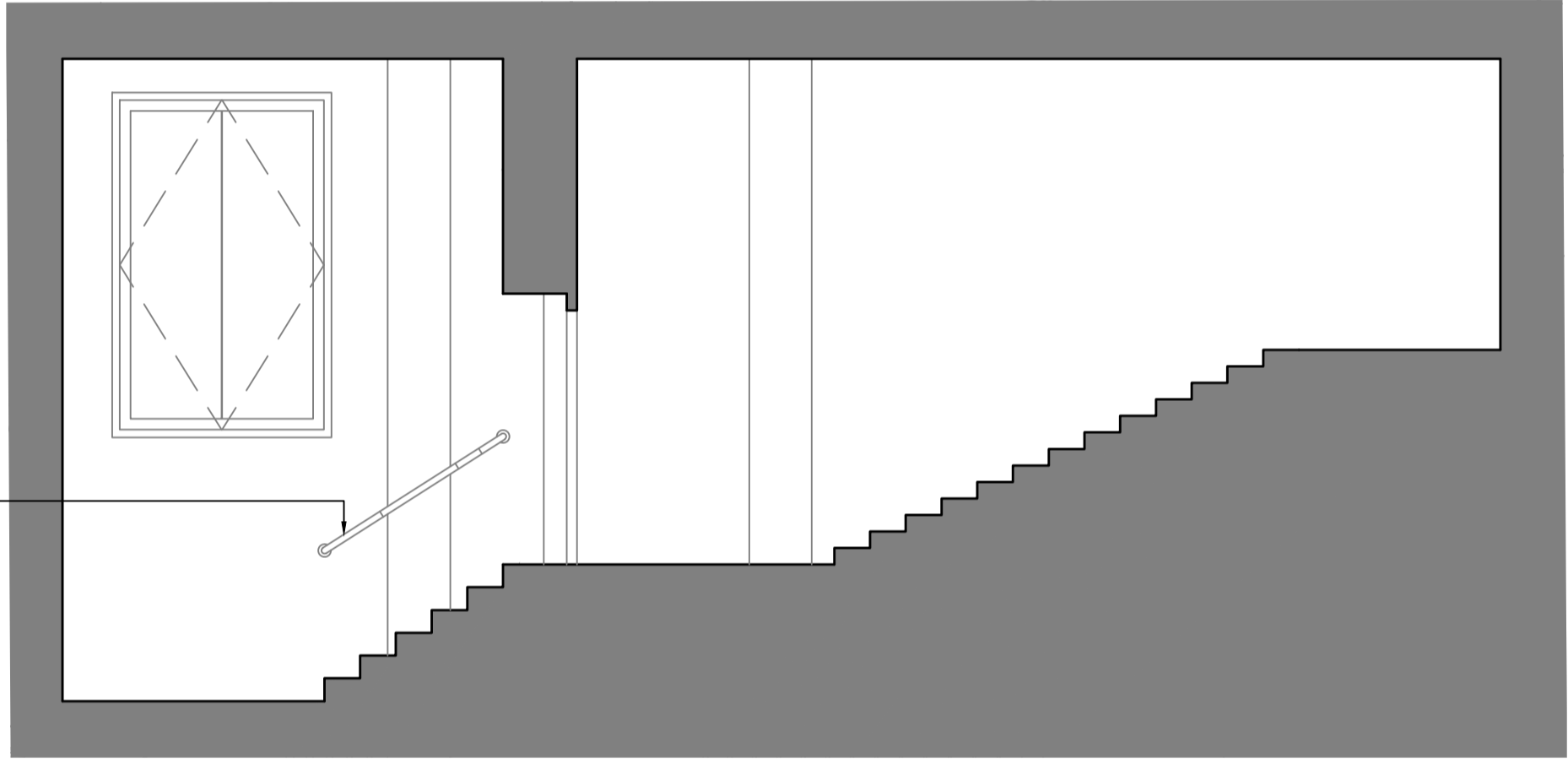

3 G.45 LOBBY - EXISTING ELEVATION  
6410 1:50 @ A1

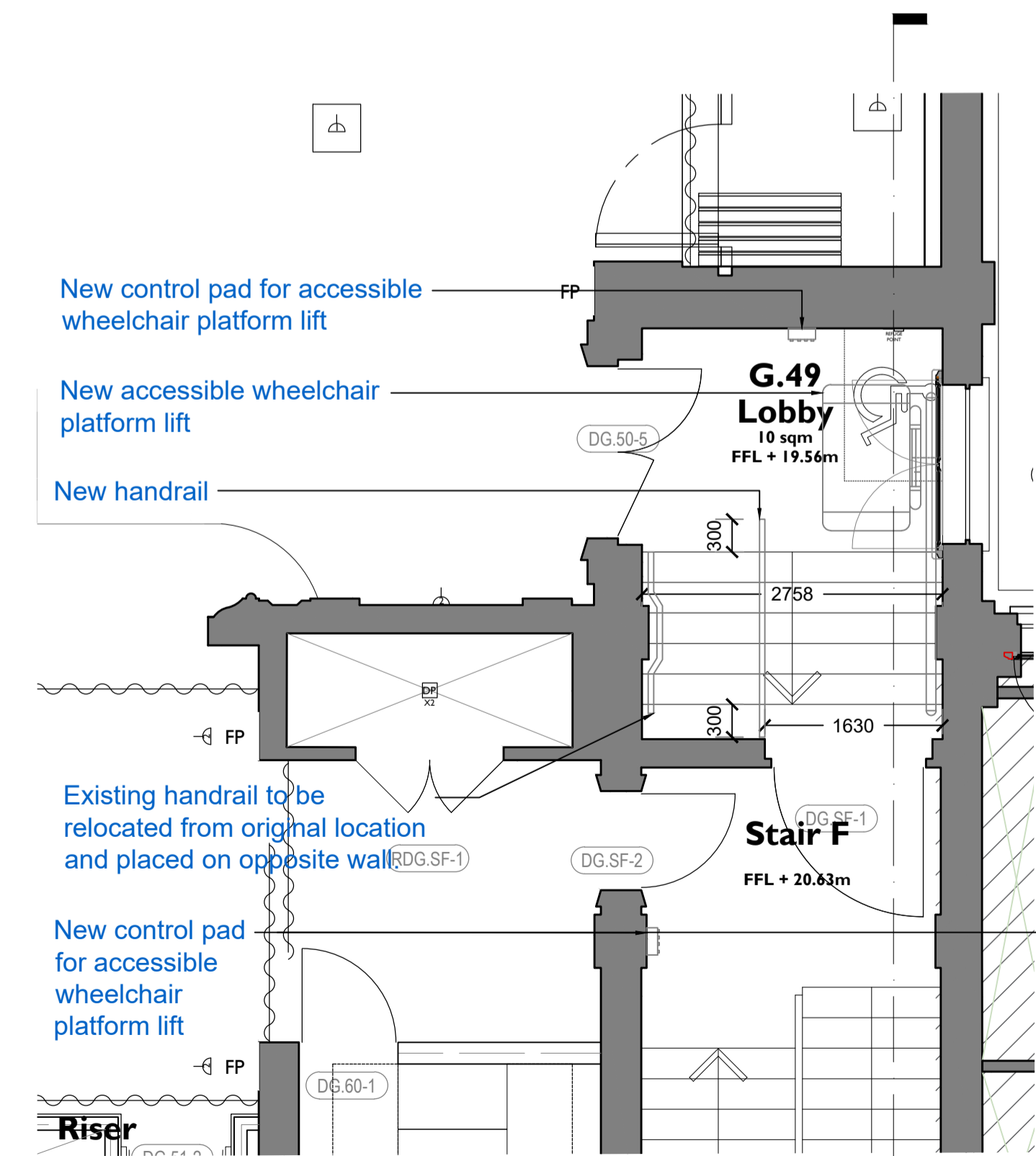

2 G.45 LOBBY - PROPOSED GA PLAN  
6410 1:50 @ A1

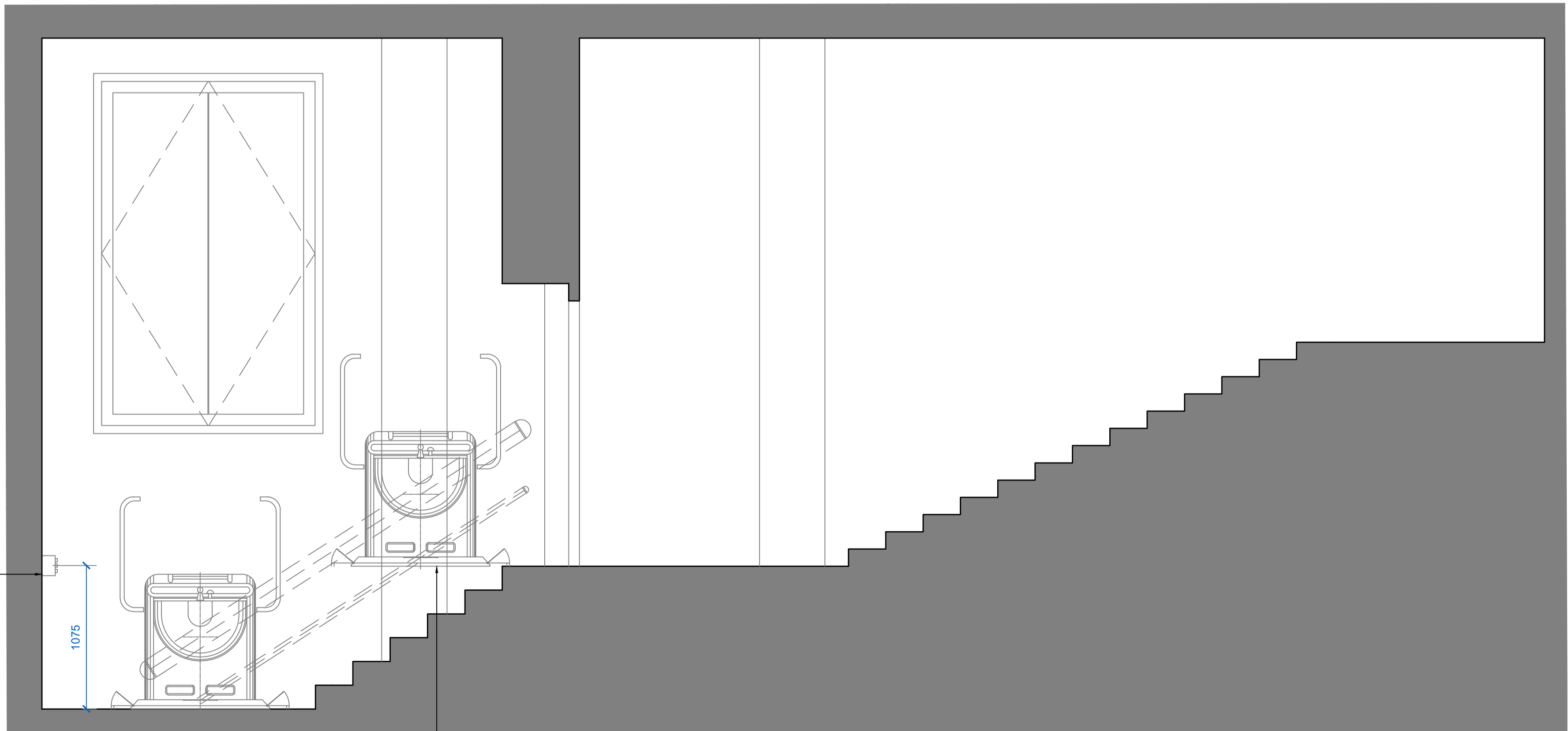

4 G.45 LOBBY - PROPOSED ELEVATION  
6410 1:25 @ A1

New accessible  
wheelchair platform lift

#### Notes:

Drawings are based on survey data and may not accurately represent what is physically present.

Do not scale from this drawing. All dimensions are to be verified on site before proceeding with the work.

All dimensions are in millimetres unless noted otherwise.

Purcell shall be notified in writing of any discrepancies.

#### Key Plan

not to scale

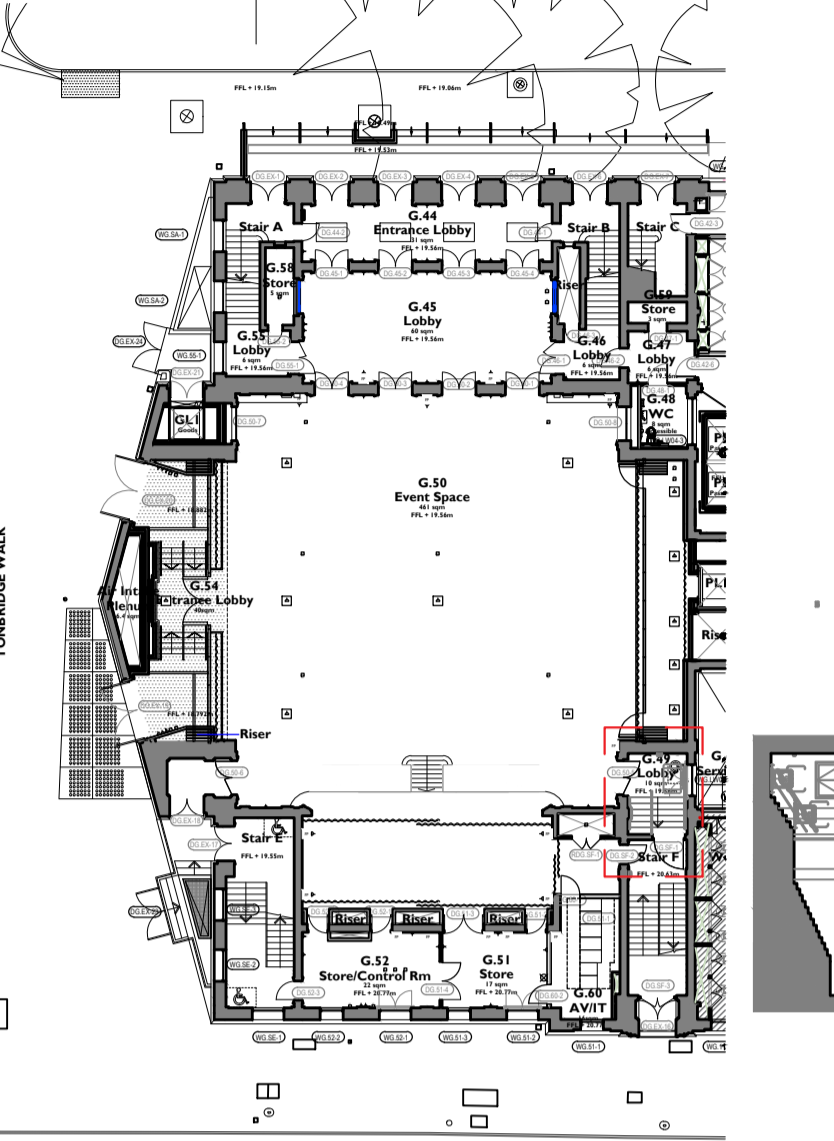

0 1m 2m 3m 4m 5m

Scale 1:50

P02	16.04.2025	DZ	JE	For LBC
P01	12.12.24	DZ	JE	For LBC
REV	DATE	BY	CHK	DESCRIPTION

#### CLIENT

**Il Bottaccio**

#### PROJECT

**Camden Town Hall Tenant Fitout**

#### JOB NUMBER

**242931**

#### TITLE

**G.49 LOBBY - Addition of new accessible wheelchair platform lift**

#### SIZE

**A1L**

**1:25 / 1:50**

#### REV

**P01 S4 - For Review and Authorisation**

#### DRAWING NUMBER

**242931-PUR-01-GF-DR-A-6410**

PURCELL® IS THE REGISTERED TRADE NAME FOR PURCELL ARCHITECTURE LTD AND ALL SUBSIDIARY COMPANIES AND IS REGISTERED IN THE UNITED KINGDOM, EUROPEAN UNION, HONG KONG, CHINA AND AUSTRALIA. © PURCELL 2025. www.purcell.com