

KEYS

- EXISTING WALLS
- NEW WALLS

KEY FOR PLANS & ELEVATIONS

- NEW BRICK WALL EXTENSION TO MATCH EXISTING BRICKS
- PAINTED TIMBER PANELLING MATCHING TO EXISTING PANELLING
- RENDERED BANDING TO MATCH EXISTING
- NEW PVC FRAMED WINDOWS MATCH TO MATCH EXISTING
- NEW PVC FRAMED SLIDING DOORS TO MATCH EXISTING - GLASS BALUSTRADE INTERNALLY

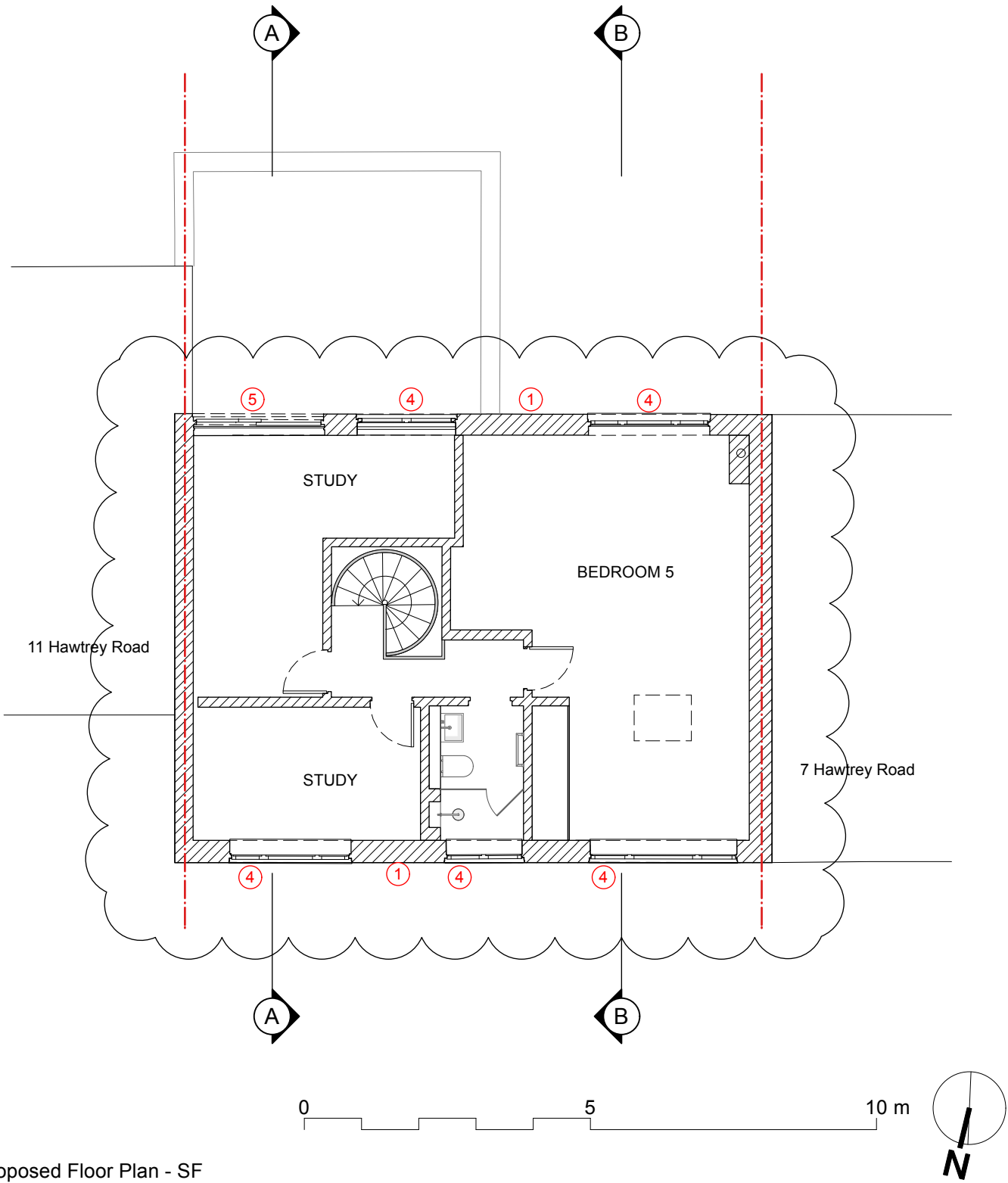

1 Proposed Floor Plan - SF
Scale: 1:100

REVISION	A	22/05/2025	Window and doors updated
DATE	28 April 2025	SCALE @ A3	1:100
PROJECT	9 Hawtrey Road		
CLIENT	Bruce Rigal		
DRAWING TITLE	Proposed Floor Plan - SF		
DRAWING No.	TRS145_PA_102_GA		
ISSUE	PRIOR APPROVAL		

TR STUDIO
Architecture | Interiors

The Blackfriars Room
St Bride Foundation
14 Bride Lane | London EC4Y 8EQ
T: +44 (0)203 567 0569
E: office@trstudio.co.uk
W: www.trstudio.co.uk

This drawing must not be scaled from nor should it be used for the calculation of areas for the purposes of valuation. All dimensions are indicative and must be verified on site prior to the commencement of any works. This drawing must be read in conjunction with all necessary information from all other design consultants and contractors. All works must comply with the relevant British standards and building control requirements. Drawing errors to be reported to the Architect.