

**Spray head to be installed in
boxing/trunking or section of
shelving built out flush to
look natural**

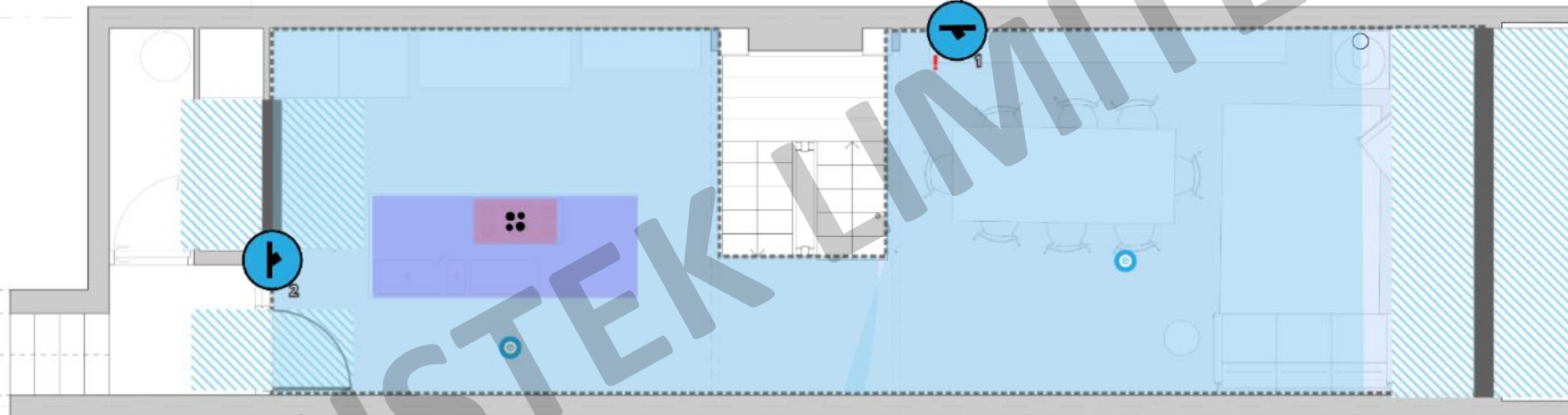

DETECTOR

Heat/Smoke Activated



AUTOMIST PUMP

(H-400mm x D-300mm x W-200mm)



SMARTSCAN SPRAY HEAD

Wall Mounted, 6 meter coverage



CONTROL UNIT

Wall mounted, (usually next to pump)



DOORWAY

Not required for coverage

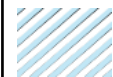

STERILE AREA

Not required for coverage



HEAT SOURCE

Checked for system interference



MIST COVERAGE

Maximum 1sqm per room uncovered

DETECTORS:

Plumis Wireless

BUILDING CONTROL:

TBC

PROJECT MANAGER

Callum 07810 860 602

DECLARATION OF COMPLIANCE:

Automist is compliant with the building regulations following the guidance of **BS9991:2024** Clause 17 – referring to **BS5306-6** (table 1) using a water mist system compliant with **BS8458:2015**.

BS9991:2024 > BS5306-0:2020 > BS8458:2015

Automist discharge duration is equal to a BS9251 table 2 sprinkler

PROPERTY ADDRESS:

84 South Hill Park,
NW6 2SN

SYSTEM NOTES:

Heads and pump locations tbc

CONTACT NUMBER:

Robert
07815 204 277