

This drawing should be read in conjunction with all drawings prepared as part of the detail design package. Ensure site dimensions are checked prior to manufacture and installation. Ensure all joinery is restrained to structural envelope as necessary. All finishes to be applied as manufacturers instructions.

These drawings are for design intent purposes only. Contractor to develop construction design accordingly.

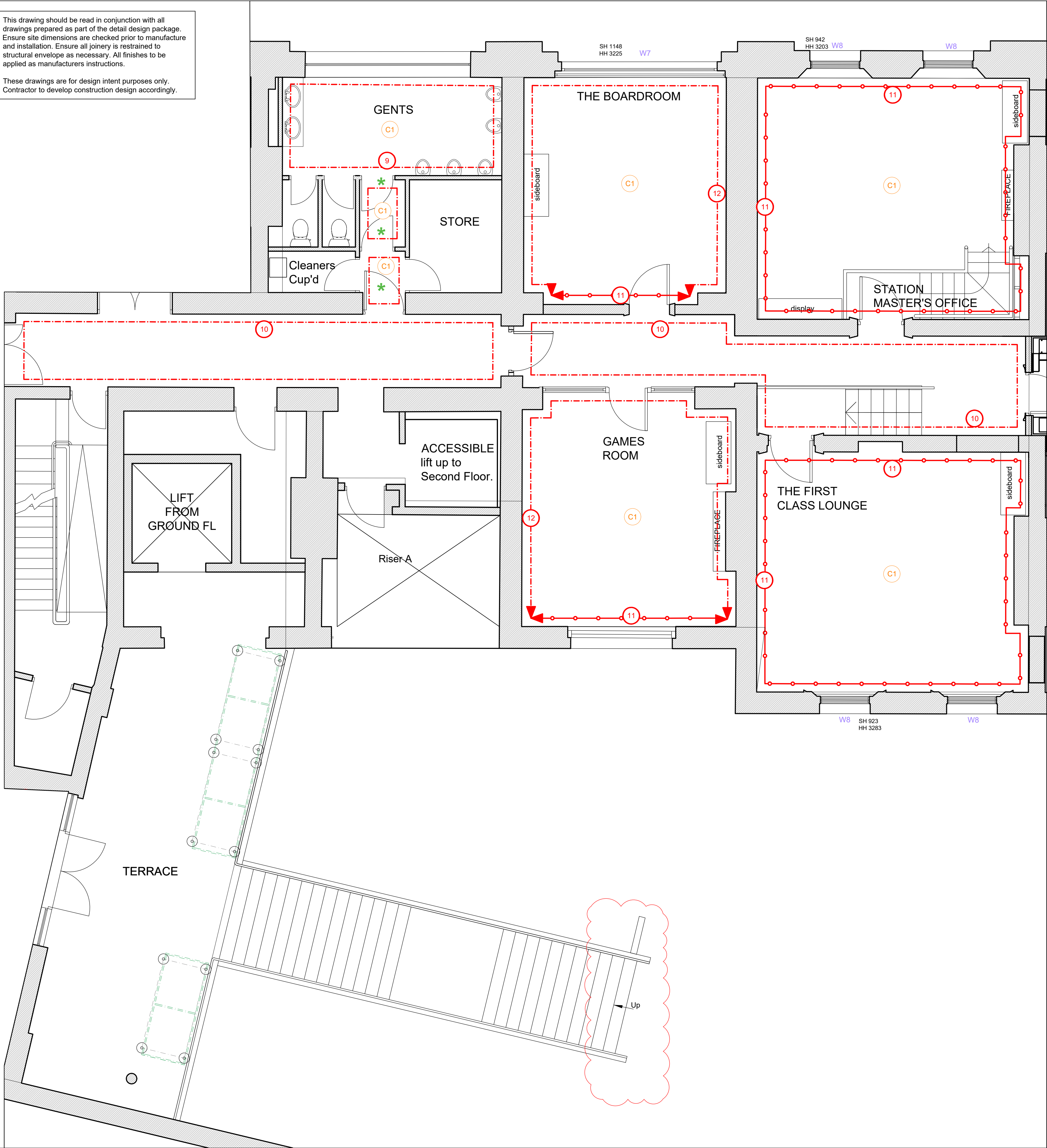

Internal Finishes	
	Denotes plain painted surface
	Denotes existing bead & butt boarding to be decorated
	Denotes new brickslip ref: London stock brick slip to match external face of building. To approved sample by designer. Clear matt sealant - brush apply 1 part PVA to 5 parts water or 1 part turps (or white spirit) to 1 part raw linseed oil.
	Denotes new wallcovering

NOTES:
All finishes to be installed in accordance with the manufacturer's recommendations

WINDOWS INTERNALLY -
Painted to match F&B Brinjal

SKIRTINGS -
Painted to match wall colour

ARCHITRAVES -
Painted to match wall colour

DOORS -
Previously painted doors to be decorated to match wall colour TBC
Refer to individual toilet finishes for cubicle doors.

* Doors to be stripped, stained & polished

Ceiling Finishes		indicates ceilings to be decorated - colours as noted
C1	Dulux Heritage Quartz Grey	
C2	Existing ceiling decoration retained	

NOTES:
All finishes to be installed in accordance with the manufacturer's recommendations

WINDOW SOFT FURNISHING KEY	
W1	Refer to separate schedule for more details

- DECORATION GENERAL NOTES:**
- All previously painted woodwork to be prepared & made good ready to receive new decoration in 1No. undercoat, min. 2No. coats satinwood unless specified otherwise.
 - All new woodwork identified for painting to be prepared ready to receive new decoration in 1No. coat primer, 1No. undercoat, min. 2No. coats satinwood unless specified otherwise.
 - All new woodwork identified for lacquer finish to be prepared ready to receive a min. 2No. coats satin lacquer finish to approved sample (can be pre-finished off site).
 - All existing plasterboard & skim surfaces to be made good & thoroughly prepared to give a smooth finish & be ready to receive new decoration in 1No. mist coat & min. 2No. top coats diamond matt emulsion unless otherwise stated.
 - All new plasterboard & skim surfaces to have a smooth finish & be prepared ready to receive new decoration in 2No. mist coat & min. 2No. top coats diamond matt emulsion unless otherwise stated.
 - Contractor to provide sample patch test of colours on site for approval.

Wall Decorations	
Walls - Dulux Diamond Matt Ceilings - Dulux Diamond Matt Internal joinery - eggshell or stained as detailed Allow for 2no base coats and 1no top coat to all paint finishes.	
Decoration references	
1	Specialist paint finish by Blackheart Creative. Artistic layers of water based paint to create distressed aged effect. Sealed with water based matt finish varnish.
2	Dulux Heritage Setting Stone
3	Dulux Heritage DH Slate
4	Dulux Trade 70BG 07/086 (OJS blue)
5	Dulux Heritage Masters Gold
6	Dulux Trade to match Farrow & Ball Brinjal
7	Full height wallcovering ref: Tektura Canyon 47824
8	Ladies: Existing tiled wall to be retained. Above to be decorated Dulux Heritage Quartz Grey. Cubicle Doors & partitions to be decorated Satinwood Dulux to match F&B Brinjal
9	Gents: Existing tiled wall to be retained. Above to be decorated Dulux Heritage Quartz Grey. Cubicle Doors & partitions to be decorated Satinwood Dulux Trade 70YY 09/175 (olive)
10	Dulux Heritage Sage Green
11	Full height wallcovering ref: Tektura Canyon 47825 (fire rating EuroClass C)
12	Dulux Trade 78GG 19/078 (dark teal)
13	Full height wallcovering ref: Newmor Zenith 15.1404 (Fire rating EuroClass B)
14	Dulux Heritage Mallard Green
15	Dulux Heritage Biscuit Beige
16	Dulux Heritage Stone Green

NOTES:
All finishes to be installed in accordance with the manufacturer's recommendations

newman|gauge

E.design@newmangauge.com T. 0121 212 9800
47A George St. Birmingham B3 1QA
newmangauge.com



Project
**THE PARCEL YARD
KINGS CROSS STN**
Drawing Title
**FIRST FLOOR 2 OF 2
WALL & CEILING FINISHES**

Project Type
LITED BUILDING APP

Date	Scale	Drawn By
MAR'25	1:50@A1	SMP
Project No.	Drawing No.	Revision
3185	0045	A

This drawing is the property of NEWMAN GAUGE DESIGN ASSOCIATES. Copyright is reserved by them and the drawing is issued on the condition that it is not copied either wholly or in part without the prior consent in writing of Newman Gauge Design Associates. All dimensions are to be checked on site prior to the commencement of any work or shop drawings. This drawing is to be read in conjunction with other drawings and specifications where existing.

