

Note:  
1.The design and drawing remains the property of Andrew Dobson Architects Ltd.  
2.The client is licensed to use the design and drawing for this project only. This licence is non-transferable. The design and drawings shall not be reproduced, up-loaded to the internet or traced without the permission of Andrew Dobson Architects Ltd.  
3. This drawing is prepared solely for design and planning submission purposes. It is not intended or suitable for either Building Regulations or Construction purposes and should not be used for such.  
© andrew dobson architects



Andrew Dobson Architects

Studio 316, Metal Box Factory,  
30 Great Guildford Street London SE1 0HS  
Phone: 020 7736 4390  
info@andrewdobsonarchitects.co.uk  
www.andrewdobsonarchitects.co.uk

30 Denning Road, London, NW3 ISU

First Floor Plan - Proposed Fire Strategy

Planning	02/05/25	
1:100@A3	AB	AD

755-PI.122-A

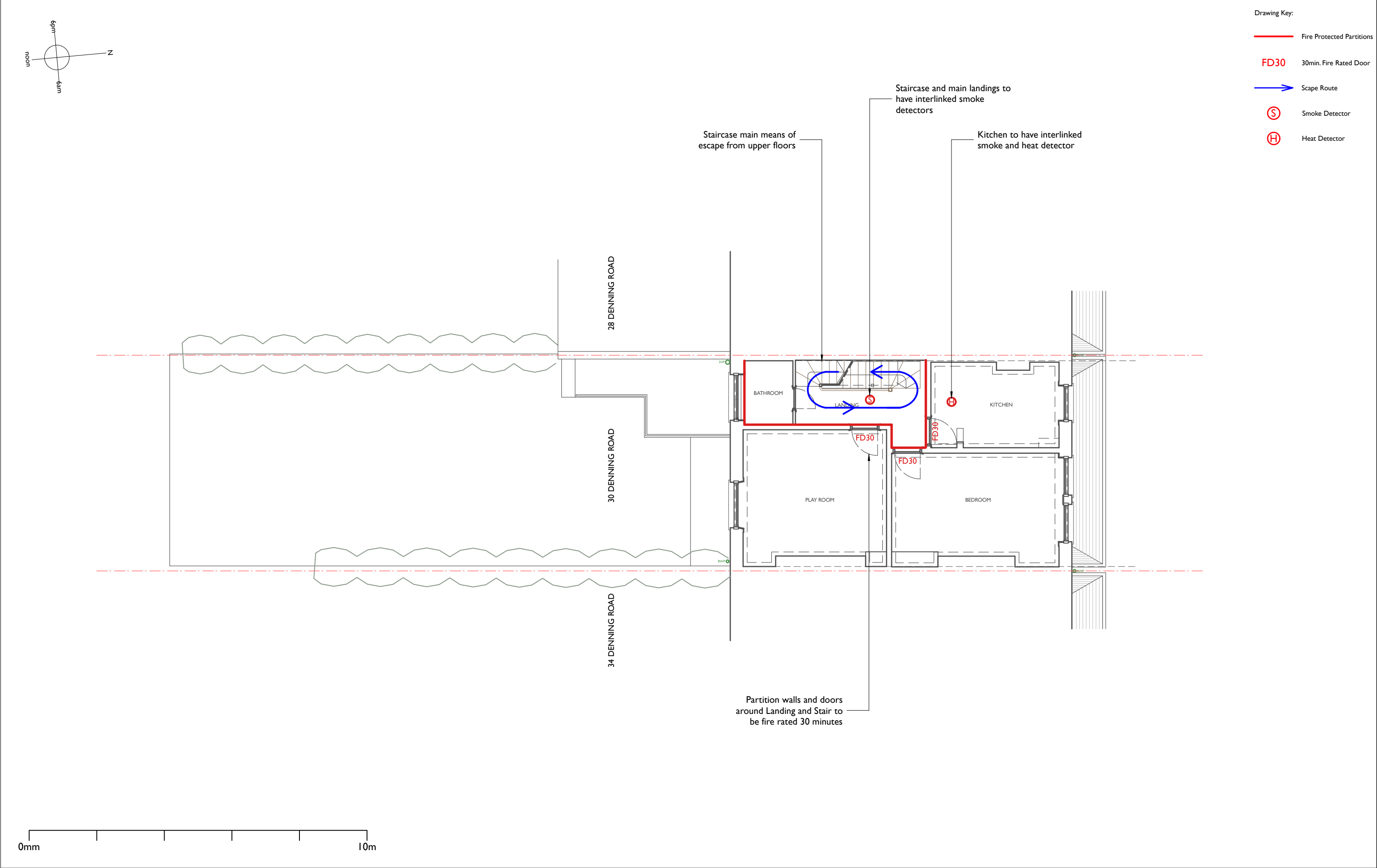

Note:  
1. The design and drawing remains the property of Andrew Dobson Architects Ltd.  
2. The client is licensed to use the design and drawing for this project only. This licence is non-transferable. The design and drawings shall not be reproduced, up-loaded to the internet or traced without the permission of Andrew Dobson Architects Ltd.  
3. This drawing is prepared solely for design and planning submission purposes. It is not intended or suitable for either Building Regulations or Construction purposes and should not be used for such.  
© andrew dobson architects



Andrew Dobson Architects

Studio 316, Metal Box Factory,  
30 Great Guildford Street London SE1 0HS  
Phone: 020 7736 4390  
info@andrewdobsonarchitects.co.uk  
www.andrewdobsonarchitects.co.uk

30 Denning Road, London, NW3 ISU

Second Floor Plan - Proposed Fire Strategy

Planning	02/05/25	
1:100@A3	AB	AD

755-PI.123-A

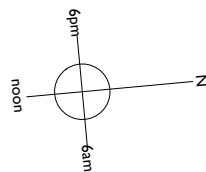

Drawing Key:

— Fire Protected Partitions

**FD30** 30min. Fire Rated Door

→ Scape Route

 Smoke Detector

 Heat Detector

Staircase and main landings to have interlinked smoke detectors

Staircase main means of escape from upper floors

28 DENNING ROAD

30 DENNING ROAD

34 DENNING ROAD

Partition walls and doors  
around Landing and Stair to  
be fire rated 30 minutes

0mm

10m

Note:

1. The design and drawing remains the property of Andrew Dobson Architects Ltd.
2. The client is licensed to use the design and drawing for this project only. This license is non-transferable. The design and drawings shall not be reproduced, up-loaded to the internet or traced without the permission of Andrew Dobson Architects Ltd.
3. This drawing is prepared solely for design and planning submission purposes. It is not intended or suitable for either Building Regulations or Construction purposes and should not be used for such.

© andrew dobson architects



Andrew Dobson Architects

Studio 316, Metal Box Factory,  
30 Great Guildford Street London SE1 0HS  
Phone: 020 7736 4390  
info@andrewdobsonarchitects.co.uk  
www.andrewdobsonarchitects.co.uk

30 Denning Road, London, NW3 1SU

### Third Floor Plan - Proposed Fire Strategy

## Planning

02/05/25

AD

755-PI.124-A