

ANNOTATION KEY :

- ① NEW OPENING IN EXISTING FABRIC.
- ② NEW METAL FRAMED CRITTAL DOORS & WINDOWS;  
GLAZING BARS TO MATCH STYLE OF SASHES.

FINISHES KEY :

- Ⓐ RENDER - COLOUR TBC
- Ⓑ METAL

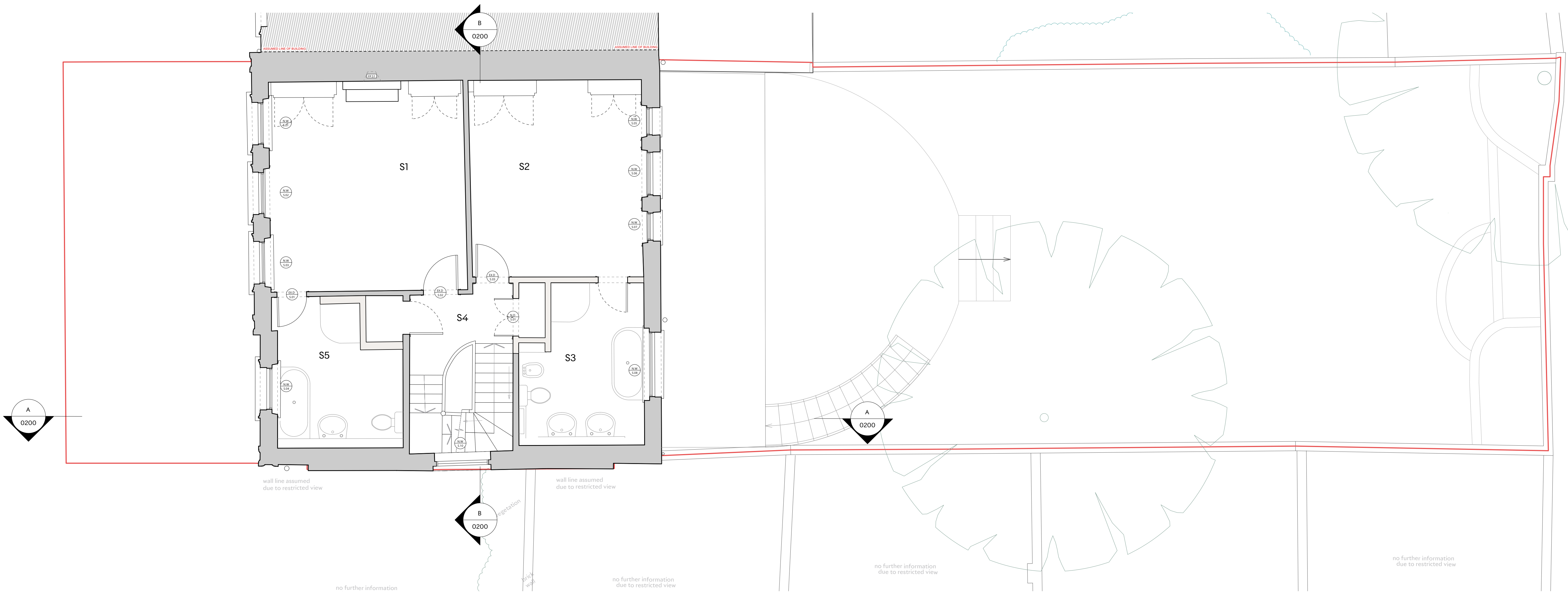

1 Proposed Second Floor Plan - No alterations  
Scale: 1:50



Notes

- Drawings are to be read in conjunction with all relevant Architects, Structural Engineers and other consultants information, drawings & schedules.
  - All works to be carried out in accordance with current Health & Safety regulations, British Standards, Building Regulations and industry standard where appropriate.
  - All components to be based on the design intent drawings and to the dimensions shown. Any further design development to be issued by manufacturer as detailed drawings and finish samples for approval by Designer prior to manufacture and must not infringe any design copyright.
- Do not scale from drawings. All dimensions to be confirmed on site & coordinated with Design Team.
  - Contractor to refer all discrepancies and/or errors to Architect.
  - All fire rating, acoustic rating and any other specialist requirements to be confirmed by appropriate specialist engineer.
  - Tender documentation for costing purposes only. Unless marked as "For Construction" drawings are not to be used for construction.

ANNOTATION KEY :

- EXISTING - ORIGINAL WALLS
- EXISTING - NON ORIGINAL WALLS
- PROPOSED
- ASSUMED SITE BOUNDARY

GENERAL NOTE:

ALL FLOOR LEVELS SHOWN ARE AOD.

P 1 27/05/2025 ISSUED FOR PLANNING

PLANNING

Project

15 Chalcot Square, NW1 8YA

Client

Bridget Smith

Drawing Title

Proposed Second Floor Plan

Scale

1:50

Date Created

09/10/2024

Drawing Number

24031-703

Revision

P1

Date Revised

27/05/2025

Drawn By

OM

Checked By

MD

Do not scale from drawing, all dimensions to be checked on site. Report omissions and discrepancies to the architect immediately.

MICHAELIS  
BOYD .

Michaelis Boyd Associates  
108 Palace Gardens Terrace  
London W8 4RT

+44 (0)20 7221 1237  
hello@michaelisboyd.com  
michaelisboyd.com