

INDICATIVE

Tree Survey Plan Key

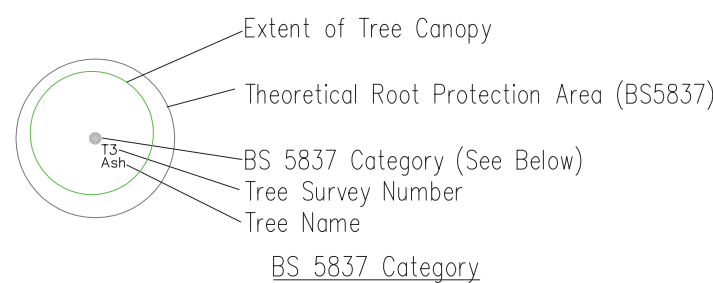

(See Tree Survey for further details)

Category U - Red Stem Disc
Those in such a condition that any existing value would be lost within 10 years and which should in the current context, be removed for reasons of sound arboricultural management.

Category A - Green Stem Disc
Those of high quality and value: - in such a condition as to be able to make a substantial contribution (a minimum of 40 years is suggested).

Category B - Blue Stem Disc
Those of moderate quality and value: - those in such a condition as to make a significant contribution (a minimum of 20 years is suggested)

Category C - Grey Stem Disc
Those of low quality and value: - currently in adequate condition to remain until new planting could be established (a minimum of 10 years is suggested), or young trees with a stem diameter below 150 mm.

187125N

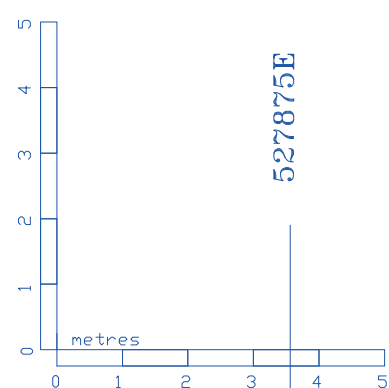

527875E

527900E

527925E

KEY:	
bt	British Telecom
cb	Control Box
cl	Cover Level
ctv	Cable Television
dk	Drop Kerb
el	Electric
ep	Electricity Pole
fh	Fire Hydrant
gv	Gully
gsv	Gas Stop Valve
ht	Height
ic	Inspection Cover
il	Invert Level
lp	Lamp Post
mr	Marker
o/h	Overhead
pb	Post Box
pkg	Prom Crossing
np	Name Plate
rs	Road Sign
sv	Stop Valve
tb	Telephone Box
tl	Traffic Light
tt	Top of Tree
th	Threshold
tw	Top of Wall
utl	Unable to Lift
vp	Vent pipe
wn	Water Meter
wsv	Water Stop Valve

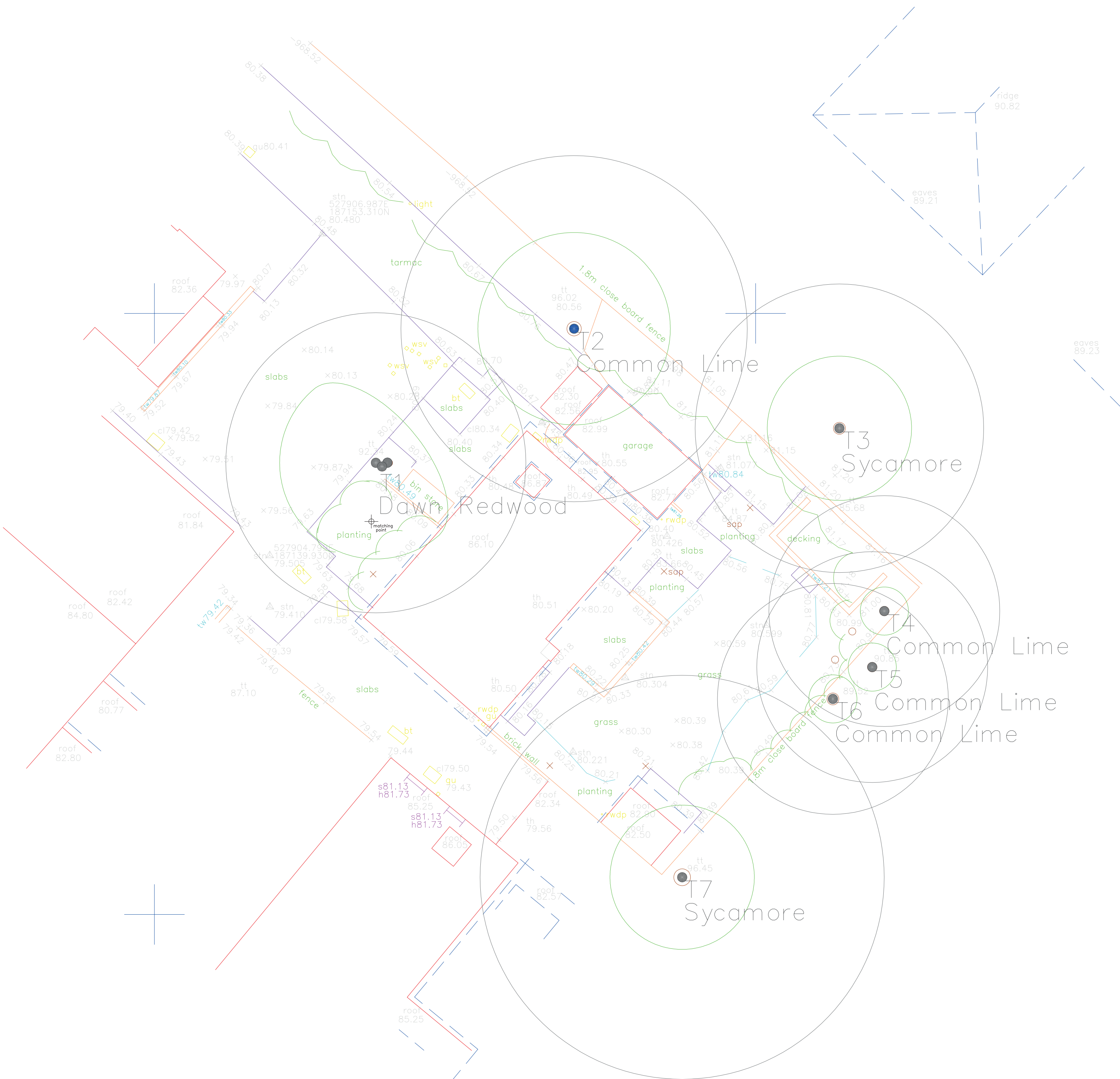

NOTES:
LEVELS RELATE TO D.S. DATUM
TREE SPECIES SHOULD BE VERIFIED WHERE OF CRITICAL IMPORTANCE
THE ARCHITECT SHOULD SATISFY THEMSELVES THAT ALL TREES LIKELY TO AFFECT HIS DESIGN HAVE BEEN SHOWN
INTER CONNECTION OF MANHOLES SHOULD BE VERIFIED WHERE OF CRITICAL IMPORTANCE USING CCTV
PIPE SIZES & INVERTS DETERMINED WITHOUT ENTRY INTO MANHOLE
ALL DIMENSIONS & LEVELS SHOWN IN METRES
ON SITE DIMENSION ACCURACY IS TAKEN RELATIVE TO THE PRINTED SCALE AND SHOULD BE CHECKED ON SITE WHERE OF CRITICAL IMPORTANCE

P. STUBBINGTON LAND SURVEYS LTD	
THE MEAD DURLEY BROOK ROAD DURLEY SOUTHAMPTON HAMPSHIRE SO32 2AR TEL : 023 8060 1876 MOBILE : 07973 348165 EMAIL : PAUL@PSTLANDSURVEYS.COM	
CLIENT:-	MR D TAYLOR
CONTRACT:-	5 THE HEXAGON FITZROY PARK LONDON
TITLE:-	TOPOGGRAPHIC SURVEY
SCALE:-	1:100 @A1
DRAWING NO.	11456/O1
DATE:-	OCTOBER 2024
SURVEYOR:-	RO/SD