

- ① Metal mesh cage housing the ASHP - Black RAL 9005
- ② Tree to be remove - see arboriculture report
- ③ Patio and brick privacy screen are to be removed
- ④ Retractable awning on a metal goal post frame  
7m wide x 4m projection - Black RAL 9005
- ⑤ 1.8m Jasmine green screen on tubular steel framing  
behind existing railings (railings to be redecorated)
- ⑥ Oak railway sleeper retaining wall behind green screen
- ⑦ Permeable rubber mulch safety surface - brown colour
- ⑧ 1m high Metal railings with vertical bars - Black RAL 9005
- ⑨ 2.4m high T&G timber gate and screen to match existing  
garden fencing - black colour
- ⑩ Metal platform with steps and handrails - Black RAL 9005  
finished with brown colour rubber crumb surface.
- ⑪ Bark mulch    ⑫ Teepee    ⑬ Flower bed
- ⑭ Fruit tree    ⑮ Permeable wet pour safety surface
- ⑯ Bird box / bat box / invertebrate house
- ⑰ Tree boxed-in and root protection fencing during the works

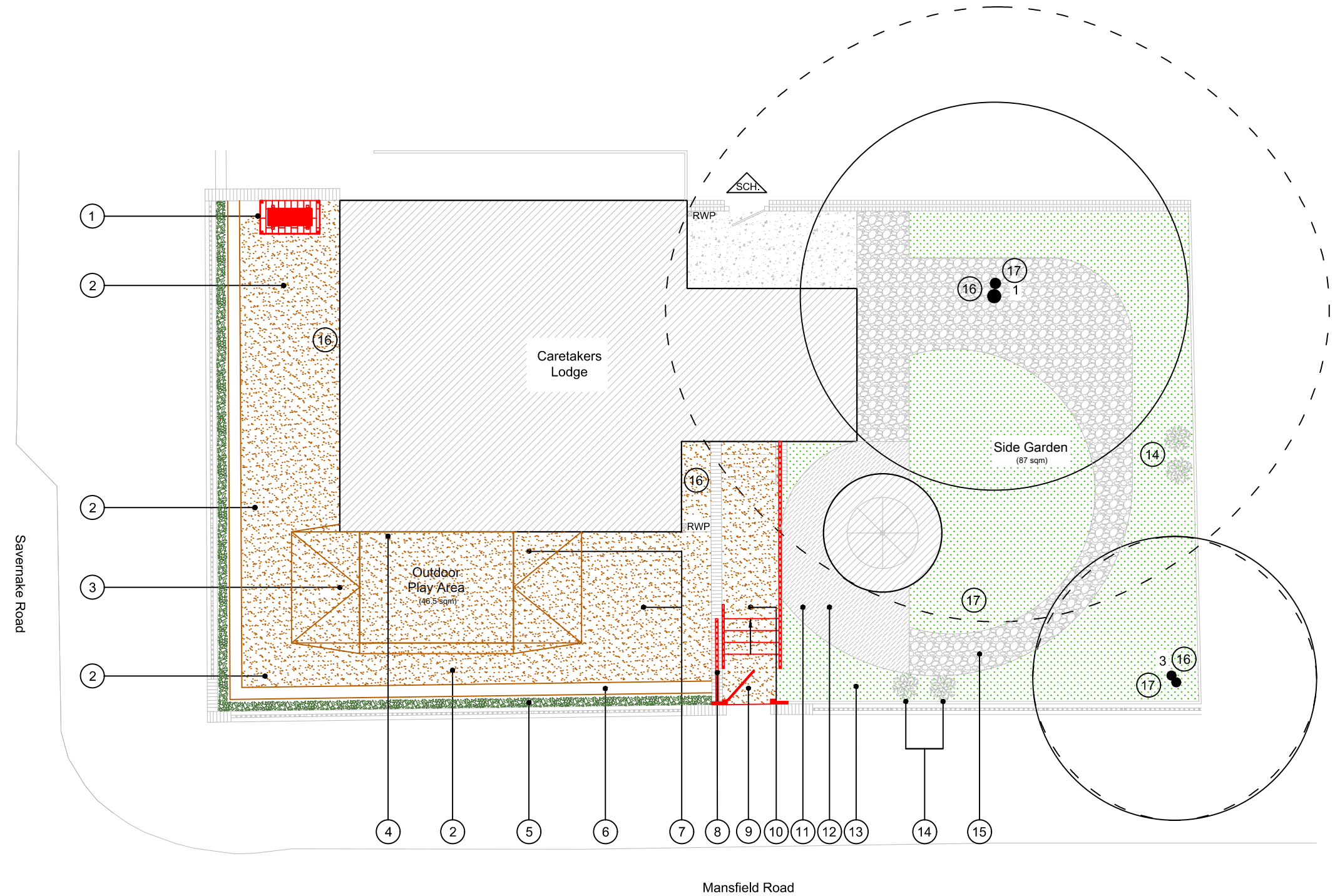

1:100



Address	SCHOOLKEEPER'S HOUSE (GOSPEL OAK PRIMARY SCHOOL) MANSFIELD ROAD, LONDON, NW3 2JB
Project	CONVERSION OF THE SCHOOLKEEPER'S HOUSE INTO A SENSORY SPACE FOR PUPILS WITH SPECIAL EDUCATIONAL NEEDS & DISABILITIES
Drawing	PROPOSED LANDSCAPING
No	08
Rev	1:50/BA3
Date	19.5.25
By	David Davies, Building Surveyor - Property Management