

[01] EXISTING VERTICAL WINDOW SECTION (TYPICAL)

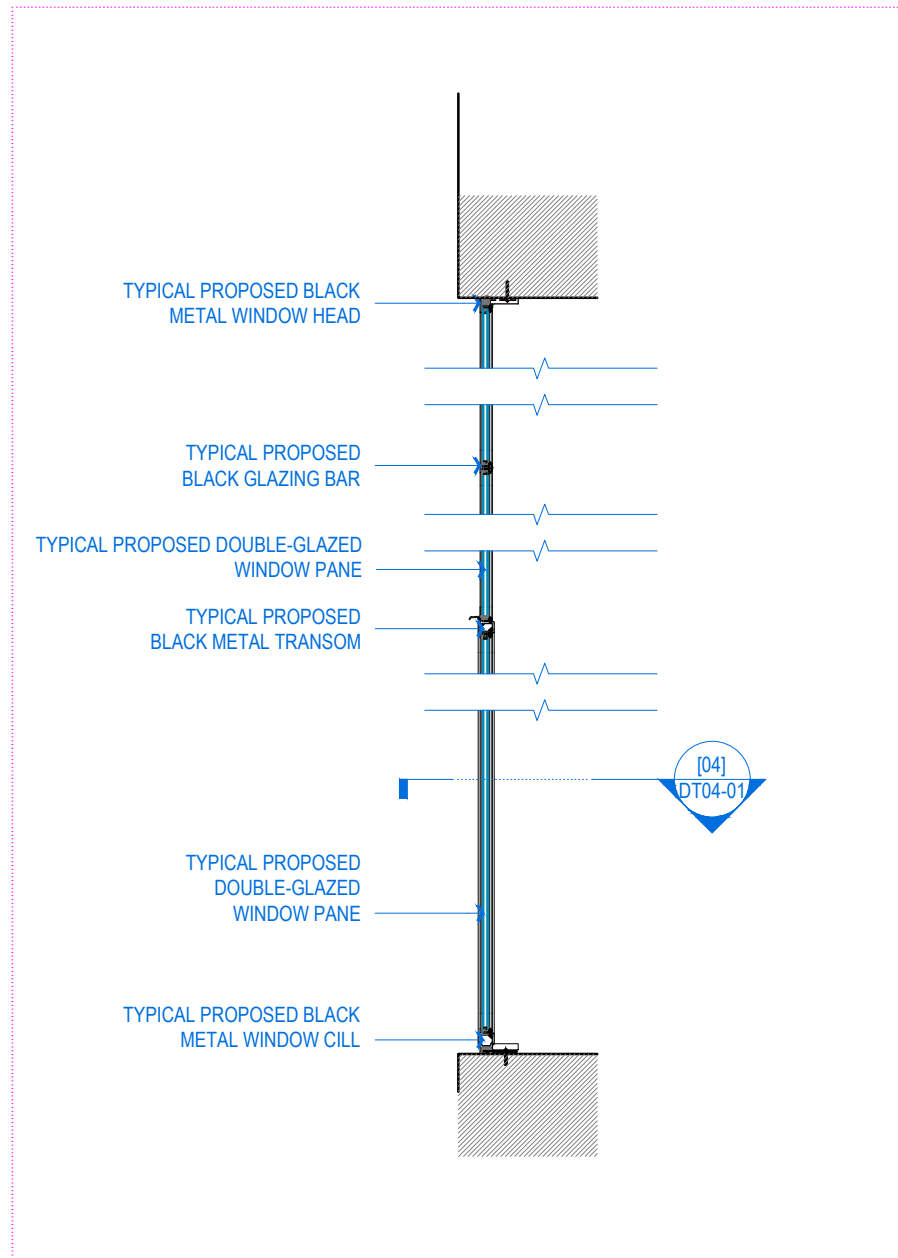

[02] PROPOSED VERTICAL WINDOW SECTION (TYPICAL)

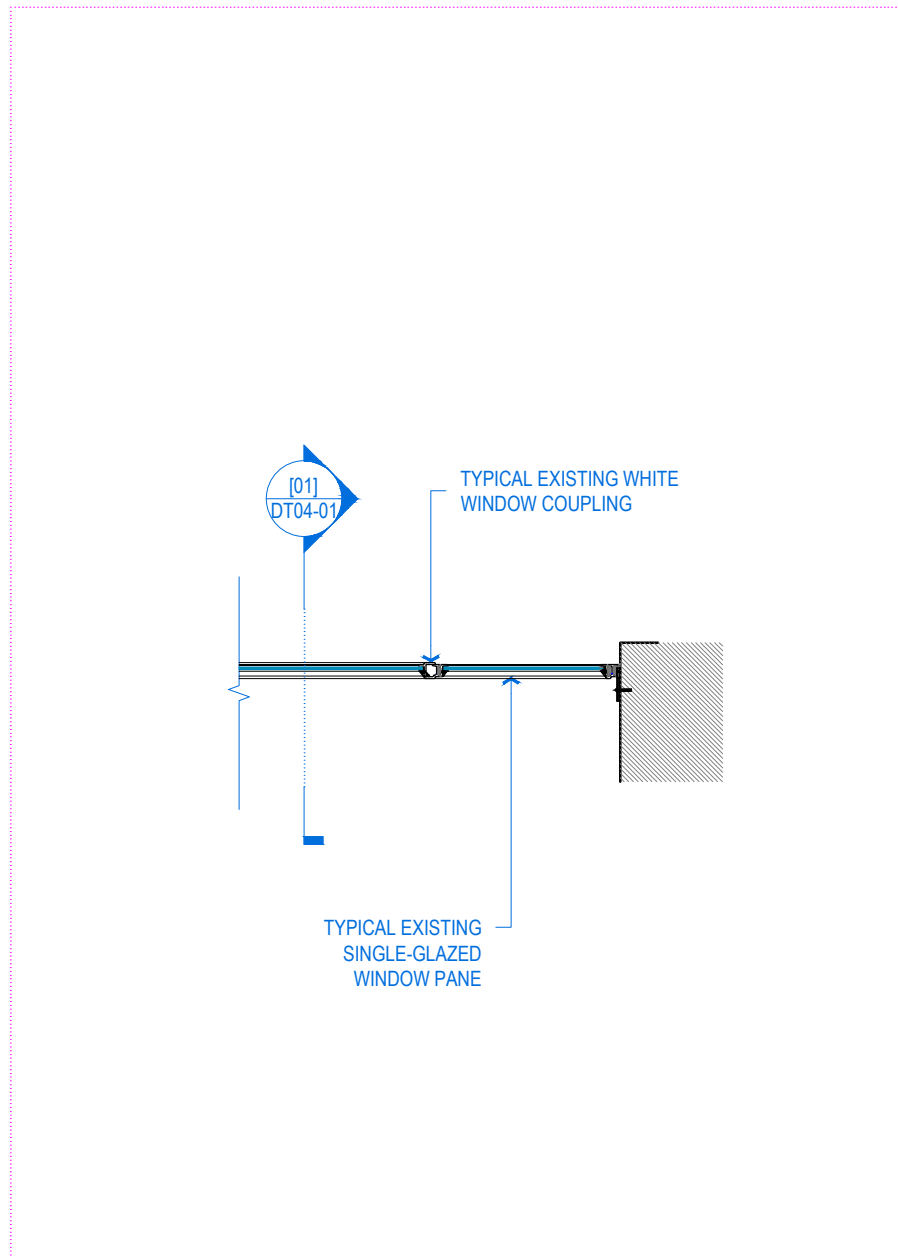

[03] EXISTING HORIZONTAL WINDOW SECTION (TYPICAL)

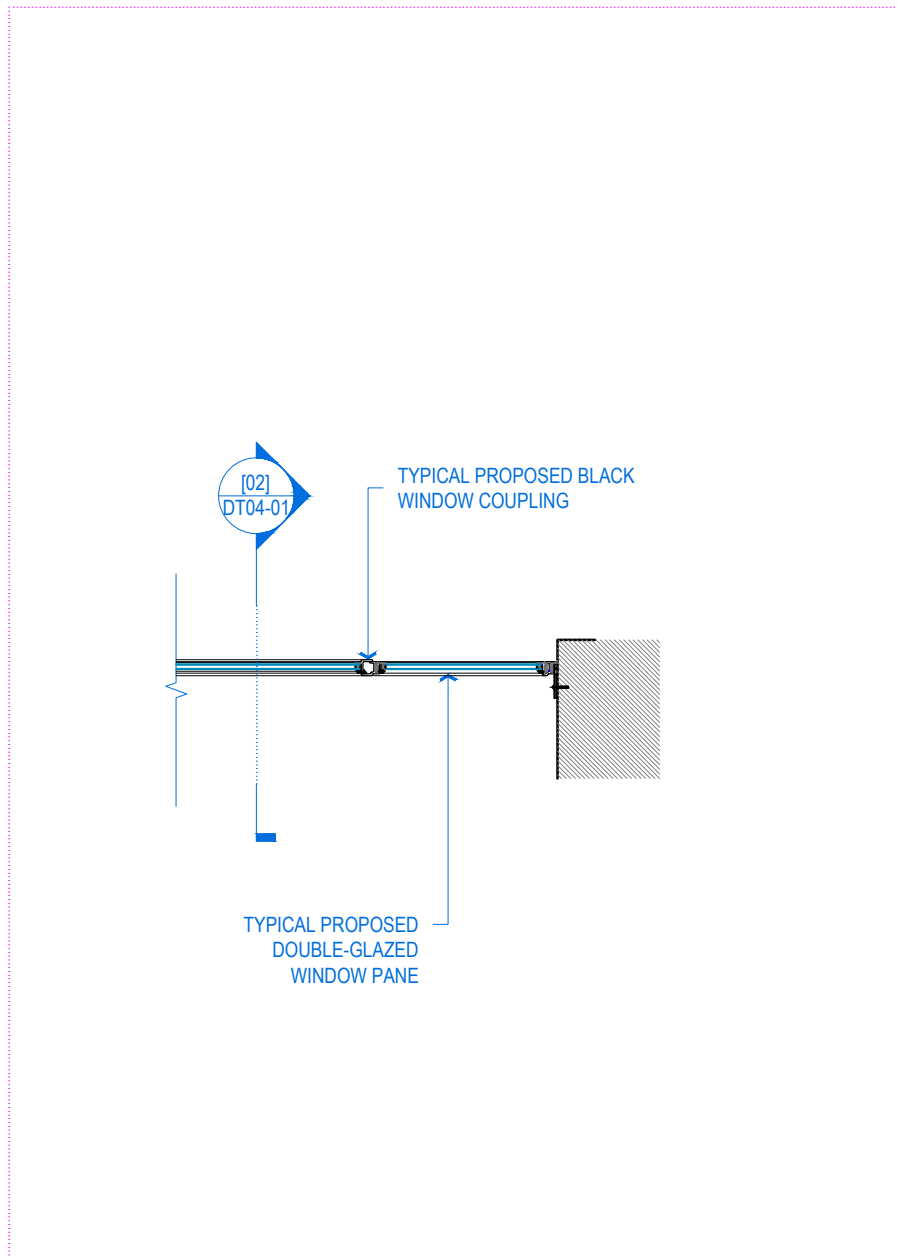

[04] PROPOSED HORIZONTAL WINDOW SECTION (TYPICAL)

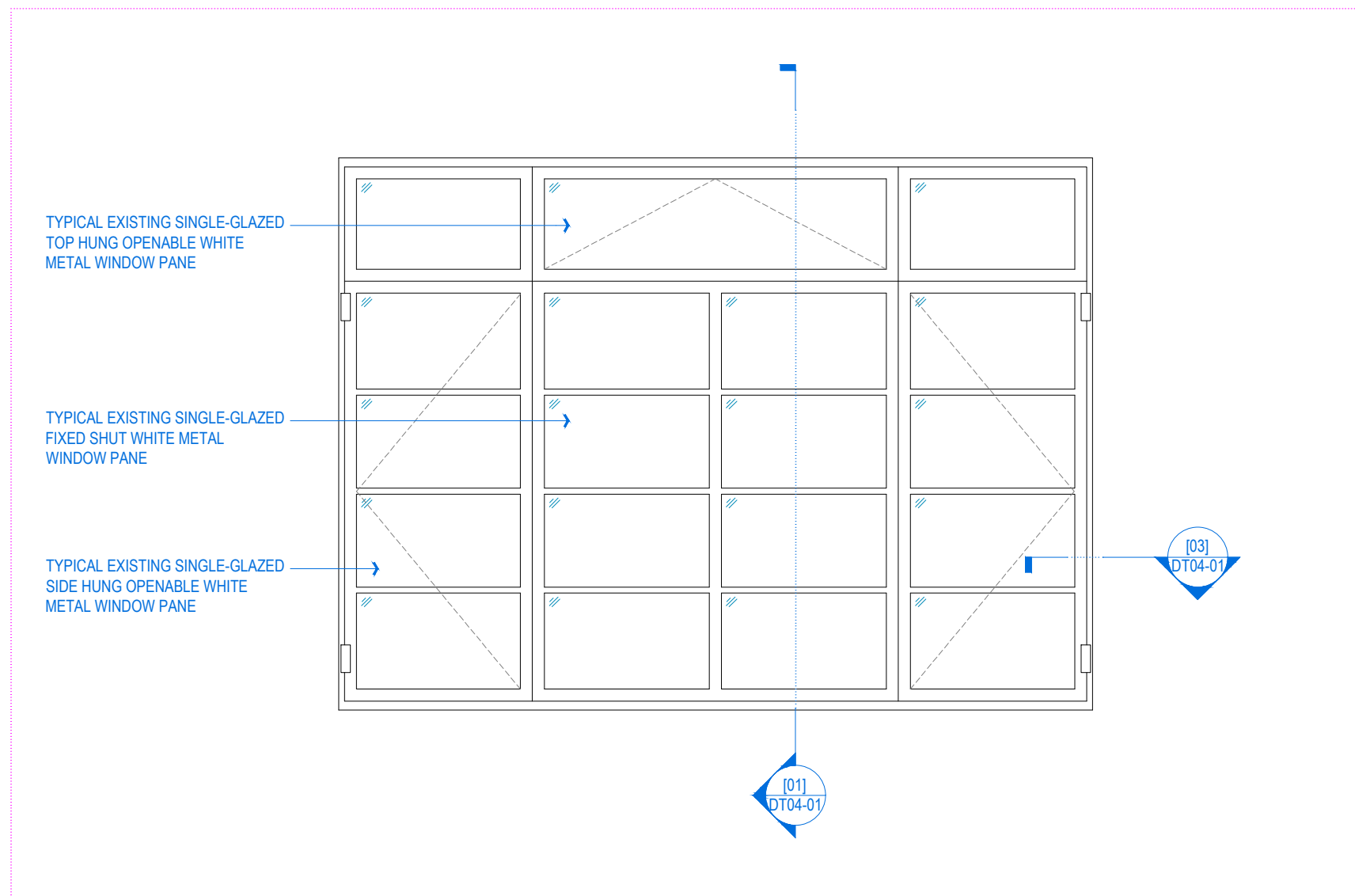

[05] EXISTING WINDOW TYPE 1 (ON ELEVATION 1 - FRONT ELEVATION)

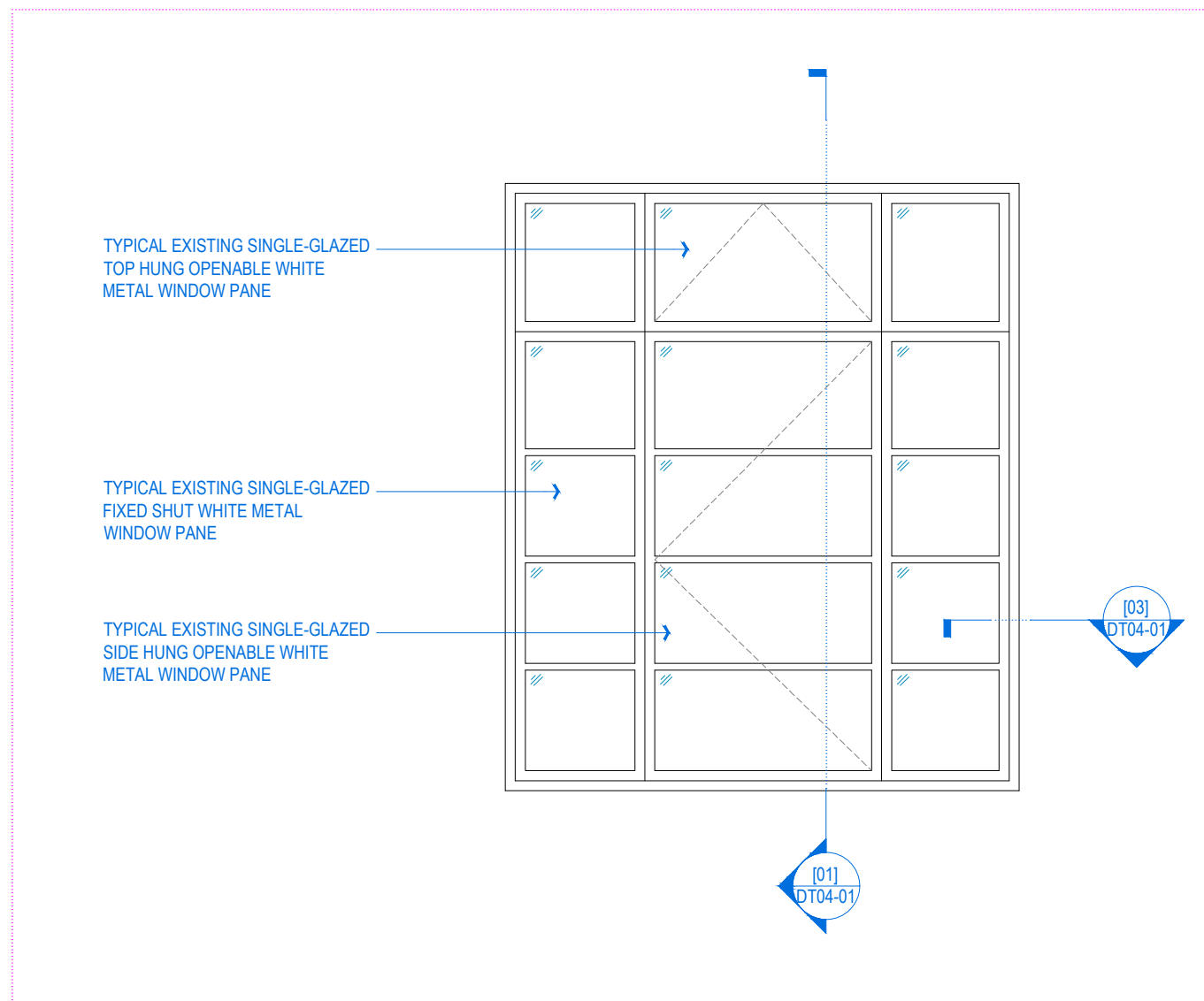

[06] EXISTING WINDOW TYPE 2 (ON ELEVATION 1 - FRONT ELEVATION)

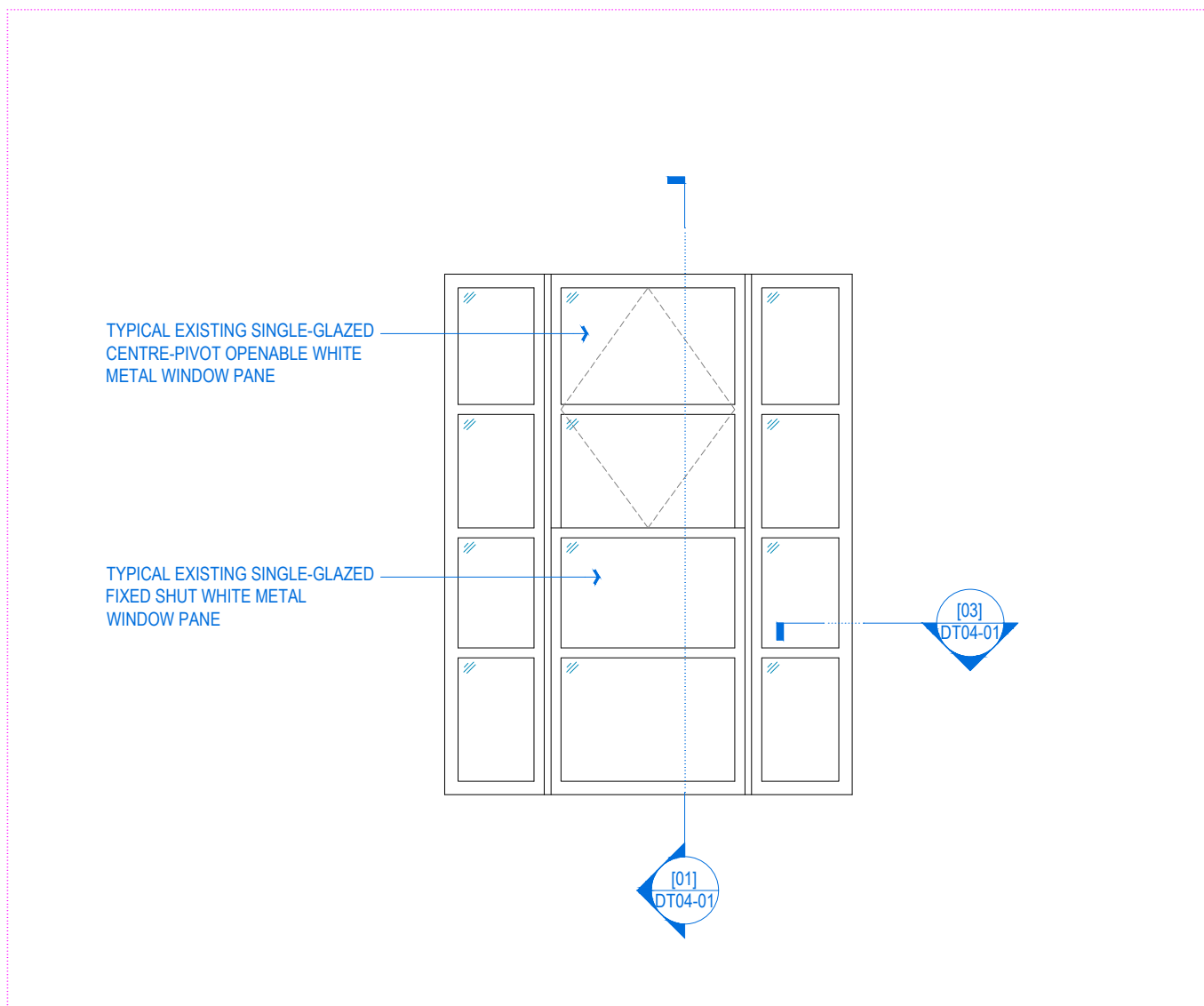

[07] EXISTING WINDOW TYPE 3 (ON ELEVATION 1 - FRONT ELEVATION)

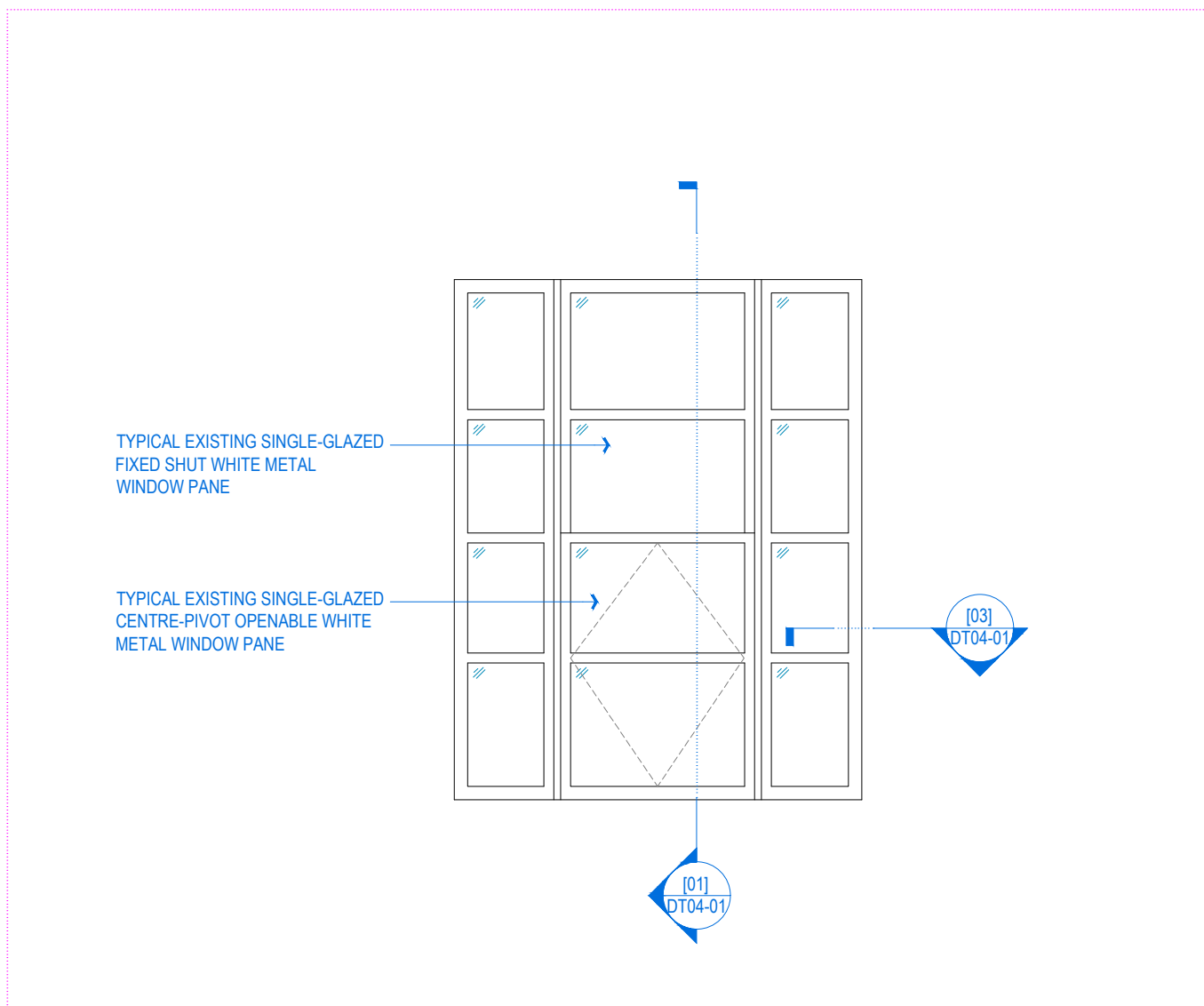

[08] EXISTING WINDOW TYPE 4 (ON ELEVATION 1 - FRONT ELEVATION)

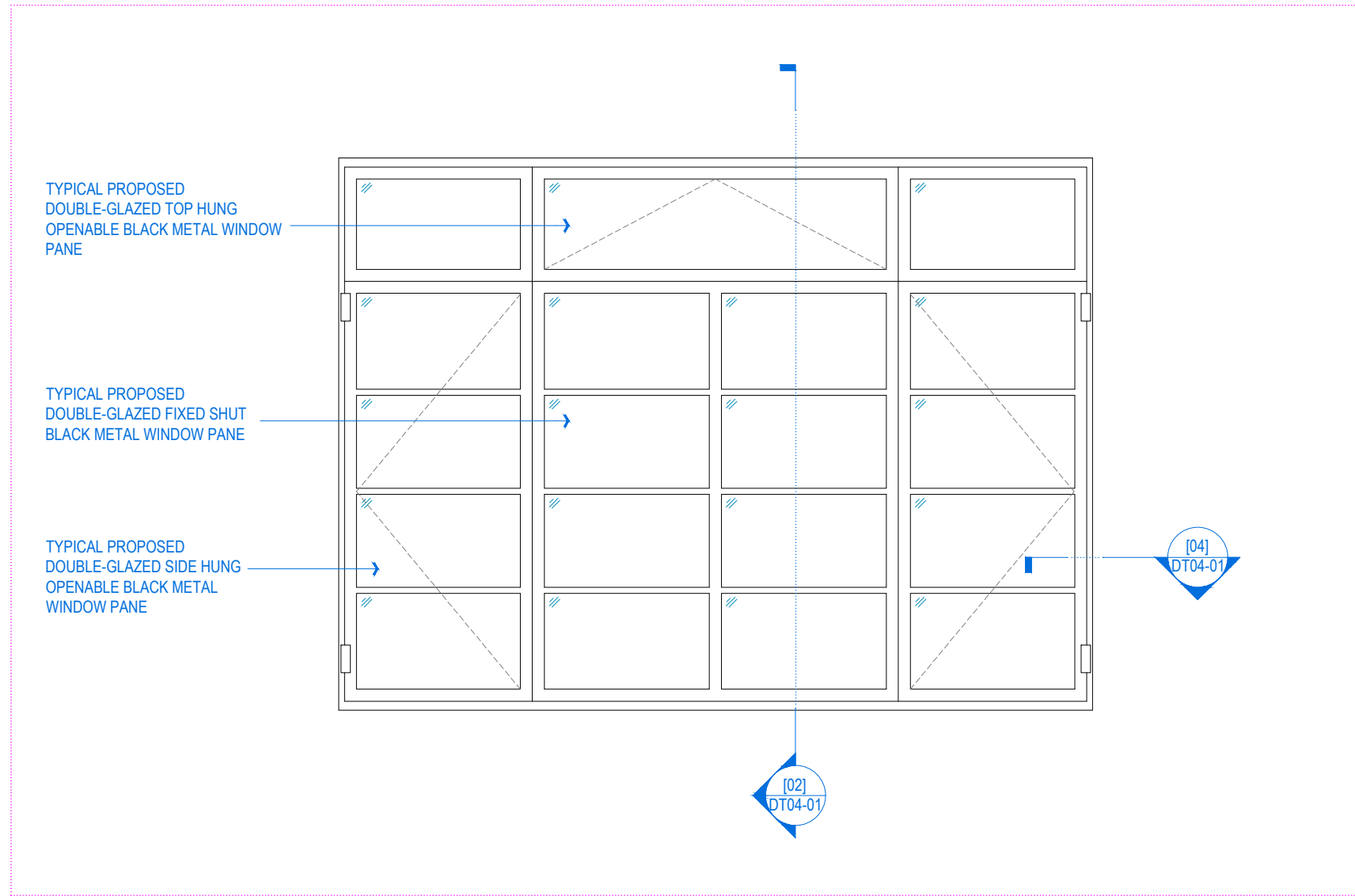

[09] PROPOSED WINDOW TYPE 1 (ON ELEVATION 1 - FRONT ELEVATION)

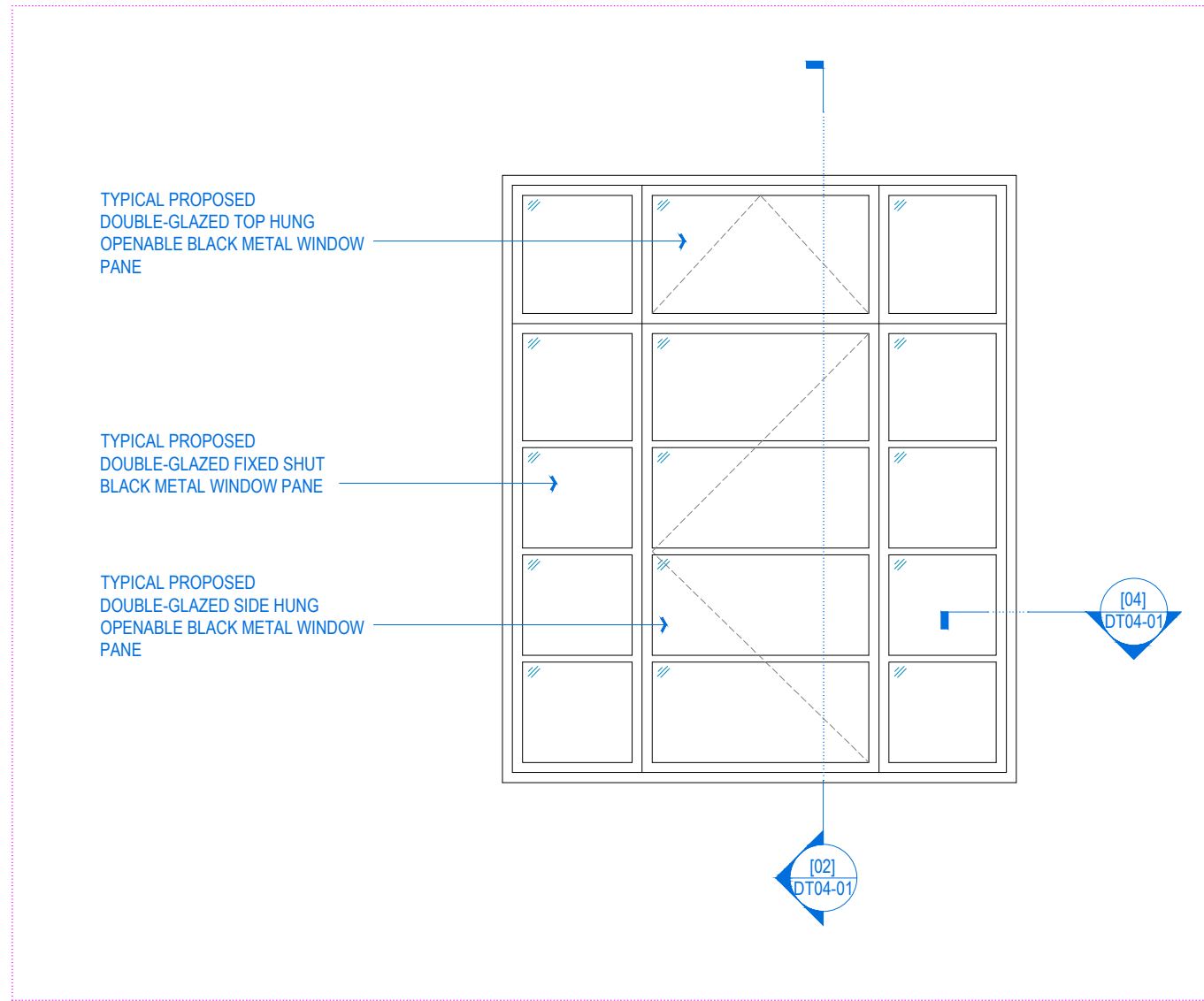

[10] PROPOSED WINDOW TYPE 2 (ON ELEVATION 1 - FRONT ELEVATION)

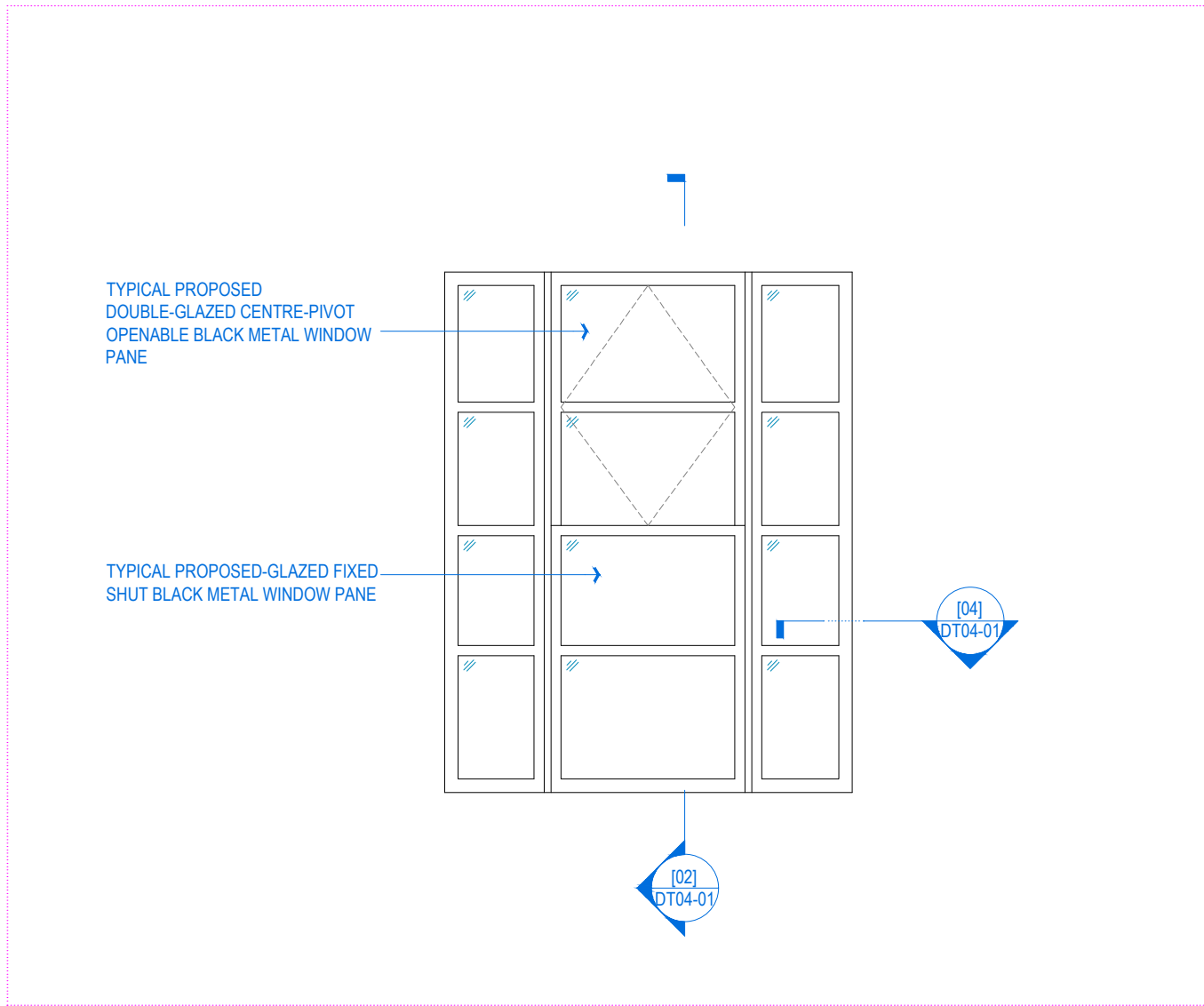

[11] PROPOSED WINDOW TYPE 3 (ON ELEVATION 1 - FRONT ELEVATION)

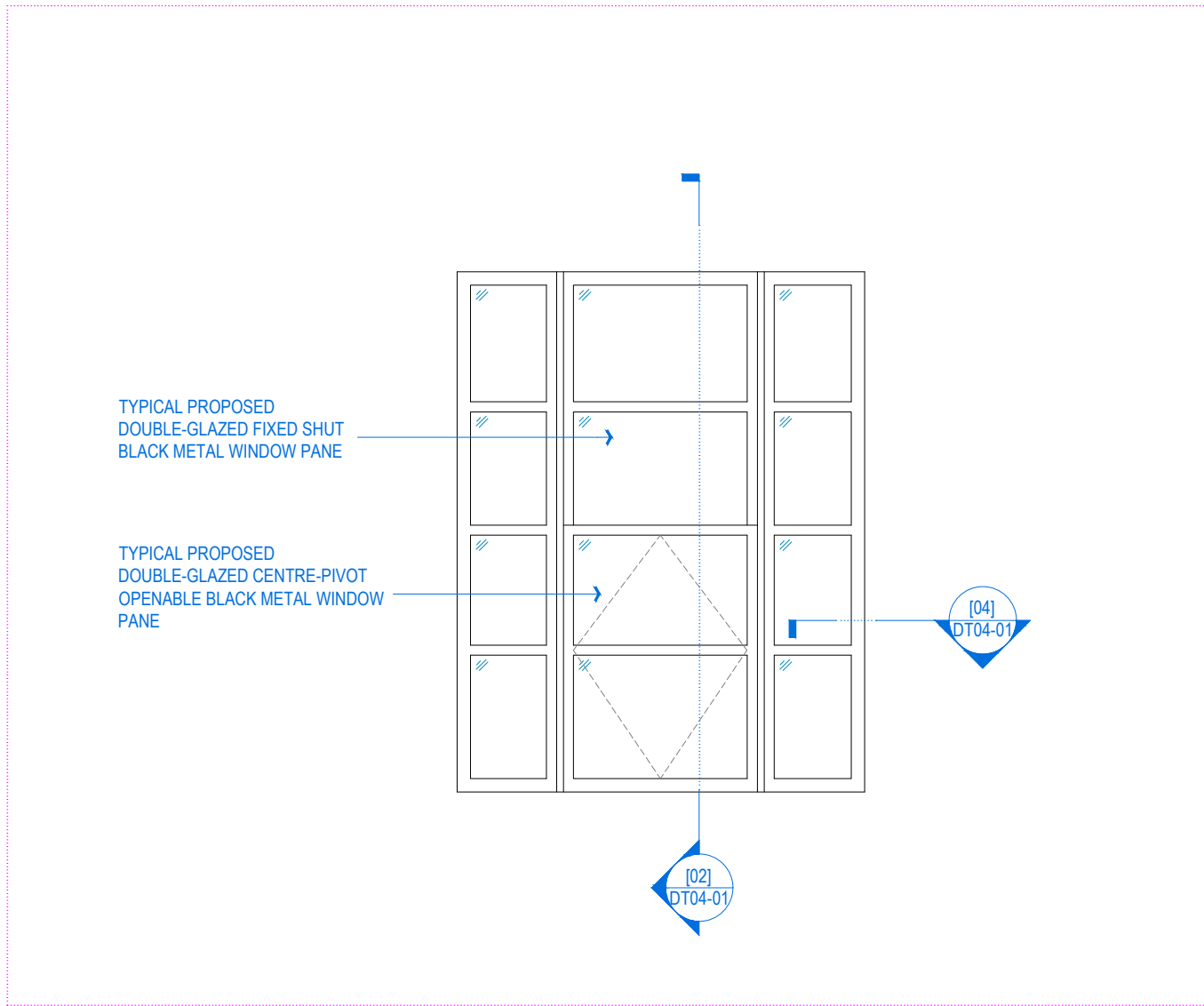

[12] PROPOSED WINDOW TYPE 4 (ON ELEVATION 1 - FRONT ELEVATION)

NOTE:  
DO NOT SCALE FROM DRAWINGS - EXCEPT FOR PLANNING PURPOSES.  
ALL DISCREPANCIES TO BE REPORTED TO ARCHITECT IMMEDIATELY.  
ALL DIMENSIONS TO BE VERIFIED BY CONTRACTOR ON SITE PRIOR TO THE COMMENCEMENT OF ANY WORKS.

Scale 1:20  
0 200 500 1000 2000mm

P1 25/05/25 Planning application issue

**VIVENDI ARCHITECTS LTD**  
Unit 3, 37 High Street, London, N14 6LD  
Tel/Fax +44 (0)20 3332 4000 email: info@vivendarchitects.com

CLIENT:  
**LAZARI PROPERTIES 1 Ltd.**

PROJECT TITLE:  
**Queens House, 180-182 Tottenham Court Road, Camden, London, W1T 7PD**  
DRAWING TITLE:  
**Window Details - Sheet 1**

DRAWN:  
EC  
CHECKED:  
CK  
REVISED BY:  
AW  
JOB AND DRAWING NO:  
**2074-DT04-01**

STATUS:  
**PLA**  
SCALE AT A1:  
**1:20**  
REVISION:  
**P1**