

5 Bartholomew Road NW5 2AH

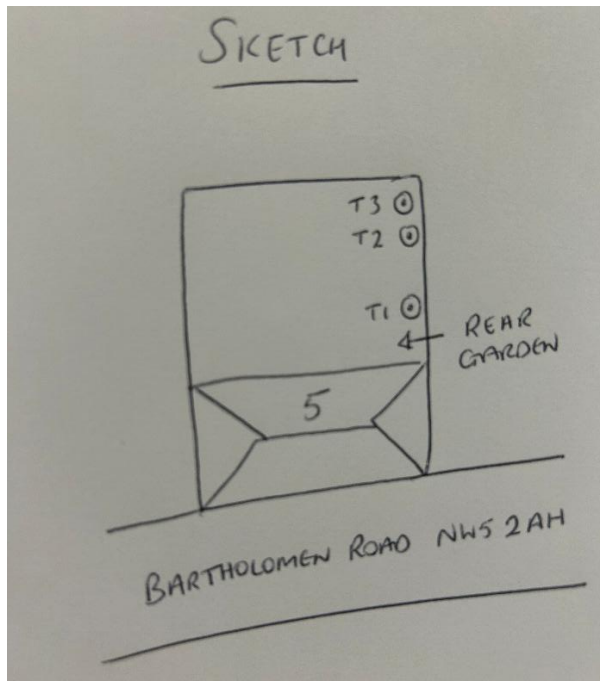

T1: Ash (9m): Reduce height by 2m and shape to keep tree at a size suitable for its location, as part of regular maintenance and to allow more light into garden of number 3

T2: Bay (10m): Reduce back to boundary and reduce height by 4m to keep tree at a size suitable for its location, as part of regular maintenance and to allow more light into garden of number 3

T3: Lime (12m): Reduce back to boundary to keep tree at a size suitable for its location, as part of regular maintenance and to allow more light into garden of number 3