

Existing Second Floor Plan  
Scale: 1:100

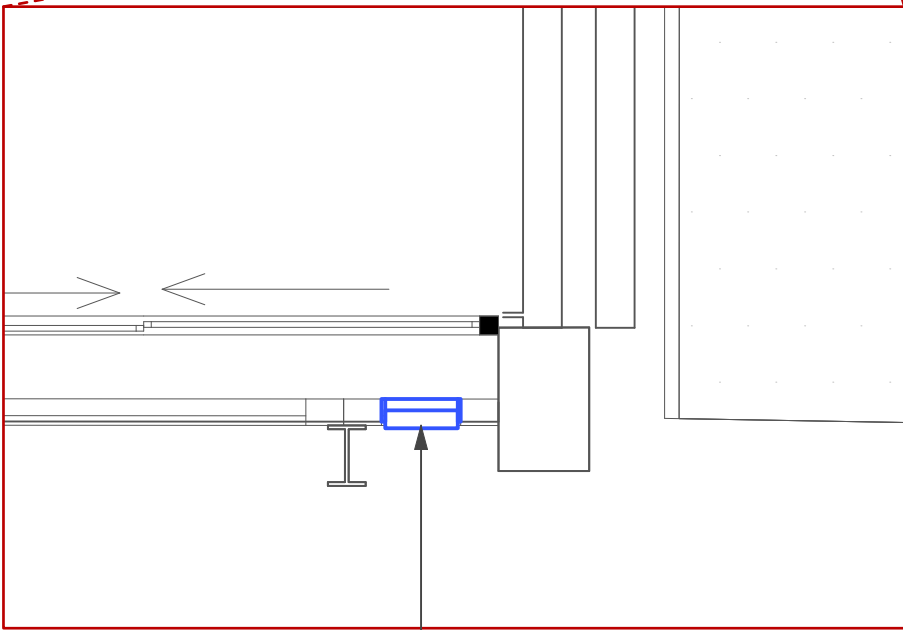

New Louvre approx 200 X  
1800mm

SW11 - 009 - BLOOMSBURY THEATRE  
PROPOSED SECOND FLOOR PLAN - UCLU COMMON ROOM, TOILETS & ROOMS 203A / 203B

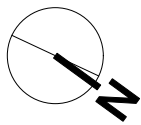
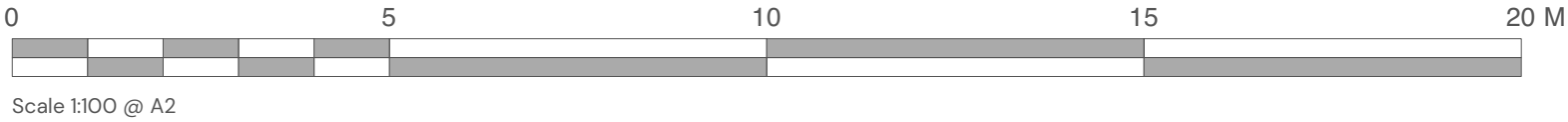

Suite 3, Sandford House,  
1b Claremont Rd, Teddington,  
TW11 8DH  
+44 (0)20 8943 5300  
www.kendallkingscott.co.uk

Do not scale this drawing

Project  
CESB Small Works 2023/24

Client  
UCL - University College London

Date	Drawn	Purpose/Status
17/02/2025	JL	PLANNING
Scale	Checked	Paper Size
1:100	ZI	ISO A2
Filename		
240080 CESB SW11-Planning.vwx		

PO1	17/02/2025	JL	ZI	Planning
Rev	Date	By	Ap	Note

Drawing Title	Revision
SW11 - 009 - Bloomsbury Theatre - Proposed Second Floor UCLU Common Room, Toilets & Rooms 203A / 203B	
Project Number/Drawing Number	
240080-SW11-1407	
Check all dimensions and levels on site	

P01  
© Copyright

Only to be used on the site for which designed. The electronic transmission of designs/information contained in this drawing is carried out entirely at the User's risk and Kendall Kingscott Ltd. will have no liability for any errors or inaccuracies arising therefrom. The production of amended or updated information from the said designs/information by the User is entirely the responsibility of the User and Kendall Kingscott Ltd. shall have no responsibility in respect thereof whatsoever.