

Drawing Notes

Rev	Date	Status	Note
01	09.02.2024	Planning	Planning Issue
02	11.04.2025	Planning	Planning Issue

Team

Client
Architect
Landscape Architect
Graphic Designer
Structural Engineer
Civil Engineer
MEP Engineer
Fire Consultant
Sustainability Consultant
Cost Consultant
Lighting Consultant
Planning Consultant
Approved Inspector
Project Manager

Lazari Investments Ltd
Gibson Thornley Architects
Studio ONB
BOB Design
Quadrant Harmon
GLP
GLP
Jenson Hughes
GLP
C N Associates
Pritchard Themis
CBRE
Salus
C N Associates

General Notes

- Do not scale from this drawing.
- All dimensions to be checked on site by the contractor and such dimensions to be his responsibility.
- Report all drawing errors, omissions and discrepancies to the architect.
- This document may be used in an uncontrolled CAD format to enable others to use it as background information to make alterations and/or additions. In that instance the file will be accompanied by a PDF version. It is for those making such alterations and additions to ensure that they make use of current background information.
- Gibson Thornley Architects accepts no liability for any such alterations or additions to the background information or arising out of changes to background information which occur prior to alterations or additions being made.

Location

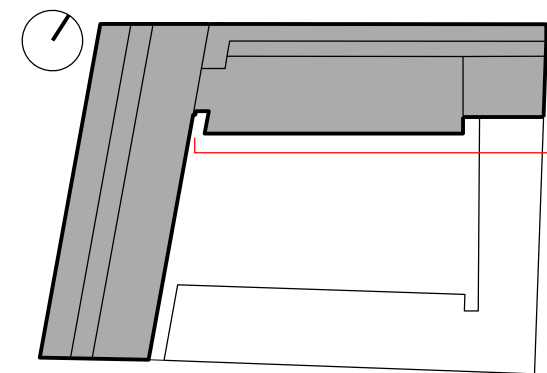

Gibson Thornley

Job Title
Drawing Title
Maple House
Proposed South Courtyard Elevation
Drawn by
Checked by
Scale
Status
FOS
BG
1:100 @ A1 / 1:200 @ A3
Planning

Project Zone Type Classification Drawing No Revision
20024B - AL [00] 213 02

Architects

Gibson Thornley Architects Limited
No. 4 The Hangar, Perseverance Works
25-27 Hackney Road
London E2 7NX

+44 (0)20 7729 7064
www.gibsonthornley.com