

Front Elevation

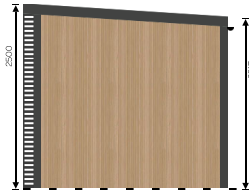

Right Elevation



Rear Elevation

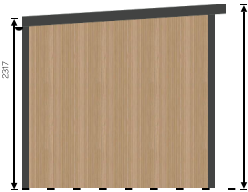

Left Elevation

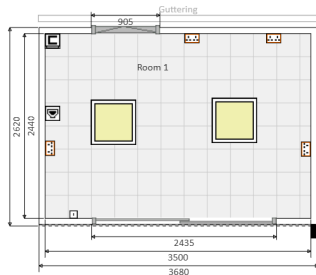

Floor plan



GENERAL CONSTRUCTION

Roof:  
80mm of high density polyurethane insulation with a 35mm top skin. 115mm in total

Floor:  
80mm Interlocking steel coated structurally insulated floor panels sit on top of foundation system.

Walls:  
High performance, custom-built insulated wall panels with a white-foiled MR MDF finish

Cladding:  
Composite oak cladding to front elevation.  
Composite oak cladding to right elevation.  
Composite oak cladding to rear elevation.  
Composite oak cladding to left elevation.

Doors:  
Sliding doors (2.4m) with Planitherm glass

Windows:  
Lozenge window (medium) (Opening: top-hung) with Planitherm glass

Drawing Title: Proposed Floor Plan & Elevation Drawings	Number: 1	Scale: 1:100 All measurements in mm, setup for A3 printing
Designed by: Becky Harper	Date: 23/04/2025	
Installation Address: Flat 2 77 Greencroft Gardens London NW6 3LJ	Design: Basebox Plus	
	Reference: 240700538MBundefined1-11623	