

existing 3rd floor plan

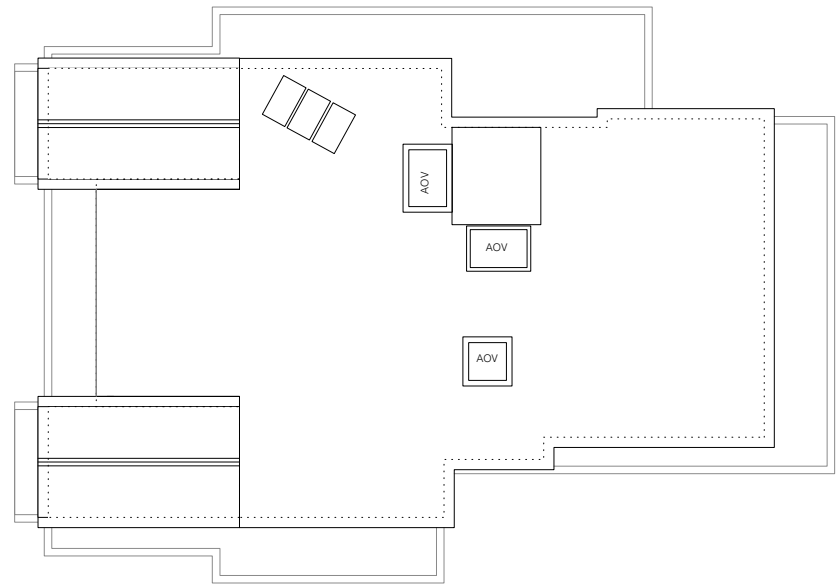

existing roof plan

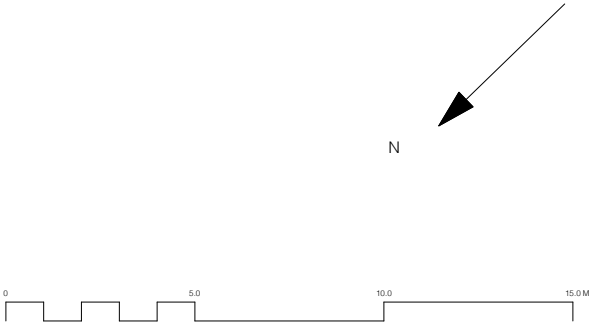

- NOTES:
- 1. This drawing is prepared solely for design and planning submission purposes. It is not intended or suitable for either Building Regulations or Construction purposes and should not be used for such.
  - 2. All dimensions must be checked and any discrepancies checked with architect prior to manufacture, fabrication and/or installation.
  - 3. All works to be carried out in accordance with British Standards, EU Regulations, Codes of Practice and all statutory obligations.

A 02.11.21 amended to suit/show greater detail

FLECK

24 Godwin Road, London E7 0LE  
T: 07814734654 E: info@fleckarchitecture.com

CLIENT:  
E.R.E. LLP

PROJECT:  
523 Finchley Road

STATUS:  
PLANNING

DRAWING:  
Existing 3rd floor and roof plans

DRAWN BY: C F      DATE: 0 1 0 8 2 0

SCALE: 1 : 1 0 0 @ A 3

DRAWING NUMBER: 1 1 4 2 P      REV 1 0 0 A