

UNDERPINNING - PHASE 4
LOWER GROUND
PLAN LAYOUT
SCALE 1:50

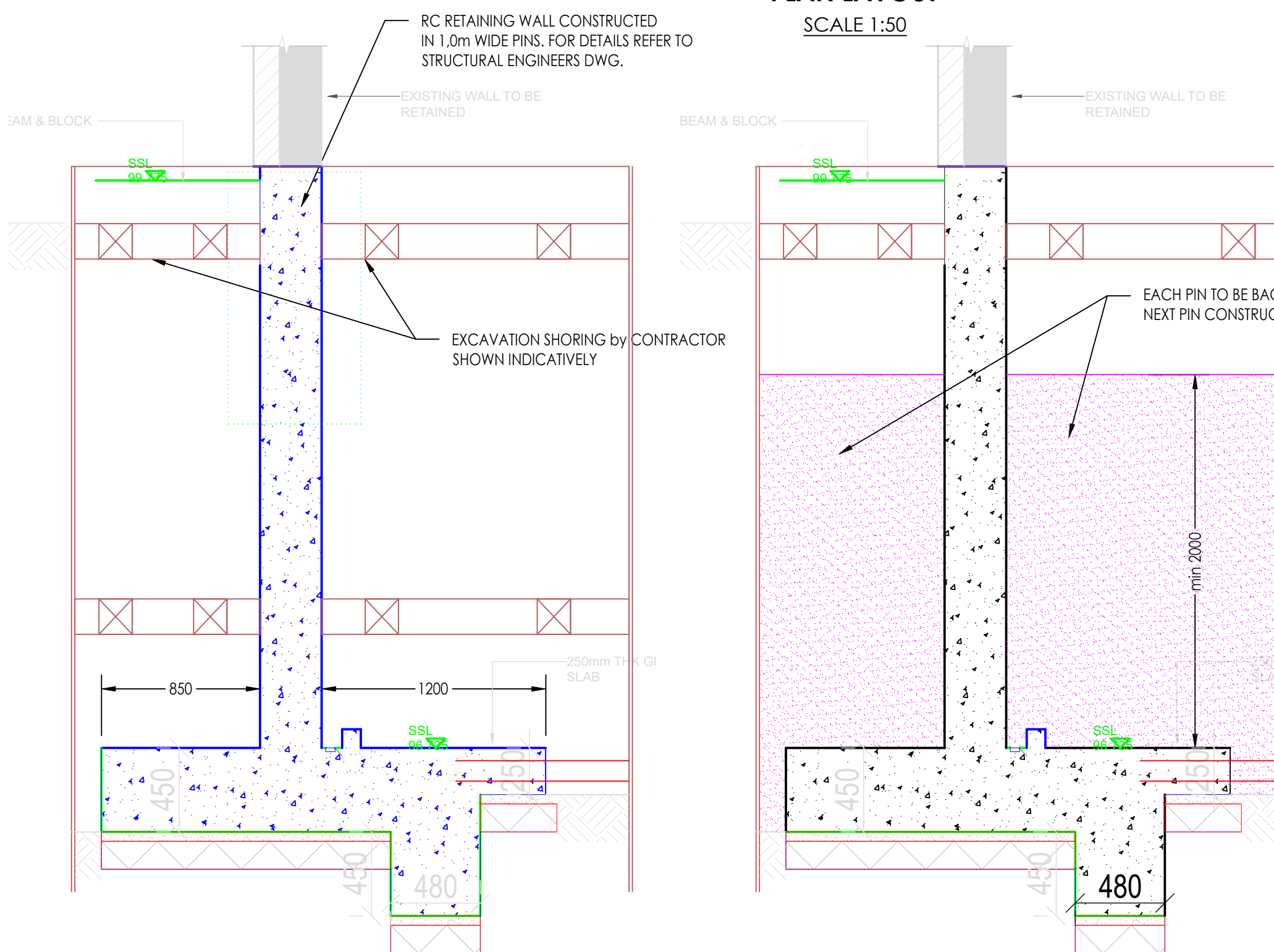

STEP 1

UNDERPINNING - PHASE 4
SECTION I-I
SCALE 1:50

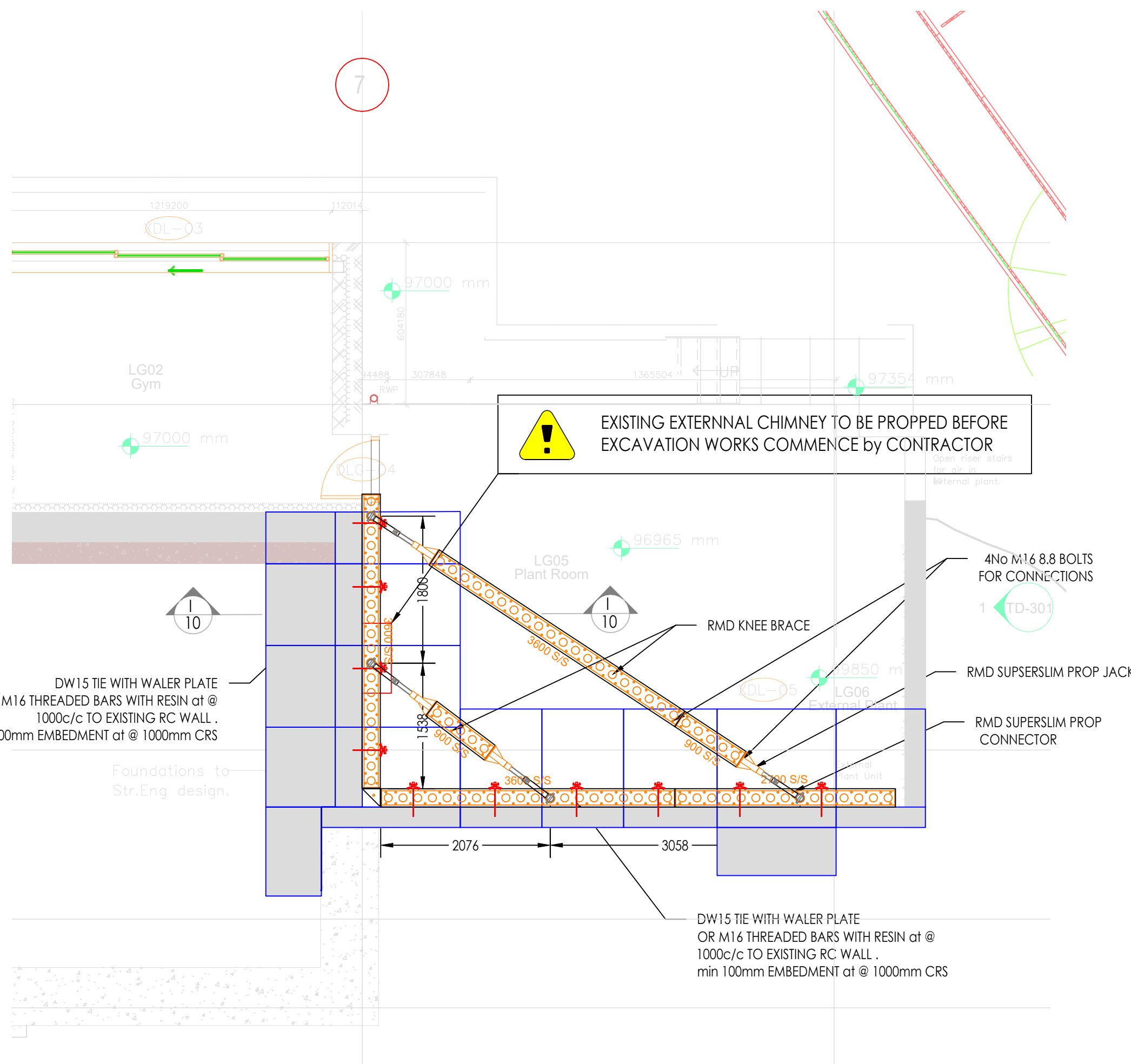

UNDERPINNING - PHASE 5
LOWER GROUND
PLAN LAYOUT
SCALE 1:50

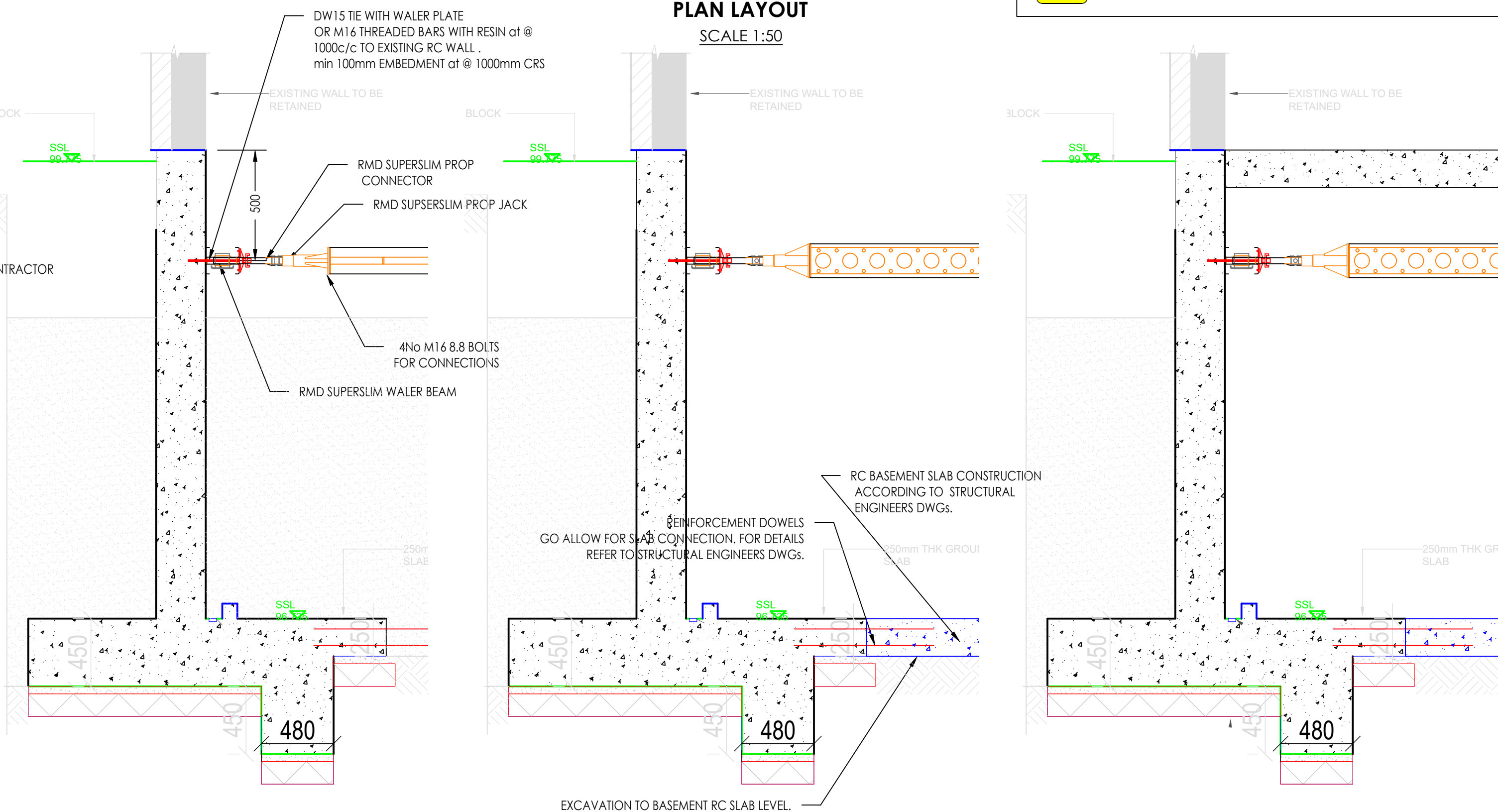

STEP 4

UNDERPINNING - PHASE 5
SECTION I-I
SCALE 1:50

TEMPORARY PROPS TO STAY IN PLACE UNTIL BASEMENT AND GROUND SLAB CONSTRUCTION.

STEP 5

- UNDERPINNING - PHASE 4 & 5
WORKS SEQUENCE:**
1. RC RETAINING WALL CONSTRUCTION IN 1.0m WIDE PINS ACCORDING TO PLAN.
 2. EACH PIN TO BE BACKFILLED AFTER CONSTRUCTION.
 3. TEMPORARY WALLER BEAMS INSTALLATION AFTER ALL PINS CONSTRUCTION AND BACKFILL.
 4. TEMPORARY KNEE BRACE INSTALLATION ACCORDING TO PLAN.
 5. EXCAVATION TO RS BASEMENT SLAB LEVEL.
 6. NEW RC BASEMENT SLAB CONSTRUCTION ACCORDING TO STRUCTURAL ENGINEERS DWGS.
 7. NEW GROUND FLOOR RC SLAB CONSTRUCTION ACCORDING TO STRUCTURAL ENGINEERS DWGS.
 8. TEMPORARY WALER BEAMS AND KNEE BRACE REMOVAL.
 9. PROCEED TO OTHER WORKS.

- GENERAL NOTES:**
- PROPS LEVEL INSTALLATION TBC ON SITE PRIOR TO WORKS COMMENCE
 - CUSTOMER TO REVIEW SCHEME AND ENSURE PROPPING DOES NOT INTERFERE WITH PROPOSED WORKS OR SEQUENCING
 - ALL SERVICES IN VICINITY OF PENETRATIONS TO BE REMOVED OR ISOLATED PRIOR TO ANY WORKS BEING UNDERTAKEN
 - LOCALISED CRACKING DURING STRUCTURAL ADAPATIONS CAN OCCUR - FOLLOW THE CONSTRUCTION SEQUENCE HEREIN TO MINIMISE RISK
 - CUSTOMER TO REVIEW SEQUENCE TO ENSURE PROPS ARE NOT DAMAGED OR DISTURBED AND ARE RETRIEVABLE
 - PROPS ARE NOT TO BE ADJUSTED, ALTERED OR REMOVED WITHOUT WRITTEN CONSENT OF IDH

GENERAL NOTES:				
This drawing is the property of TWS DESIGN LIMITED and no reproduction or disclosure thereof may be made in whole or in part without written permission.				
The following documents have been used to prepare this scheme:				
Customer drawings:				
Customer drawings:				
This drawing has been prepared from information supplied to us by direct site measurement by TWS DESIGN LIMITED. All information within this drawing is subject to checking by our Client ensure the requirements have been correctly interpreted. The Client & Contractor must satisfy themselves setting out, component selection, bay sizes, lift heights, loadings, reactions, are as required and practicable.				
Details and approach shown within this design are only relevant to this specific Project. Adapting details or approaches shown within this design to other applications, no matter how similar, can place you and other personnel at serious risk.				
EXISTING STRUCTURE & FOUNDATIONS: Our Client / the Contractor / Structural Engineer is to ensure that the existing structure, its fabric and support the imposed loads.				
No assessment of the ground conditions have been made in this design and it remains the responsibility of our Client, the Contractor or Structural Engineer to undertake this exercise and confirm suitability or state an allowable bearing pressure can work to.				
No assessment has been made of the existing structure to determine whether it can safely support the indicated imposed loads as this is beyond our knowledge and remains the responsibility of our Client, the Contractor or Structural Engineer.				
Our Client or the Contractor must prepare all foundations and enabling works to line and level as indicated in this drawing, prior to erection. No excavations are to occur in the proximity of the erected structure without prior consent of TWS DESIGN LIMITED.				
RESIDUAL RISK NOTES: It is not the policy of TWS DESIGN LIMITED to prepare specific Designer Risk Assessments as design risks are identified within the drawing. Where risks cannot be eliminated and thereby reside within the scheme they are classified as 'Residual Risk' and will be identified with a warning triangle.				
DATE	REV	REVISION DESCRIPTION	DRN	CHK
25/01/24	01	CLIENTS COMMENTS	MH	TS

DRAWING STATUS	
PRELIMINARY	
PointDesign Limited	
Tel: 02034883118 www.pointdesign.uk q@pointdesign.uk	
CLIENT NAME	
PROJECT NAME 12 PILGRIM'S LANE HAMPSTEAD, LONDON	
DRAWING TITLE UNDERPINNING -PHASE 4 & 5 PLAN & SECTIONS	

DRAWING NUMBER	REVISION	SCALE	DESIGNER	DATE
4070-10	1	As Shown @ A2	MH	25/01/24
CHECKER	DATE			
TS	25/01/24			