

SCALE 1:50 @ A1, 1:100 @ A3

**1 Front Boundary Plan - Existing**

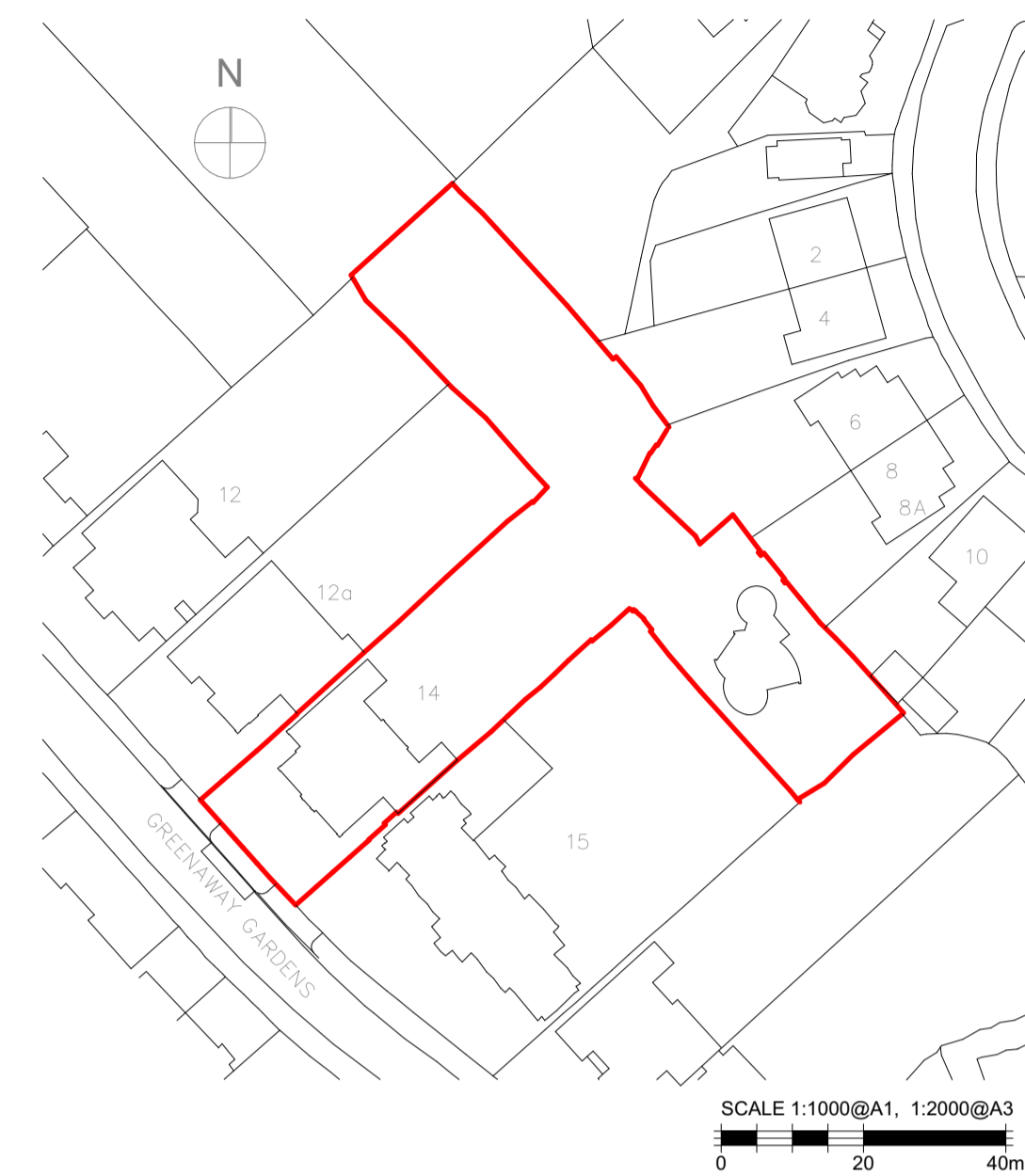

**3** SCALE 1:1000 @ A1, 1:2000 @ A3  
**Location Plan**

Figured dimensions only are to be taken from this drawing. All dimensions are to be checked on site before any work is put in hand.  
If in doubt, ask.

Any discrepancies to be highlighted to SHH prior to procurement and in good time.

Copyright © Spence Harris Hogan Limited 2025  
Registered in England & Wales. Registered No. 261 0615  
SHH is the trading name of Spence Harris Hogan Limited

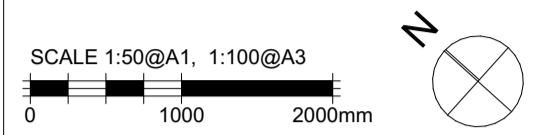

Legends & Notes:

Material Notes:

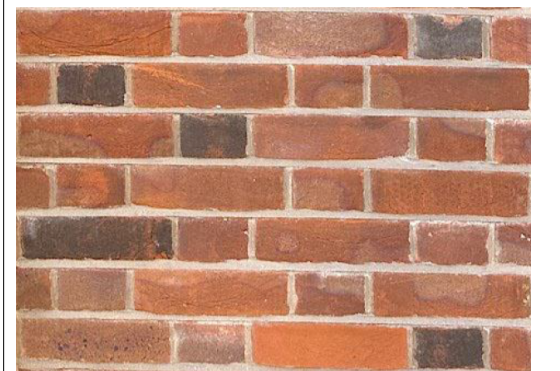

**Brick Piers and Walls:**  
Bricks pictured above to be used for all proposed front boundary brick piers and walls as approved in Condition 4B of planning permission 2021/6257/P for the Main House.

The approved brick blend is made up of a combination of Sussex Handmade, Henley Multi, Henley Black, and Ibstock Swanage Handmade bricks.

**Coping Stones:**  
Portland Broadcroft Whitbed stone to be used for all coping stones on top of walls and piers. This will match the sills and portico of the main house.

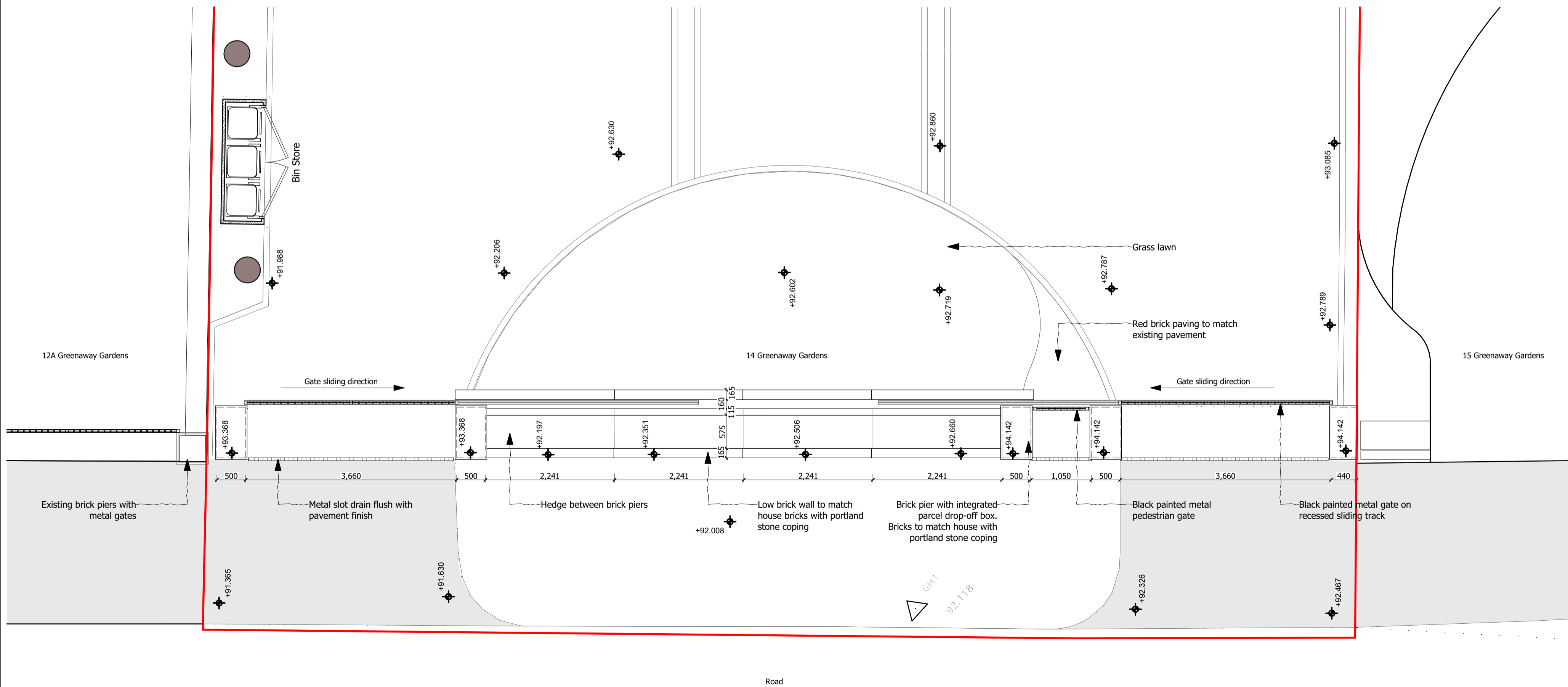

SCALE 1:50 @ A1, 1:100 @ A3

**2 Front Boundary Plan - Proposed**

[illegible]

**shh**

Architecture &  
Interior Design

RIBA   
Chartered Practice

1 Vencourt Place, Ravenscourt Park  
Hammersmith, London W6 9NU  
Phone +44 (0) 20 8600 4171 Email [info@shh.co.uk](mailto:info@shh.co.uk)  
**shh.co.uk**

 MEMBER

**14 Greenaway Gardens**  
14 Greenaway Gardens  
Hampstead, NW3 7DH

---

Client:

**PRIVATE**

---

Drawing Title:  
**PROPOSED ELEVATIONS**

---

**Proposed Front Boundary  
Plan**

(Project number)DWG number\_Revision:  
**(0942)3226\_PL01**