

2 Proposed Block Plan

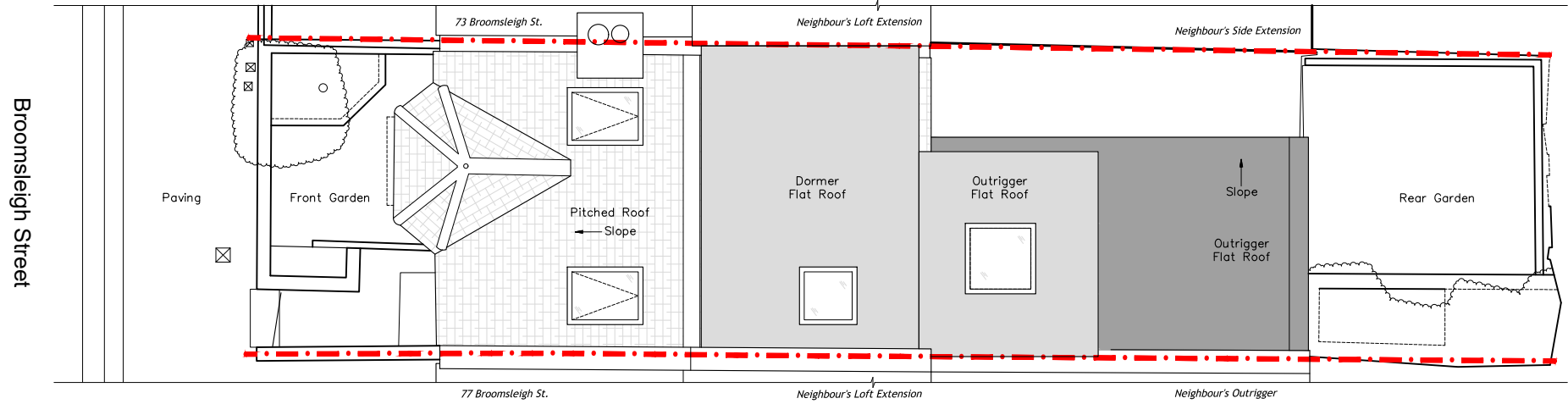

1 Existing Block Plan
LDC # 2025/1005/P

GENERAL NOTES:

Copyright of this drawing remains the sole property of MIM Studios Ltd unless otherwise stated in writing.

This drawing is to be read in conjunction with all other relevant drawings, specifications and calculations.

All dimensions to be physically checked on site by the Contractor prior to commencement of any work, and/or preparation of any shop drawings.

Sizes of and dimensions to any structural elements are indicative only. See structural engineers drawings for actual sizes / dimensions.

Any discrepancies between information shown on this drawing and any other contract information or manufacturers / suppliers recommendations is to be brought to the attention of the Architect.

This drawing is prepared solely for design and planning submission purposes. It is not intended or suitable for either Building Regulations or Construction purposes and should not be used for such.

All dimensions are in mm unless noted otherwise.

Rev.	Date	Reason For Issue
------	------	------------------

LEGEND
SITE BOUNDARY

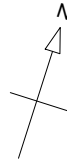

1m 5m

Client
Emily Adams & Charlie Adams

75 Broomsleigh Street
London NW6 1QQ

Designer
MIM Studios Ltd
1 Waterden Rd. Studio 11
London E15 2HB
Telephone + 44 (0)7921918996
info@mimstudios.com

Project
137_BroomsleighStreet

Drawing
Block Plan / Roof Plan

Scale
1:100 @ A3

Date
30/04/2025

Rev
-

Drawing No
A003

Originator
MIM

Drawing Status
Planning (Householder)