

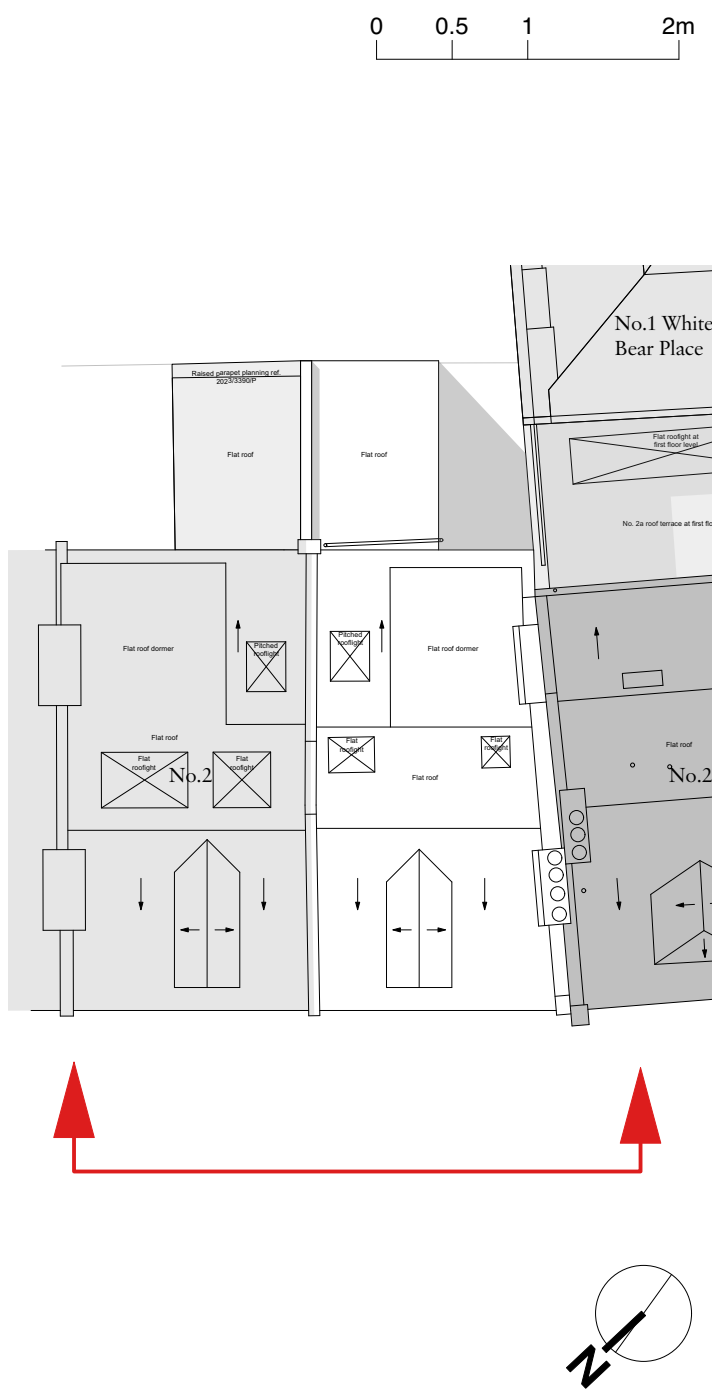

New front screen and mid/dark grey finish to sash windows of No.2a granted May 2022 as part of planning permission ref. 2021/4881/P



Rev	Date	Details	By
-----	------	---------	----

Charlton Brown Architecture & Interiors

10-11 St. George's Mews, Primrose Hill, London, NW1 8XE

Telephone +44(0)20 7794 1234
Email office@charltonbrown.com
Website www.charltonbrown.com

Client

Mr Gray

Project

1 Well Road

Drawing Title

Existing North West Elevation

Date	Drawn	Checked
16.04.2025	LF	JM

Scale

1:50@A/ / 1:100@A3

Issue Status

Planning

Project Number	Drawing Number	Revision
25006	EX-XX-300	