

general notes

Do not scale from this drawing. Base survey carried out by others.

Use figured dimensions only & bring any discrepancies to the attention of the Architect. Figured dimensions are in millimeters.

All specified products and materials to be fitted and installed according to manufacturers specifications & instructions

All building works to be carried out in accordance with current Building Regulations, British Standards & relevant codes of practice

This drawing is the property of ROAR Architects Ltd. This drawing is copyright

note

proposed construction

key

1. New rendered ground floor rear extension
2. Adjust head of void opening to accomodate new roof structure
3. New aluminium frame glazed doors
4. New drainage channel
5. PPC aluminium coping
6. New flat roof
7. Repaint existing outrigger
8. Replace existing timber window conformed by a fixed glazed panel & an openable panel with a new timber frame double glazed casement window
9. New access hatch to loft storage
10. New cast iron style hopper
11. New flat rooflight
12. Existing floor covering to be replaced with underfloor heating and timber flooring
13. New outdoor pavers laid to falls
14. Existing no. 19 Leverton St line of rear extension
15. Existing no. 21 Leverton St line of rear extension
16. Existing no. 23 Leverton St line of rear extension
17. 50mm rendered plinth recess
18. Existing garden brickwork wall

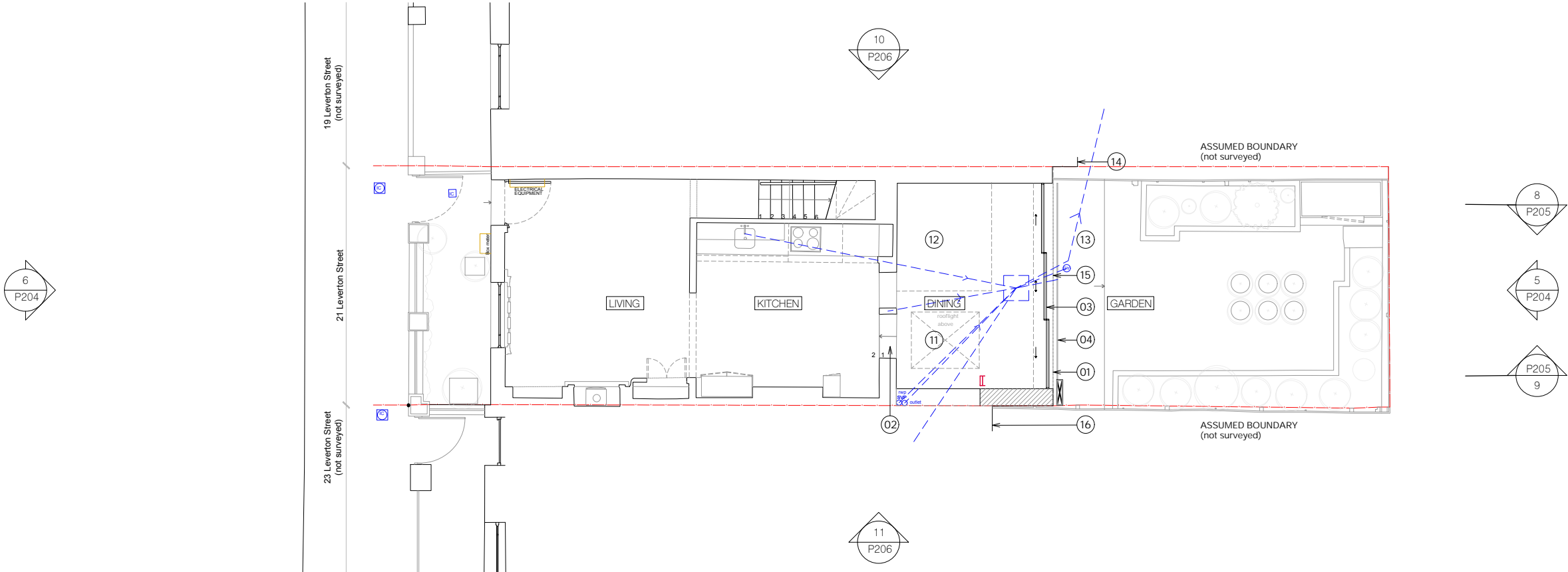

1 proposed ground floor plan

**ROAR** 8-11 St Johns Lane  
London  
EC1M 4BF  
020 8080 2055

project  
21 Leverton Street  
London NW5 2PH

client  
Sarah Paterson

drawing title  
PP Ground floor plan

drawing status  
Planning

scale at A1	scale at A3	date
1:50	1:100	APR 25

job no.	drawing no.	rev.
219	P200	----

drawn by.	checked by.
PM	SOB

