

Elevation A

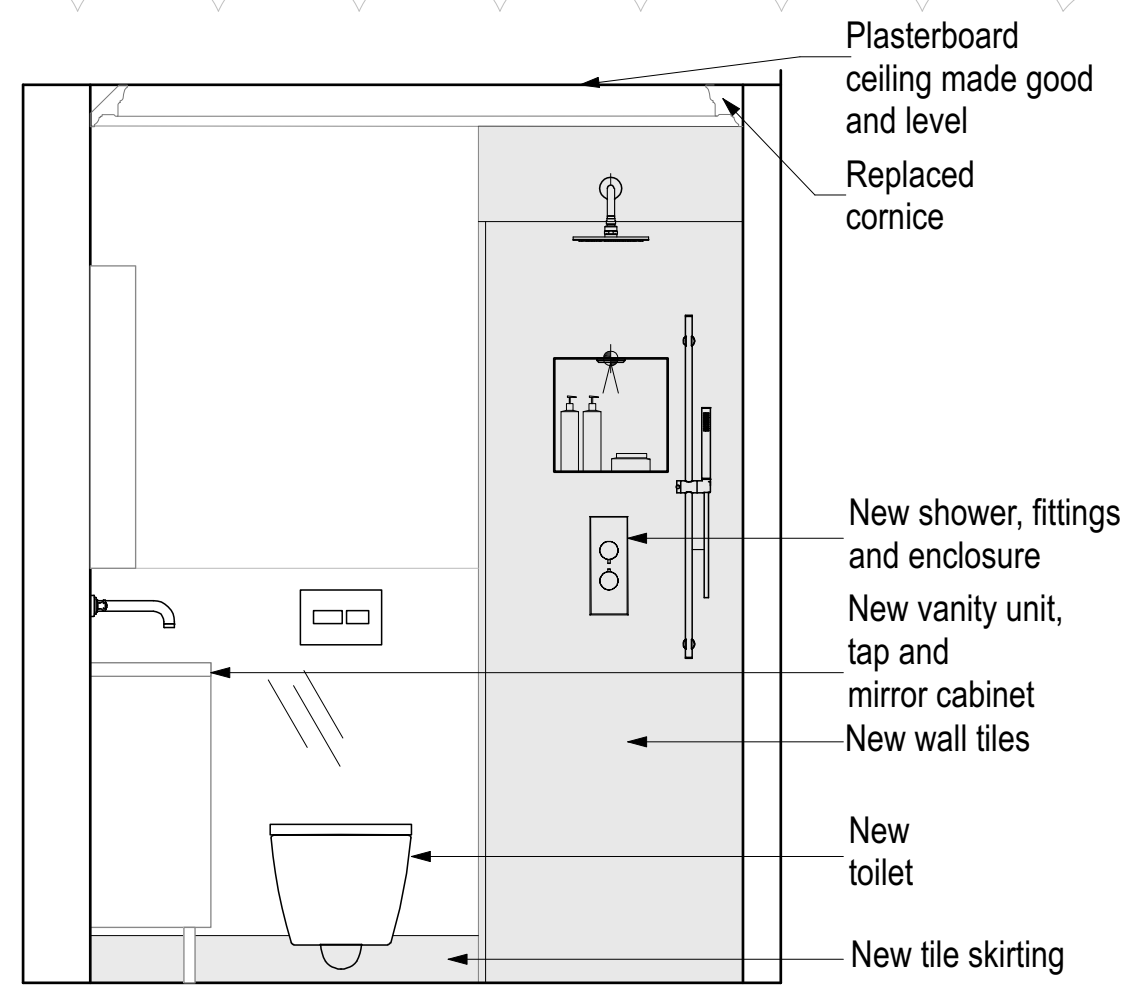

Elevation B

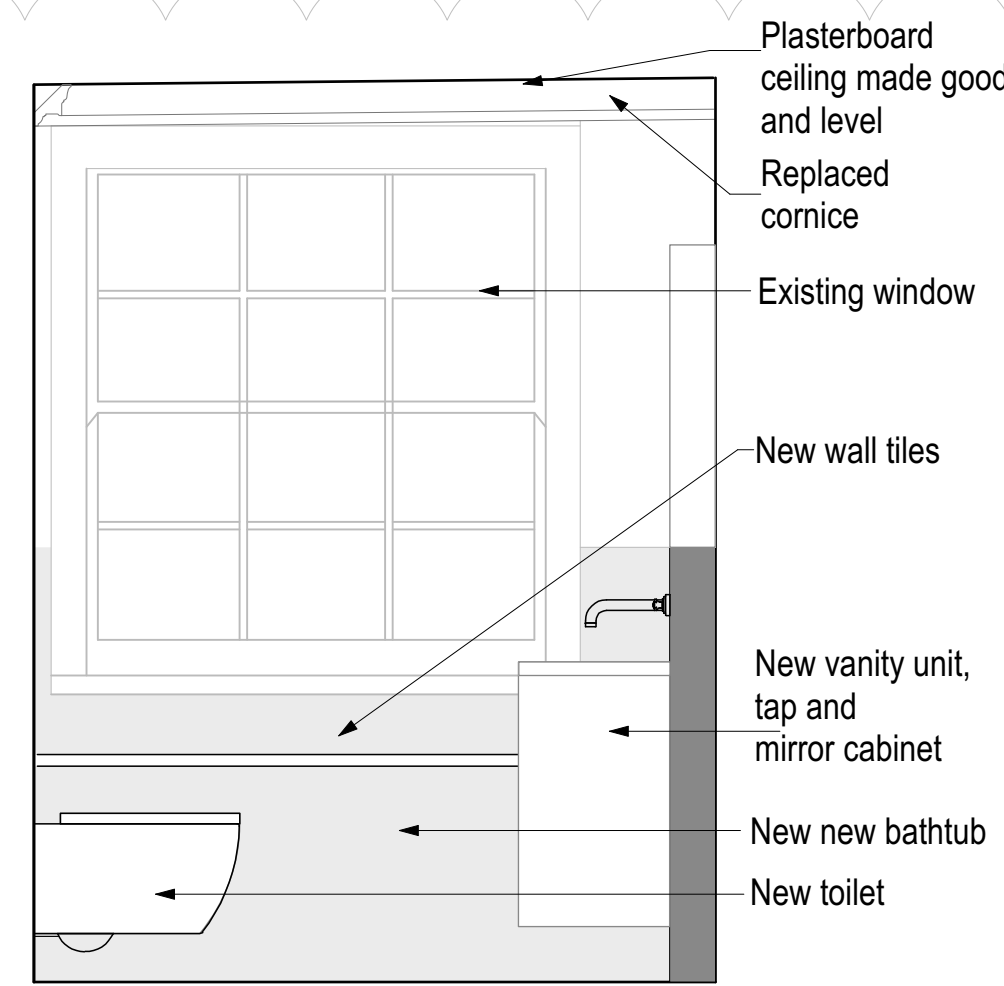

Elevation E

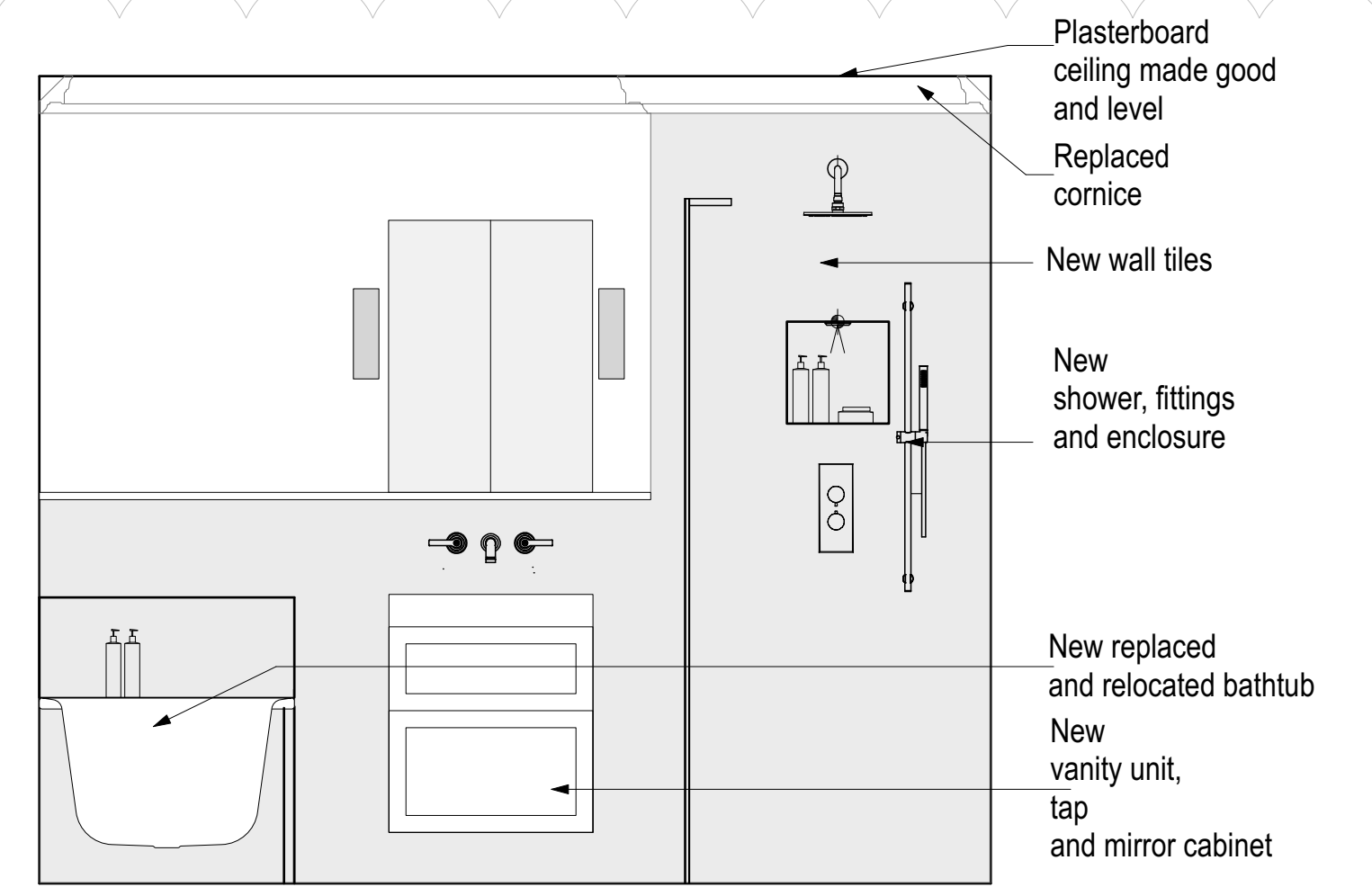

Elevation F

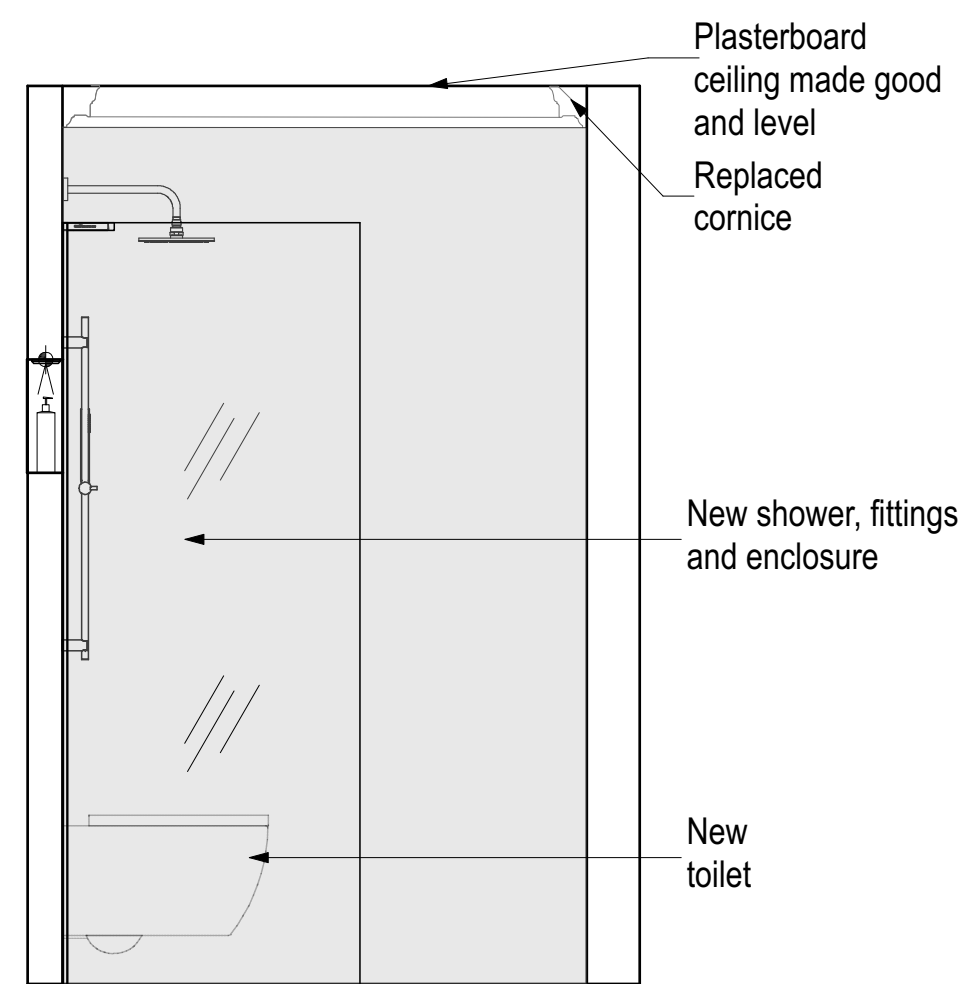

Elevation C

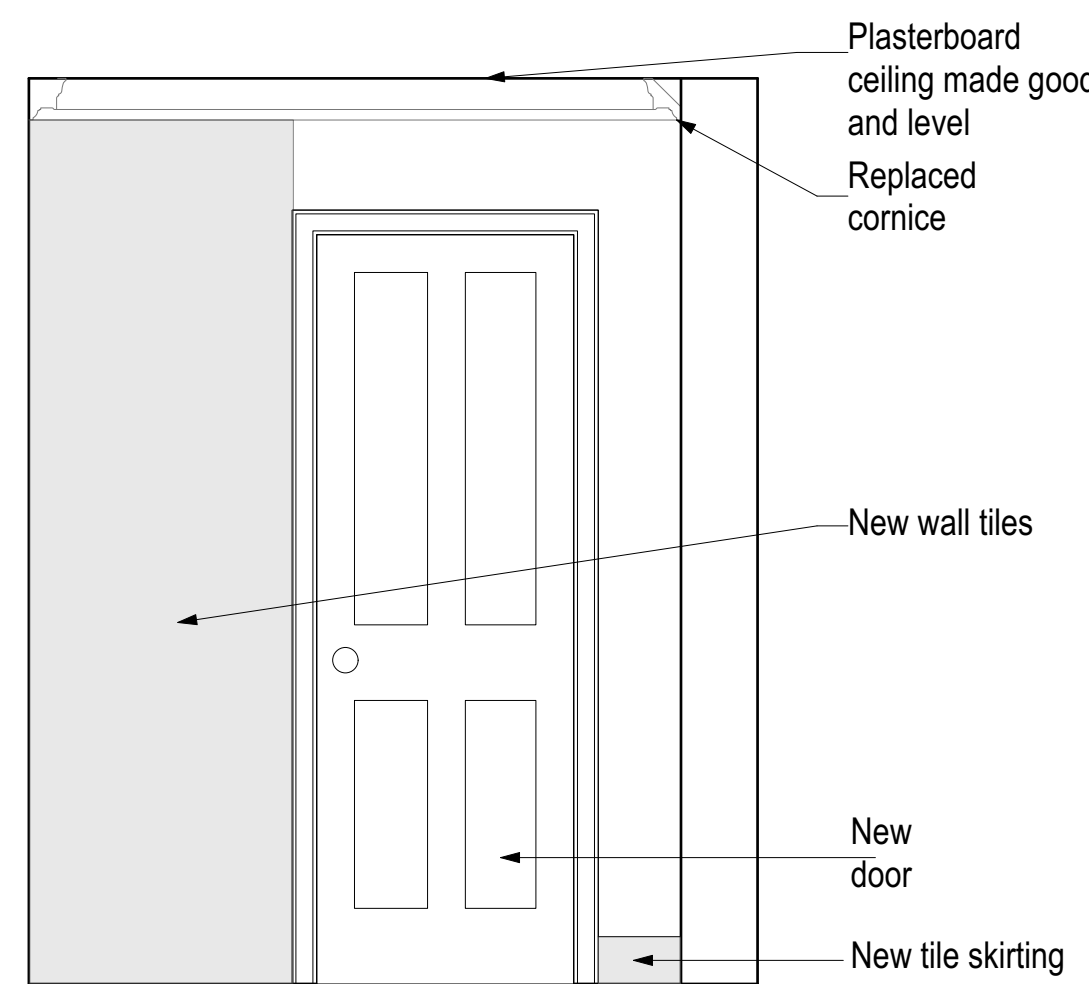

Elevation D

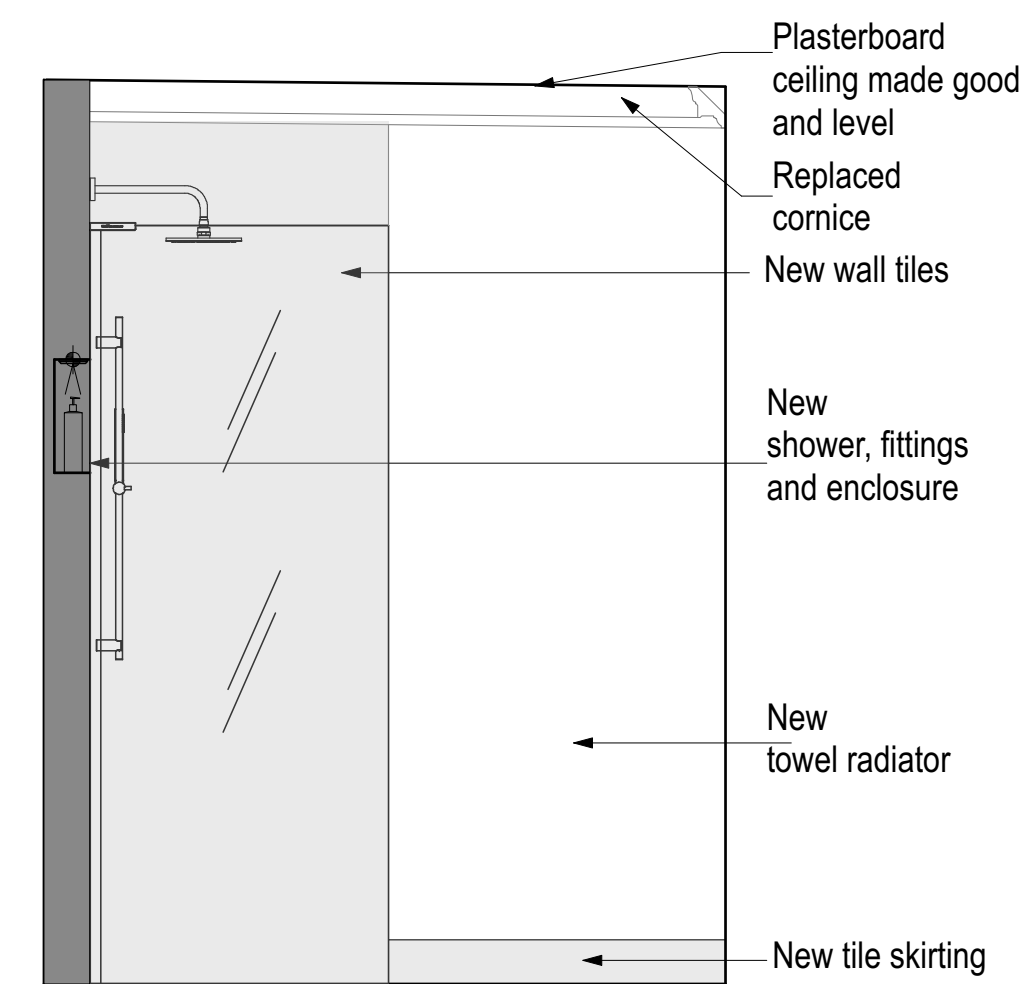

Elevation G

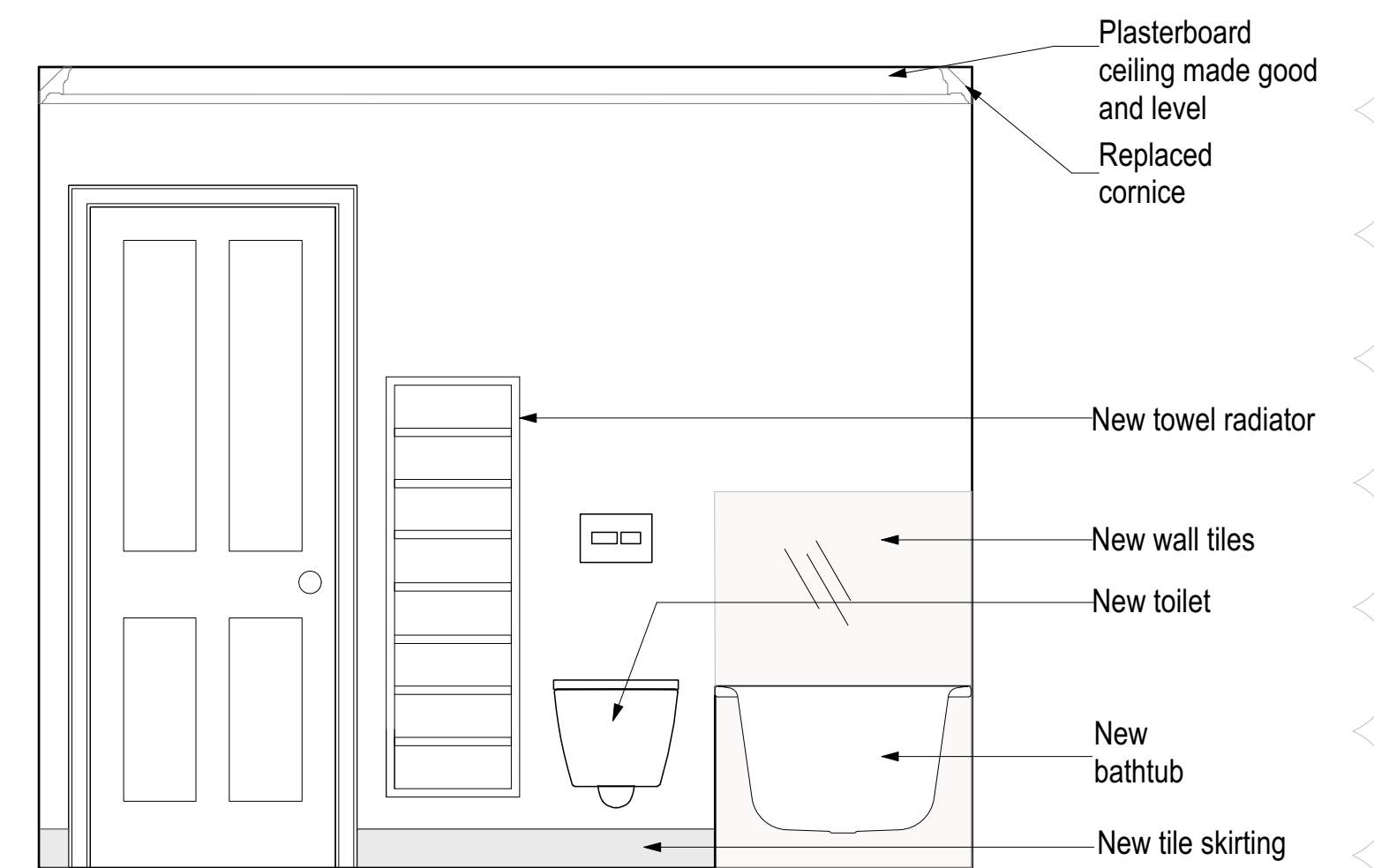

Elevation H

2 Shower Room 3rd Floor Elevations
1:20

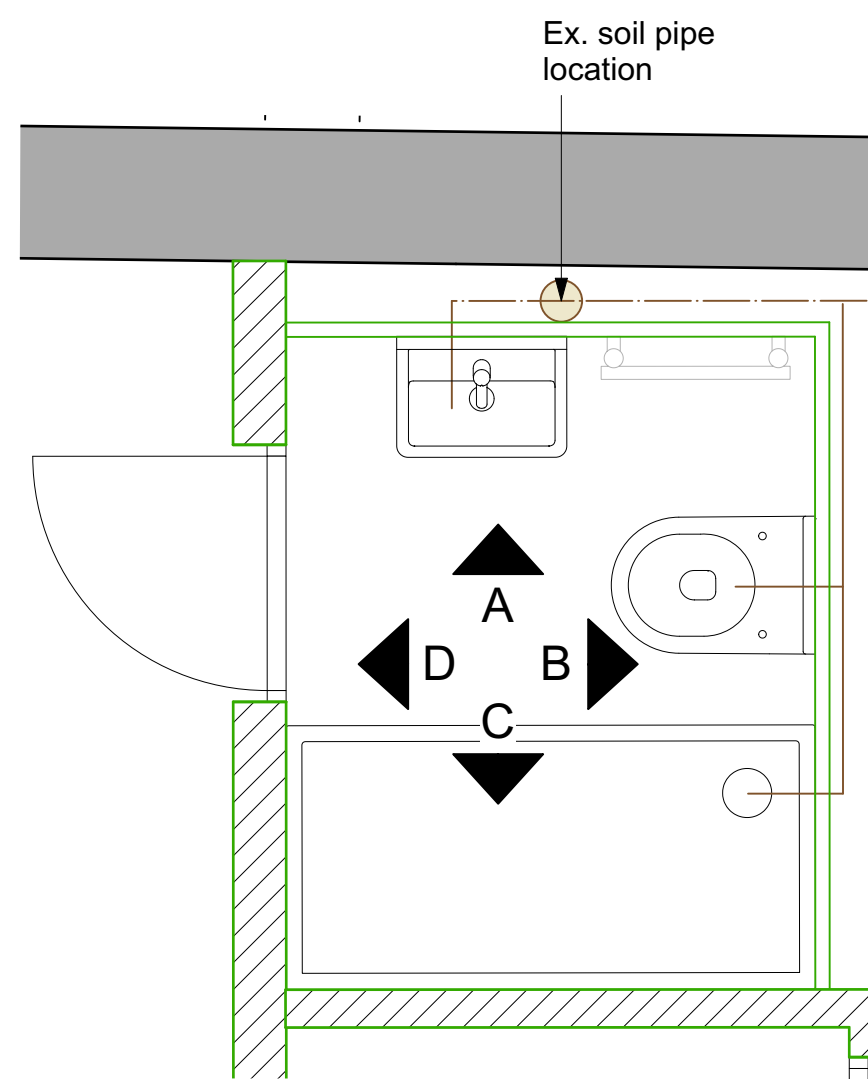

New pipes to run parallel between joists existing notches and pipe runs to be re-used.
Any new notches to be max depth D/8 and min 70mm away from bearing.
Holes at max. \varnothing D/4

Exact position of sink and toilet along walls to be determined with reference to optimising pipework.

1 Shower Room 3rd Floor Plan
1:20

3 Bathroom 3rd Floor Elevations
1:20

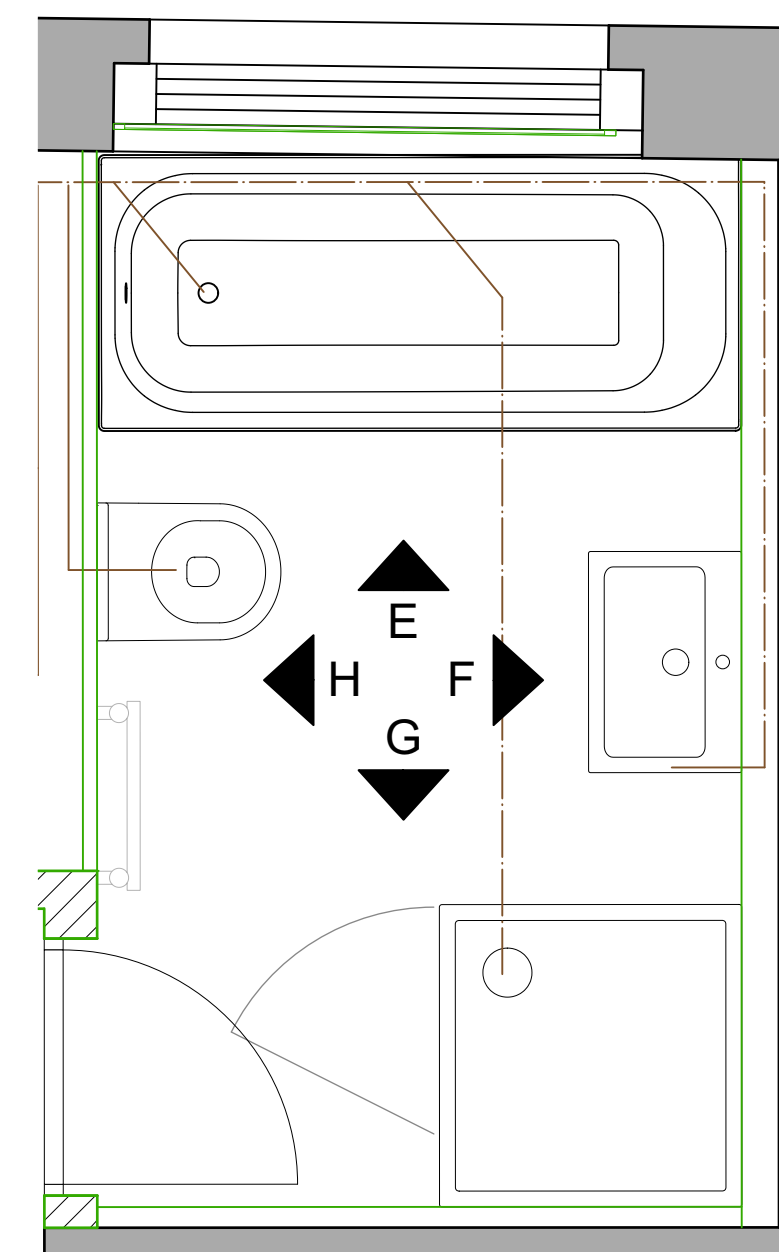

New pipes to run parallel between joists existing notches and pipe runs to be re-used.
Any new notches to be max depth D/8 and min 70mm away from bearing.
Holes at max. \varnothing D/4

Exact position of sink and toilet along walls to be determined with reference to optimising pipework.

4 Bathroom 3rd Floor Plan
1:20

PLANNING APPLICATION AND LBC - AS PROPOSED

structureHaus consulting . engineering . designing		PROJECT REFURBISHMENT OF GRADE 1 LISTED TERRACE 1 CHESTER PLACE LONDON, NW1 4NB		REVISION													
LONDON OFFICE 020 8940 7810 EXETER OFFICE 01392 363497 info@structurehaus.com www.structurehaus.com		CLIENT Mr. + Mrs. Davies DRAWING Bathrooms 3rd Floor		<table border="1"> <tr> <th>REV</th><th>DATE</th><th>DETAILS</th><th>DRAWN</th><th>CHECKED</th><th>REVISION</th></tr> <tr> <td>A</td><td>24.04.25</td><td>Ensuite bathroom, family bathroom W/C and sink swapped</td><td>BM</td><td>DP</td><td></td></tr> </table>		REV	DATE	DETAILS	DRAWN	CHECKED	REVISION	A	24.04.25	Ensuite bathroom, family bathroom W/C and sink swapped	BM	DP	
REV	DATE	DETAILS	DRAWN	CHECKED	REVISION												
A	24.04.25	Ensuite bathroom, family bathroom W/C and sink swapped	BM	DP													
DRAWING NUMBER 02962L		SCALE 1:20		DATE 2025-04-25													
Drawn by Date		Checked by Date		REVISION A													