

The contractor is responsible to ensure that no products are to be utilised that do not comply with relevant British and/or European Standards and/or Codes of Practice, COSHH Regulations, Construction Regulations, or which are known or suspected at the time of product selection and/or construction to be deleterious to health and safety or to the durability of the work or not in accordance with good building practices.

The contractor is responsible for checking dimensions, tolerances, levels and references. This drawing/model is to be read in conjunction with all relevant Other Project Team Members' or specialists' drawings/models/any Federated Model. Any discrepancy is to be notified to Baily Garner LLP and is to be rectified before proceeding with the works on site or shop drawings. Where an item is covered by drawings to different scales, the larger scale drawing is to be worked to.

Any rights (including copyright) in this drawing/model and any proprietary work contained therein belong to Baily Garner LLP and may only be used in accordance with the licence granted to the Employer and with attribution to Baily Garner LLP.

The drawing to be read in conjunction with: Document Suitability Codes page or at www.bailygarner.co.uk/disclaimer/

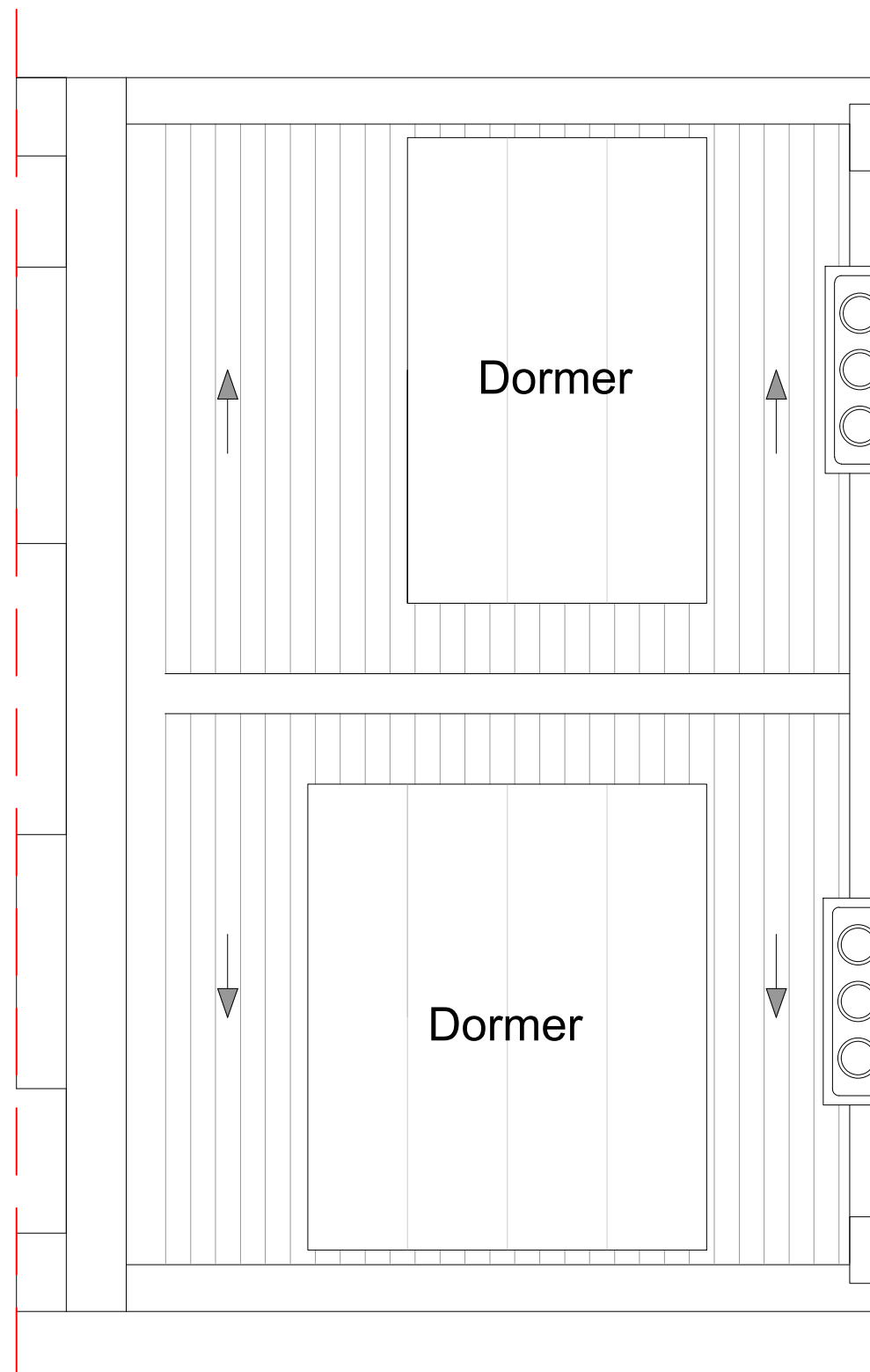

Roof Plan

SCALE BAR 1:50

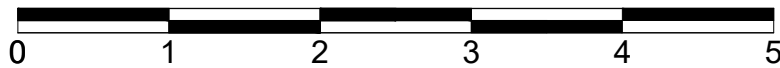

17 Northington Street, London, WC1N 2NR

Existing Roof Plan

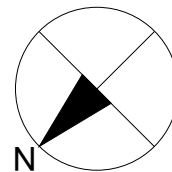

CLIENT NAME LB of Camden				PROJECT NAME Retrofit Assessments			
PROJECT ADDRESS 17 Northington Street London WC1N 2NR				DRAWING TITLE Existing Roof Plan			
SCALE 1:50@A3				SUITABILITY CODE Tender			
DRAWN AO	APPROVED B.LR	APPROVED B.LR	DATE 03/2025				
PRJNO 35121	AUTHOR BG	VOLUME 01	LEVEL ---	DOCTYP ---	ROLE D	DRAWING P1004	REV STAT ---
						REV NO 01	



LONDON HEAD OFFICE
146-148 ELTHAM HILL
LONDON SE9 5DY
t. 020 8294 1000
e. general@bailygarner.co.uk