

The contractor is responsible to ensure that no products are to be utilised that do not comply with relevant British and/or European Standards and/or Codes of Practice, COSHH Regulations, Construction Regulations, or which are known or suspected at the time of product selection and/or construction to be deleterious to health and safety or to the durability of the work or not in accordance with good building practices.

The contractor is responsible for checking dimensions, tolerances, levels and references. This drawing/model is to be read in conjunction with all relevant Other Project Team Members' or specialists' drawings/models/any Federated Model. Any discrepancy is to be notified to Baily Garner LLP and is to be rectified before proceeding with the works on site or shop drawings. Where an item is covered by drawings to different scales, the larger scale drawing is to be worked to.

Any rights (including copyright) in this drawing/model and any proprietary work contained therein belong to Baily Garner LLP and may only be used in accordance with the licence granted to the Employer and with attribution to Baily Garner LLP.

The drawing to be read in conjunction with: Document Suitability Codes page or at [www.bailygarner.co.uk/disclaimer/](http://www.bailygarner.co.uk/disclaimer/)

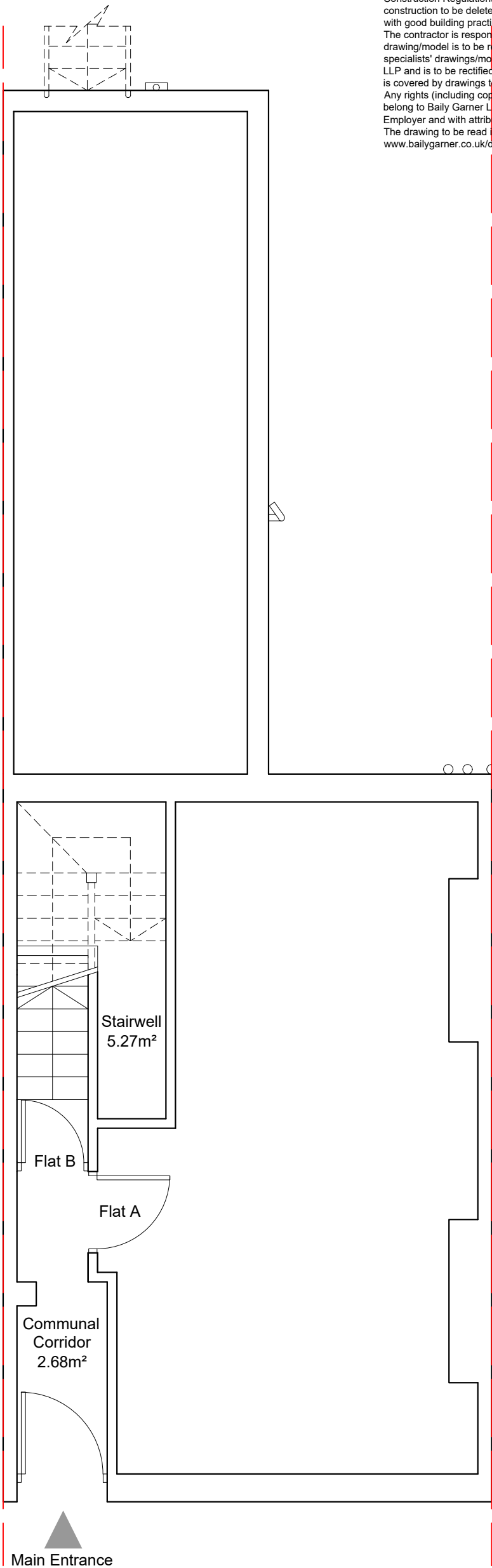

Ground Floor

SCALE BAR 1:50



Flat B, 168 Grafton Road, NW5 4BA

Proposed Ground Floor Plan

CLIENT NAME				PROJECT NAME			
LB of Camden				Retrofit Assessments			
PROJECT ADDRESS				DRAWING TITLE			
Flat B, 168 Grafton Road				Proposed Ground Floor Plan			
London				SUITABILITY CODE			
NW5 4BA				Tender			
SCALE		DRAWN		CHECKED		APPROVED	
1:50@A3		AO		B.L.R		B.L.R	
DRWNO	AUTHOR	VOLUME	LEVEL	DOCTYP	ROLE	DRWNO	REVNO
35121	BG	01	---	---	D	P106	01



LONDON HEAD OFFICE  
146-148 ELTHAM HILL  
LONDON SE9 5DY  
t. 020 8294 1000  
e. [general@bailygarner.co.uk](mailto:general@bailygarner.co.uk)