

The contractor is responsible to ensure that no products are to be utilised that do not comply with relevant British and/or European Standards and/or Codes of Practice, COSHH Regulations, Construction Regulations, or which are known or suspected at the time of product selection and/or construction to be deleterious to health and safety or to the durability of the work or not in accordance with good building practices.

The contractor is responsible for checking dimensions, tolerances, levels and references. This drawing/model is to be read in conjunction with all relevant Other Project Team Members' or specialists' drawings/models/any Federated Model. Any discrepancy is to be notified to Baily Garner LLP and is to be rectified before proceeding with the works on site or shop drawings. Where an item is covered by drawings to different scales, the larger scale drawing is to be worked to.

Any rights (including copyright) in this drawing/model and any proprietary work contained therein belong to Baily Garner LLP and may only be used in accordance with the licence granted to the Employer and with attribution to Baily Garner LLP.

The drawing to be read in conjunction with: Document Suitability Codes page or at [www.bailygarner.co.uk/disclaimer/](http://www.bailygarner.co.uk/disclaimer/)

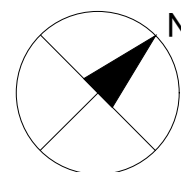
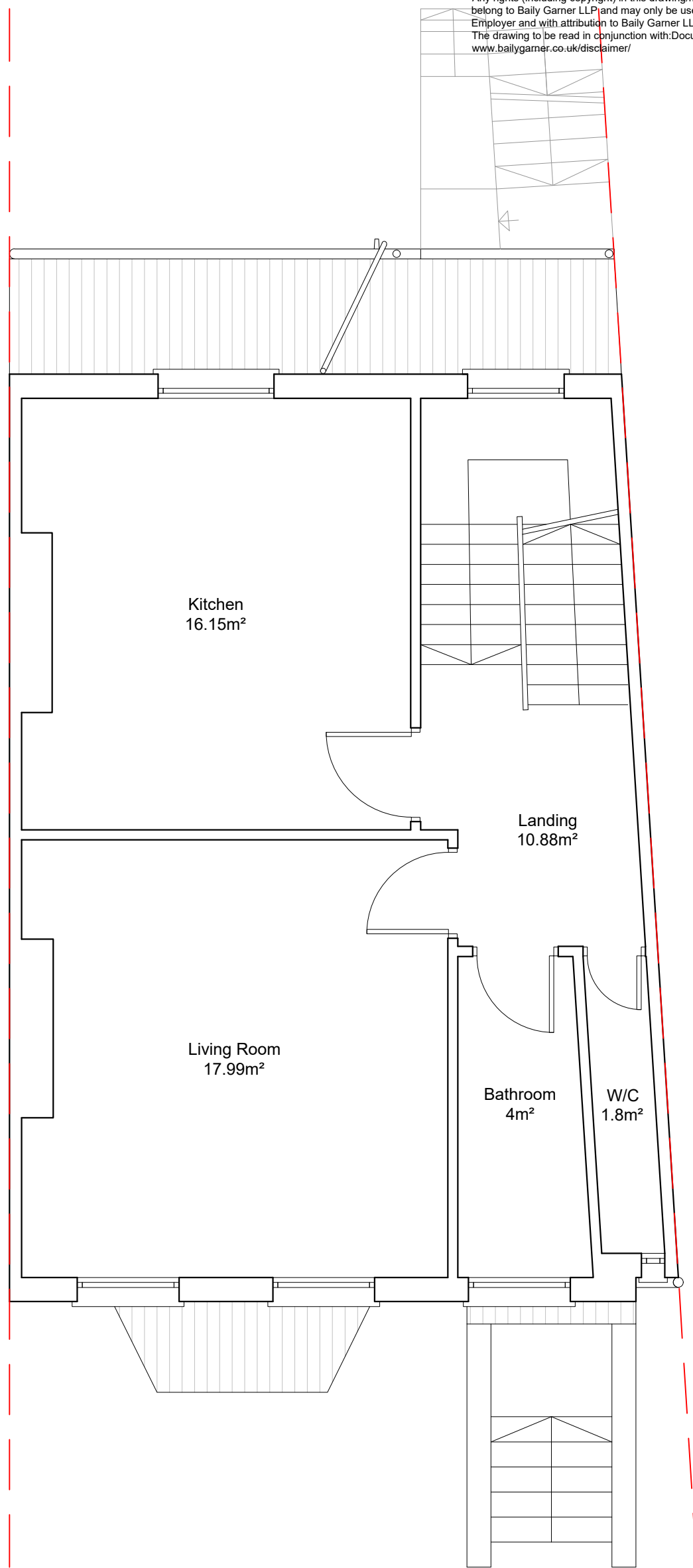

SCALE BAR 1:50



First Floor

# Flat B 25 Oseney Crescent, NW5 2AT

## Existing First Floor Plan

CLIENT NAME  
LB of CamdenPROJECT NAME  
Retrofit AssessmentsPROJECT ADDRESS  
Flat B 25 Oseney Crescent  
London  
NW5 2ATDRAWING TITLE  
Existing First Floor PlanSUITABILITY CODE  
TenderSCALE  
1:50@A3DRAWN  
AOCHECKED  
BLRAPPROVED  
BLRDATE  
03/2025PROJ NO  
35121AUTHOR  
BGVOLUME  
01LEVEL  
---DOCTYP  
---ROLE  
DDRW NO  
P8004REV STAT  
---REV NO  
01LONDON HEAD OFFICE  
146-148 ELTHAM HILL  
LONDON SE9 5DY  
t. 020 8294 1000  
e. general@bailygarner.co.uk