

- Access to library reception for staff via step immediately behind door.
- Existing raised floor behind desk means staff are at a higher level
- Timber joinery unit houses control equipment for entrance gates.
- Existing hardwood veneer timber panelling and door
- Existing timber shelving
- Existing hardwood veneer timber panel. (Note that the end panel slides to secure the reception area.)
- Existing hardwood veneer timber panels.
- Existing hardwood timber desk joinery with built in storage shelves.
- Existing roller shutter and hardwood vertical guide rail.
- Existing distribution boards recessed into wall at high level
- Existing DDA access pass gate currently opens in the wrong direction, impeding access in front of the reception desk.
- Existing library anti-theft detector gates.
- Existing entrance control speed gates. (Not DDA Compliant)

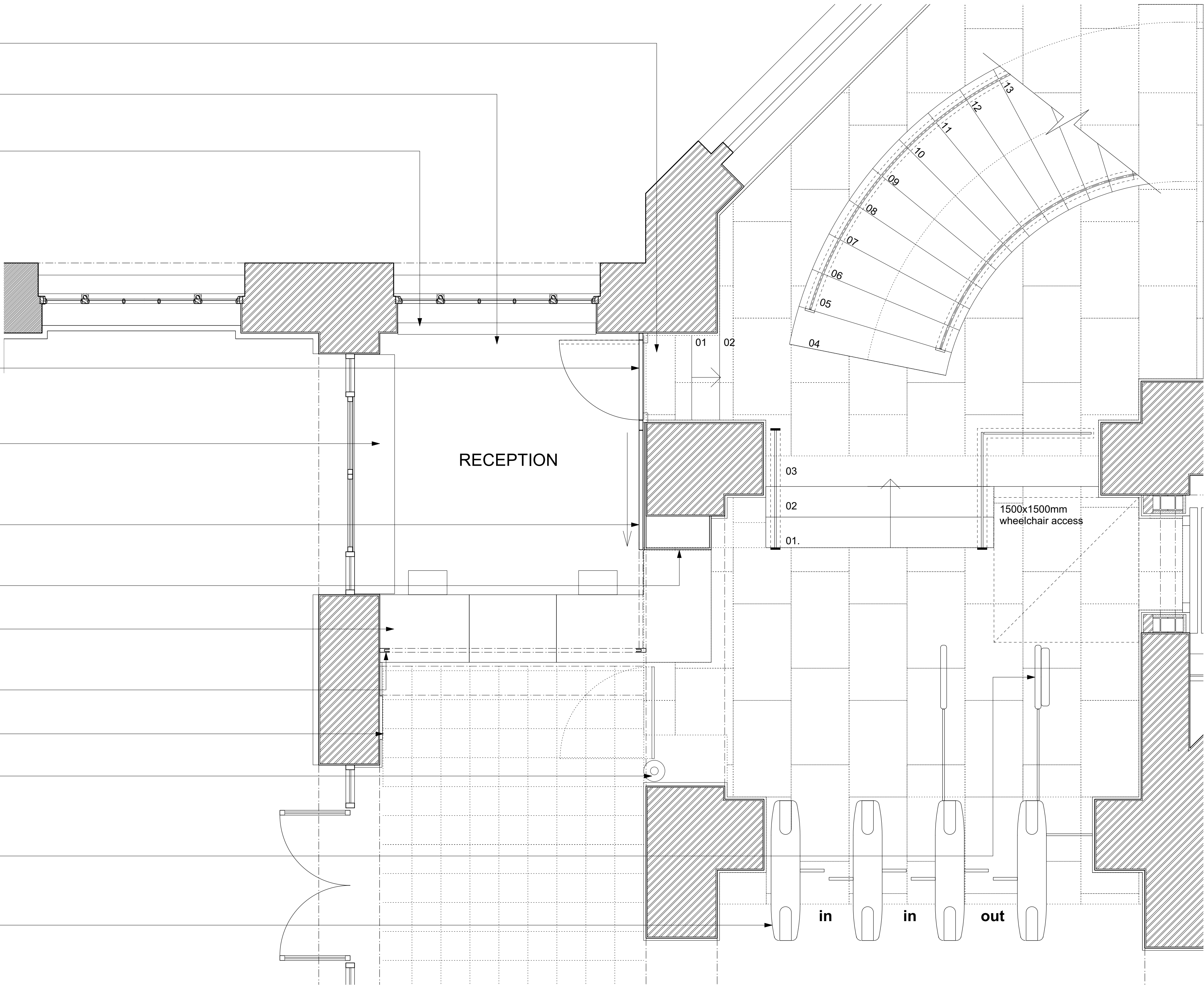

1 Existing Floor Plan
1:25 @ A1 / 150 @ A3

Date	Rev	By	Issue Notes
02/04/2025	P1	TB	Issue for Listed Building Consent

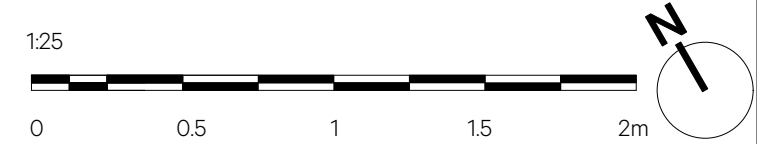

NO DIMENSIONS ARE TO BE SCALED FROM THIS DRAWING. THE CONTRACTOR/MANUFACTURER IS RESPONSIBLE FOR CHECKING ALL DIMENSIONS AND QUERYING ANY DISCREPANCIES. THIS DRAWING IS THE PROPERTY OF BURWELL ARCHITECTS LTD. COPYRIGHT IS RESERVED BY THEM AND THE DRAWING IS ISSUED ON THE CONDITION THAT IT IS NOT COPIED, REPRODUCED, RETAINED OR DISCLOSED TO ANY UNAUTHORISED PERSON, EITHER WHOLLY OR IN PART, WITHOUT WRITTEN CONSENT.

Burwell Architects
Address
Unit 0.01 California Building
Deals Gateway
London SE13 7SB
020 8305 6010
info@burwellarchitects.com
www.burwellarchitects.com

Client
UCL

Project Title
Wilkins Building Library Entrance

Sheet Title
Wilkins Building Library Entrance - Existing Floor Plan

CAD File Name
997-GA Drawings.vwx

Checked By SP	Project No 997
Drawn By TB	Scale 1:25
Date March 2025	Sheet No. 997-P-0010
Revision P1	