

LEVEL MONITORING

for SMS (AVI, PRE)

Garden Flat/Flat B, 7 Camden Terrace, London, NW1 9BP

Client:	SMS (AVI, PRE)
Client Contact:	[REDACTED]
Claim Number:	[REDACTED]
Client Reference:	IFS-AVI-SUB-22-0102275
Policy Holder:	7 Camden Terrace Freehold Ltd
Report Date:	18 March 2025
Our Ref:	M23459



Level Monitoring Readings

The following table shows the reading levels of the various Level Monitoring Station points.

Date	1	2	3	4	5	6	7	8	9	10
18/11/2024	10.0000	10.0201	10.0190	9.9668	10.5358	11.1274	11.1450	11.1189	11.2634	10.7141
24/01/2025	10.0000	10.0200	10.0203	9.9678	10.5371	11.1277	11.1451	11.1191	11.2619	10.7136
14/03/2025	10.0000	10.0206	10.0199	9.9690	10.5374	11.1326	11.1494	11.1232	11.2634	10.7155

Date	11	12	13
18/11/2024	10.6939	10.6848	10.7108
24/01/2025	10.6935	10.6852	10.7104
14/03/2025	10.6950	10.6870	10.7123

Level Monitoring Difference Graphs

The following graphs display the progressive movement that each Level Monitoring Station recorded at each separate site visit date to give an overall look at how much the property is moving.

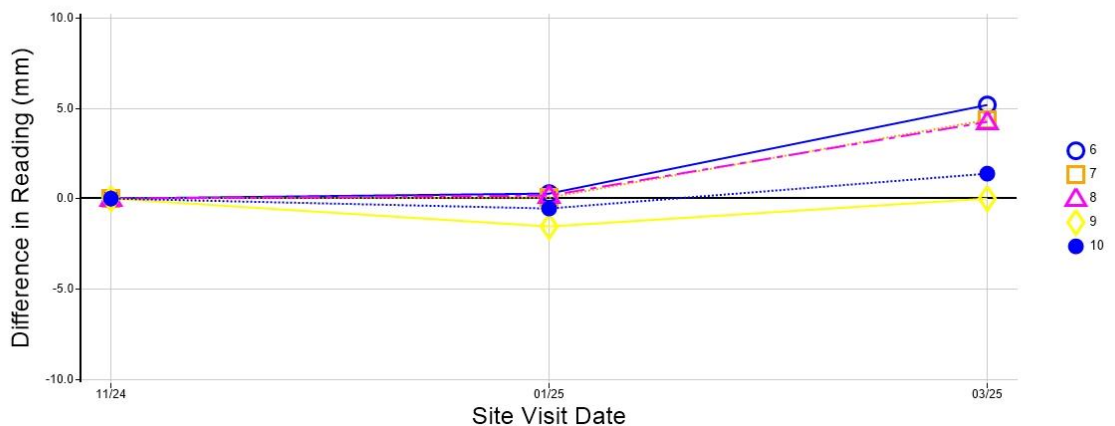
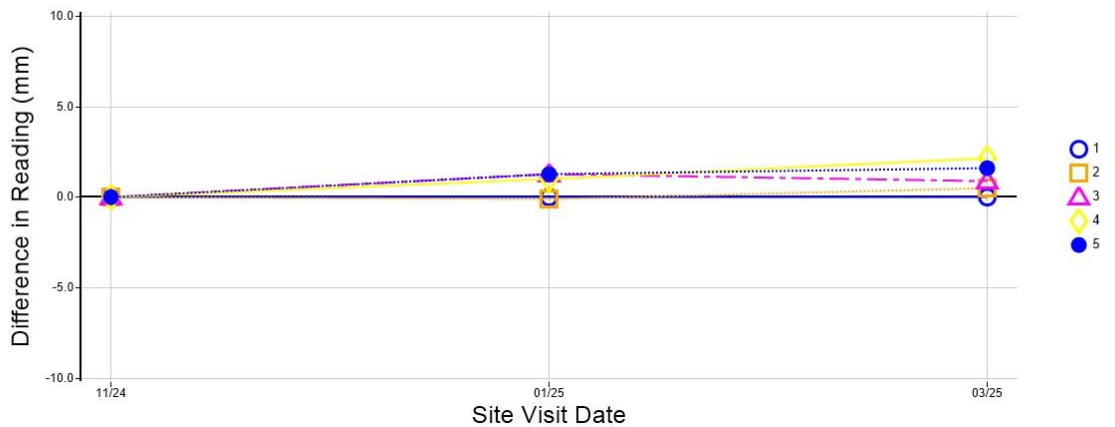



Level Monitoring Displacement Map

The following image shows an isometric representation of the movement of the property, based on the Level Monitoring Stations that were installed.

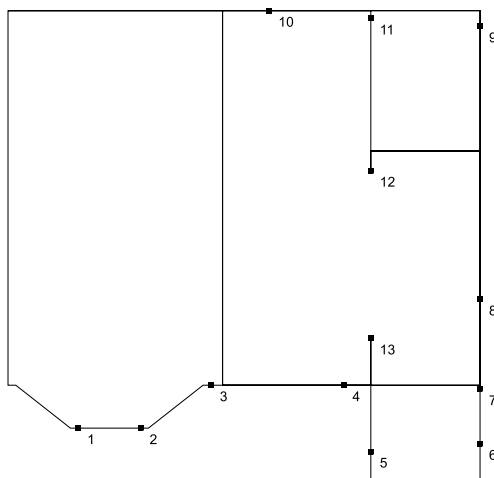
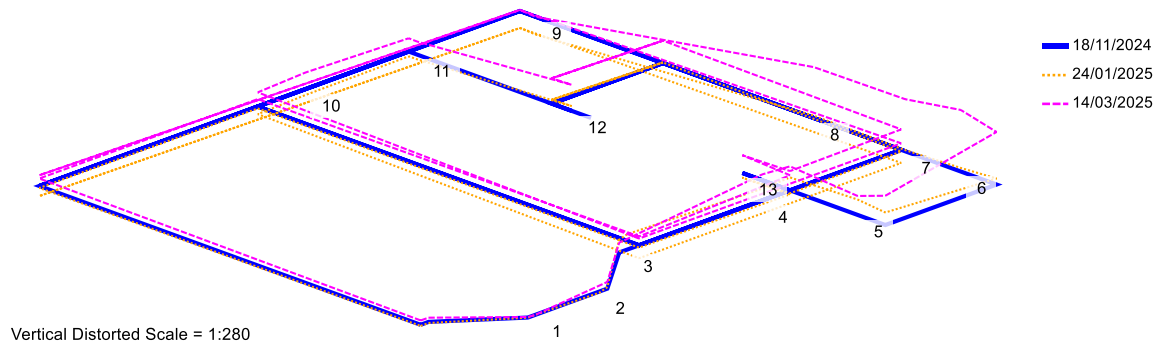

Site Visit Notes

TBM is point 1 on the front of the property, it has an assumed value of 10.0000, please advise if a DD is required.