



DETAILED LUMINAIRE SCHEDULE

PROJECT:	THE BRUNSWICK CENTER FESTOONS
REFERENCE:	0210-SC2
CLIENT:	LAZARI INVESTMENTS
DATE:	21 ST MARCH 2025
REVISION:	-

DETAILED LUMINAIRE SCHEDULE

the language of light

Project: The Brunswick Centre
Reference: 0210

1. GENERAL CONDITIONS

- 1.1 The specification sheets indicating the lighting design requirements for specific areas within this project form part of this document and should be read in conjunction with this preamble and the Lighting Consultant's relevant drawings, and associated sketches.
- 1.2 This specification supersedes all previous issues.
- 1.3 All quantities shall be checked against the construction drawings.
- 1.4 All luminaires fixed to Portland stone or similar should be resin fixed.

2 SAMPLES & PROTOTYPES

- 2.1 All lighting equipment shall be currently available – working samples will be required for submission and are to be approved by the Client/Architect.
- 2.2 Should a sample of a standard, or prototype of a special luminaire or variant of a standard luminaire be ordered, its cost shall either be incorporated in a tender price, or shall be invoiced to the Client or his nominated representative separately, as agreed.
- 2.3 Any such sample prototype or variant shall comply with the lighting design specification, and shall be submitted to the Lighting Consultant, together with full photometric and dimensional data if specifically requested, to enable both its accurate assessment and the detailing of any adjustments deemed necessary prior to the commencement of full production.

3 STANDARDS COMPLIANCE

- 3.1 For projects in the United Kingdom, all equipment supplied shall comply with the relevant BS, EN and IEC requirements, and be capable of installation in accordance with the manufacturers' instructions, the current edition of the IEE Wiring Regulations and all statutory and local authority requirements. Standards requirements particular to individual luminaire types are indicated on the relevant specification sheet.
- 3.2 Notwithstanding the above, the following British Standards in particular should be checked for compliance:
 - BS 559 Electric signs and high voltage luminous discharge tube installations.
 - BS 3535 Safety isolating transformers for industrial and domestic purposes.
 - BS 4533 Luminaires.
- 3.3 For projects outside the United Kingdom, all equipment supplied shall comply with the relevant standards currently in force in the project's country of origin.
- 3.4 The cost of obtaining any necessary approvals shall be included in any tender price, detailed as a separate item.

DETAILED LUMINAIRE SCHEDULE

the language of light

Project: The Brunswick Centre
Reference: 0210

4 PROTECTION

- 4.1 All equipment shall be supplied with adequate means of protection to ensure its preservation during transport to site and any subsequent storage prior to installation.
- 4.2 All vulnerable finished parts liable to scratching or other abrasion during handling and installation shall be further protected by a removable film applied prior to dispatch.

5. TECHNICAL REQUIREMENTS

5.1 Luminaires

- 5.1.1 Equipment selected as a standard item from a particular manufacturer's range has been specified with a view to performance, optics, maintenance, quality, aesthetics, etc.
- 5.1.2 Should alternative equipment be offered, full technical and photometric data shall be submitted to Studio29 Ltd in time to enable its accurate assessment. If any variants of standard luminaires are required, these shall be developed by the manufacturer of the standard luminaire, unless otherwise specifically stated, and shall be manufactured to the same standards as the equivalent standard luminaire.
- 5.1.3 If specified, two copies of all working drawings of proposed variants dimensioned in millimetres shall be supplied to Studio29 Ltd for approval prior to fabrication.
- 5.1.4 Notwithstanding the above, the manufacturer shall remain responsible for ensuring compliance with relevant standards, the accuracy of the information shown on his drawings at all times and for ensuring that the equipment shown fulfils the requirements of this specification.
- 5.1.5 Studio29 Ltd cannot accept responsibility for the installation of non-approved luminaires.
- 5.1.6 The final location of each luminaire and, where relevant, its integration with the architecture shall be as detailed on the construction issue drawings. Studio29 Ltd cannot accept responsibility for luminaires installed in a manner other than indicated in the relevant drawings or as otherwise agreed and minuted.

5.2 Control Gear

- 5.2.1 All necessary control gear and transformers shall be mounted within the luminaire unless shown as being located remote or adjacent. All such gear shall be of good quality construction, shall comply with all relevant statutory regulations, shall be compatible with the lamps specified, and shall be mounted and wired in accordance with the manufacturers' instructions.
- 5.2.2 Where appropriate, the luminaire manufacturer shall ensure compatibility between control gear and the proposed control system. The manufacturer shall also provide all necessary data regarding gear losses, etc. to enable dimmers / contactors to be sized correctly.
- 5.2.3 Transformers shall have a stable output voltage of 11.8V / 22.8V, under varying loads, where the output voltage is nominally quoted at 12V / 24V.
- 5.2.4 Unless otherwise stated, all transformers shall be suitable for dimming on their primary side via a thyristor controlled remote lighting control system.

DETAILED LUMINAIRE SCHEDULE

the language of light

Project: The Brunswick Centre
Reference: 0210

- 5.2.5 Where gear or transformers are installed remotely, care should be taken to ensure that any audible sounds generated by control gear, or by lamp filaments via control gear are kept to a minimum. Where this is particularly crucial, detailed acoustic requirements are included in the Specific Conditions.
- 5.2.6 All equipment shall be protected from unexpected mains failure, and mains borne interference.
- 5.2.7 Electrical supply connections shall be designed to facilitate the easy installation of the luminaires. The supplier shall liaise with the Electrical Engineer to ensure any specific requirements of his in this respect are met.
- 5.3 Lamps
 - 5.3.1 The following lamp manufacturers are approved;
General Electric; Osram Sylvania; Philips; Venture; and BLV.
 - 5.3.2 Incandescent and tungsten halogen lamps shall not be operated, other than for initial testing, prior to final inspection.
 - 5.3.3 Should alternative lamps be offered, these shall require the approval of Studio29 Ltd except where noted below, provided particular attention is paid to colour rendering, colour temperature, light distribution, life expectancy and general performance when selecting such alternatives.
 - 5.3.4 Allowance shall be made for the specialised installation of lighting as required (ie cold cathode). Such installation may require the services of a specialise sub contractor
 - 5.3.5 Studio29 Ltd recommends that a lamp recycling/disposal regime be assessed by the client/building operator prior to completion of the project. Services provided by various lamp recycling contractors vary and the suitability for a particular project and the completeness of their recycling processes should be assessed by the operator.

Disposal of twenty fluorescent, or metal halide, lamps or greater is considered hazardous waste disposal and must be carried out at a licensed landfill site or through a licensed recycling company.

Recommended lamp recycling contractors include but are not limited to:

DETAILED LUMINAIRE SCHEDULE

the language of light

Project: The Brunswick Centre
Reference: 0210

LUMINAIRE REF:	FT
Manufacturer:	Lumisphere Products Ltd
Tel:	Office: 01751 411 942
Contact:	Ben Davies
	Mobile: 07546 483414
	Email: Ben@Lumisphere.co.uk
Location:	Throughout the Mall
Cat. Reference:	ORBICAL 360/8 LED FESTOON WITH 'G' TYPE CLEAR GLOBE + CATENARY CABLES & FIXINGS
Description:	Festoon lighting mounted to catenary cables / 3000K/ IP68
Dimensions:	60mm diameter
	90mm height
	15300mm (to be site verified) length of each catenary span
Accessories:	Globe Sheild Snap on Hangers
Control Gear:	Remote drivers by Lumisphere
Colour:	Black/ Stainless Steel
CDM/H&S:	-
Notes:	<ul style="list-style-type: none"> - Drivers to be discreetly located in dry, well ventilated, accessible area per contractor - All measurements to be site verified before procurement - 500mm centres - Lumisphere products Ltd to provide festoons and canopy with all fittings and components for mounting
Circuit Wattage:	1W per LED 'lamp'
Voltage:	12V
Beam Angle:	N/A
Colour Kelvin:	3000K
Luminous Flux:	-
CRI (Ra)	80

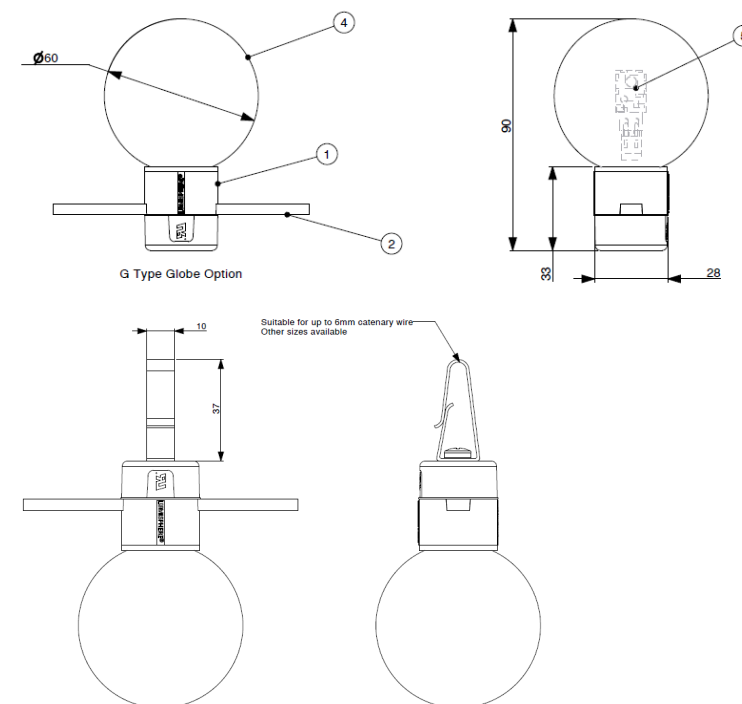
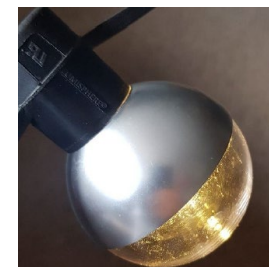



The Landing
Tileman House
131 Upper Richmond Rd
London
SW15 2TL

+44 (0)20 8780 9006
info@studio29lighting.com

www.studio29lighting.com