

BLOCK PLAN

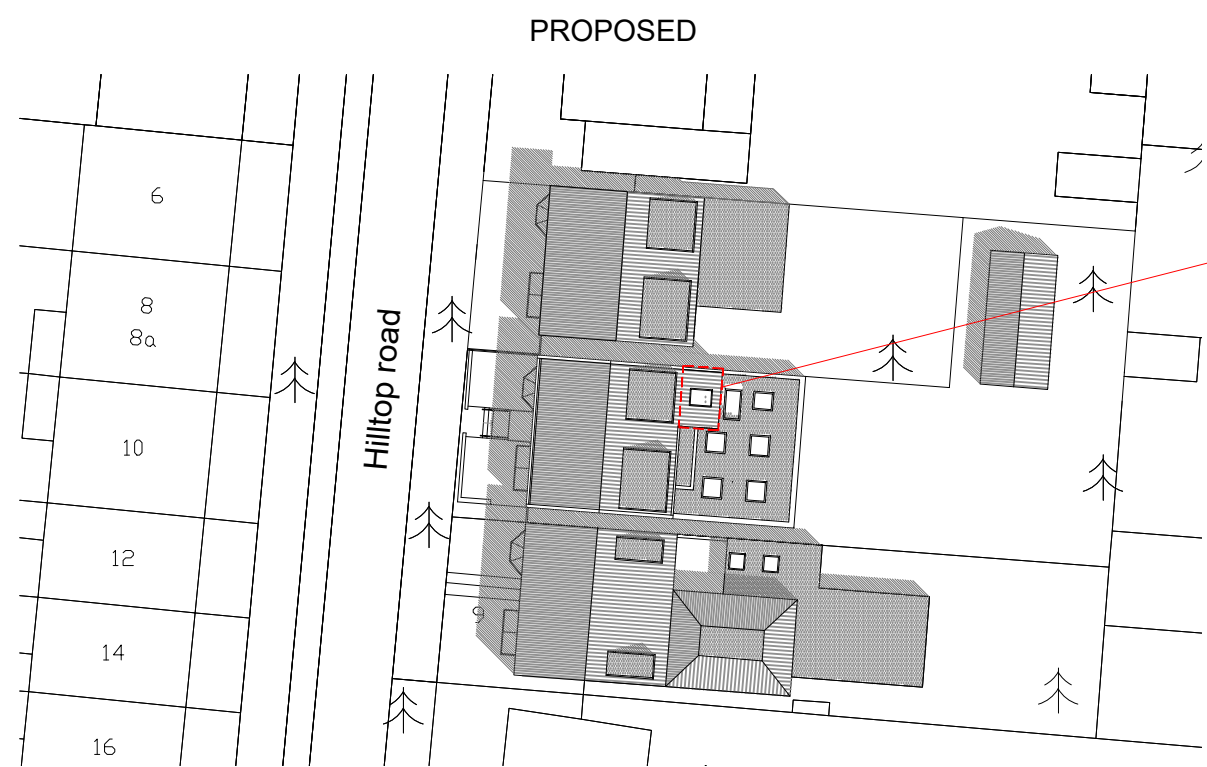

PROPOSED
EXTENSION

Do not scale this drawing. All drawings are to be read in conjunction with a Measured Survey. Any discrepancies between these documents shall be brought to the attention of the architect. Drawings as instruments of service remain the property of architect and are protected under common law copyright provisions.

Rev
00

Date
MAR 2025

Orientation

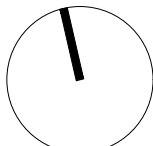

NORTH

SCALE BAR 1:500



Romeo Architects

Unit 408, Screenworks,
22 Highbury Grove, London, N5 2ER
Phone: +44 7599 863 122
www.romeoarchitects.com
studio@romeoarchitects.com

Project title: Proposed first floor extension to the rear of 7 Hilltop Road, London NW62QA

Drawing title: PROPOSED BLOCK PLAN

Client: DE

Scale: 1:500 @A3

Dwg no: PA_080_02

Date: 03/2025