

Notes

- Neighbouring buildings
- Existing townhouse
- Part of single storey volume to be demolished
- Extent of remaining single storey volume

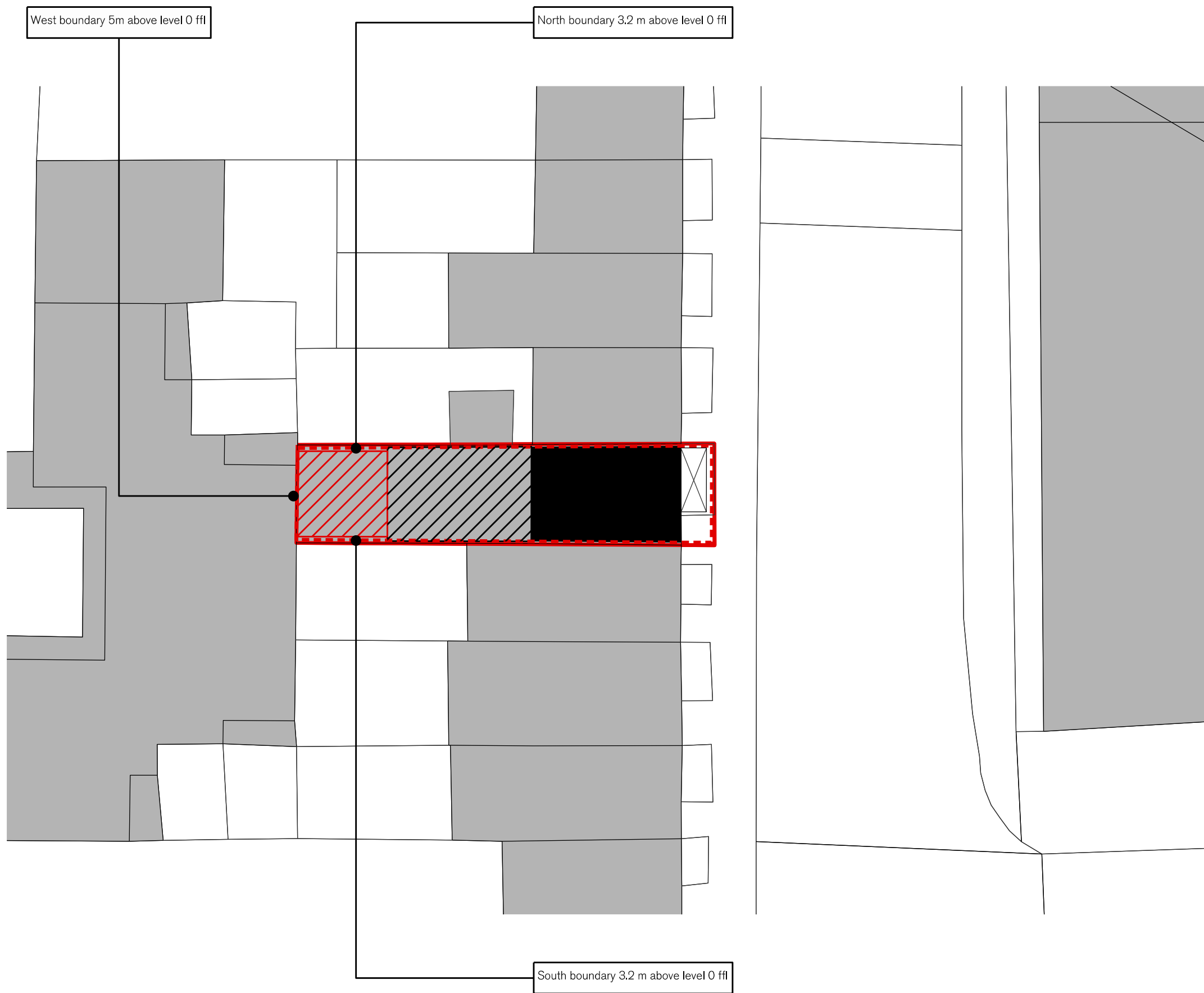

02

Block plan - Existing
1:200

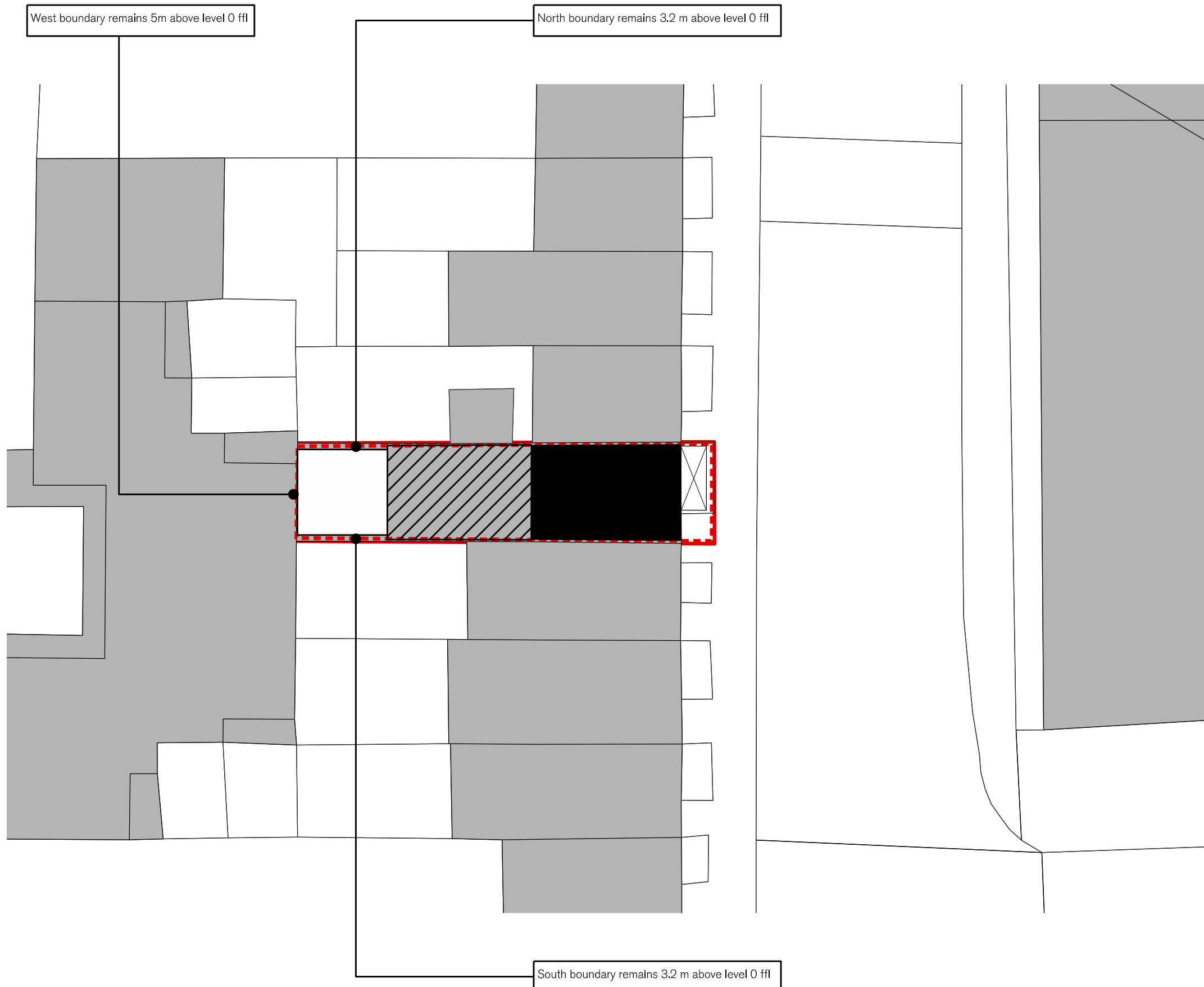

03

Block plan - proposed
1:200

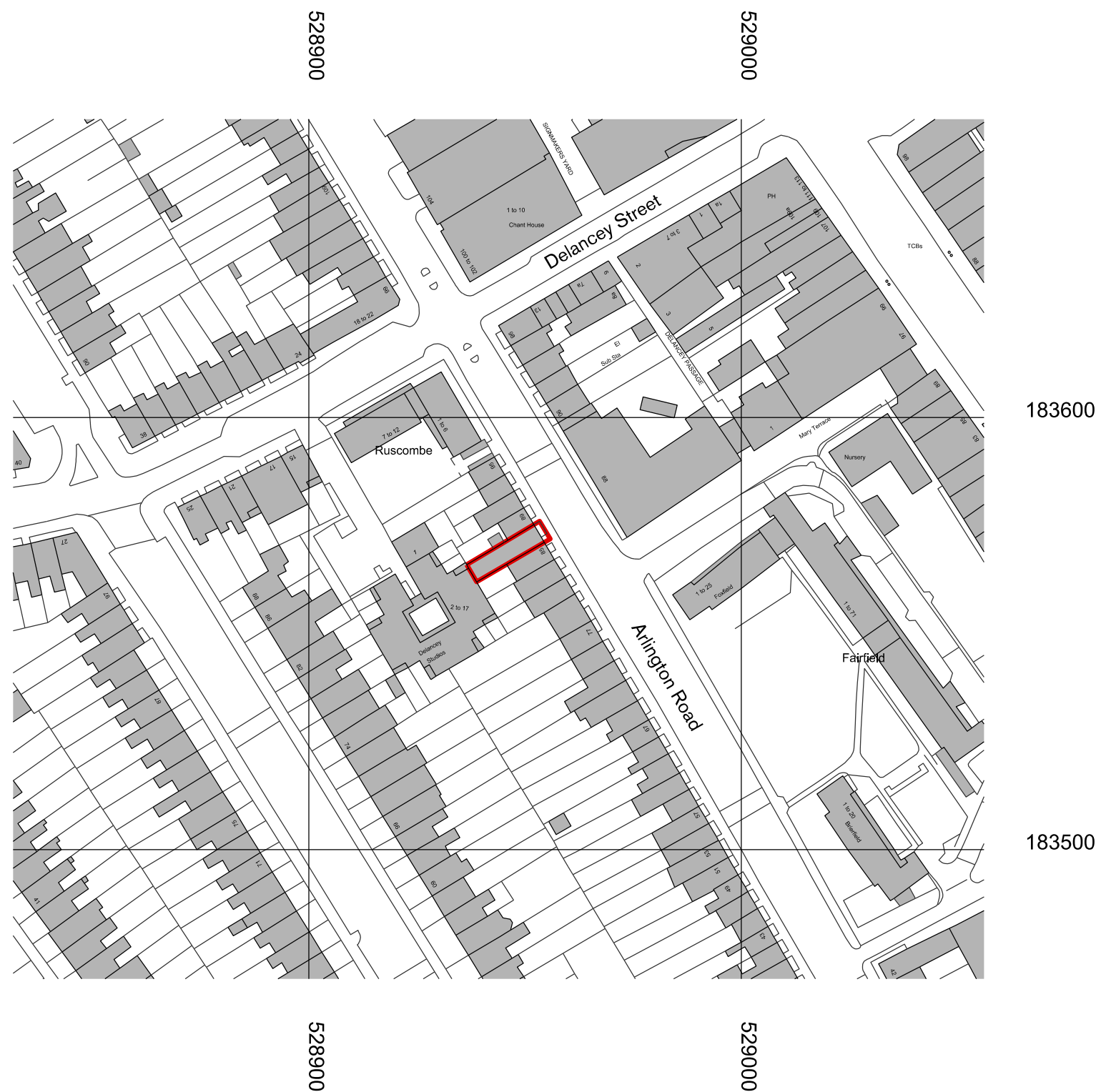

01

Location plan - 87 Arlington Road
1:1250

20 50 100

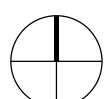

2 5 10



H
H-W

Project no.
021
Project
87 Arlington Road
Client
Mrs H. Charles & Mr D. Cash

Drawing name
Location Plan
Block plans-
Existing and proposed

Drawing number
00_00_P

Revision
00
Date
31/03/2025

www.hillharveywood.com