

1 External window elevation
1:10

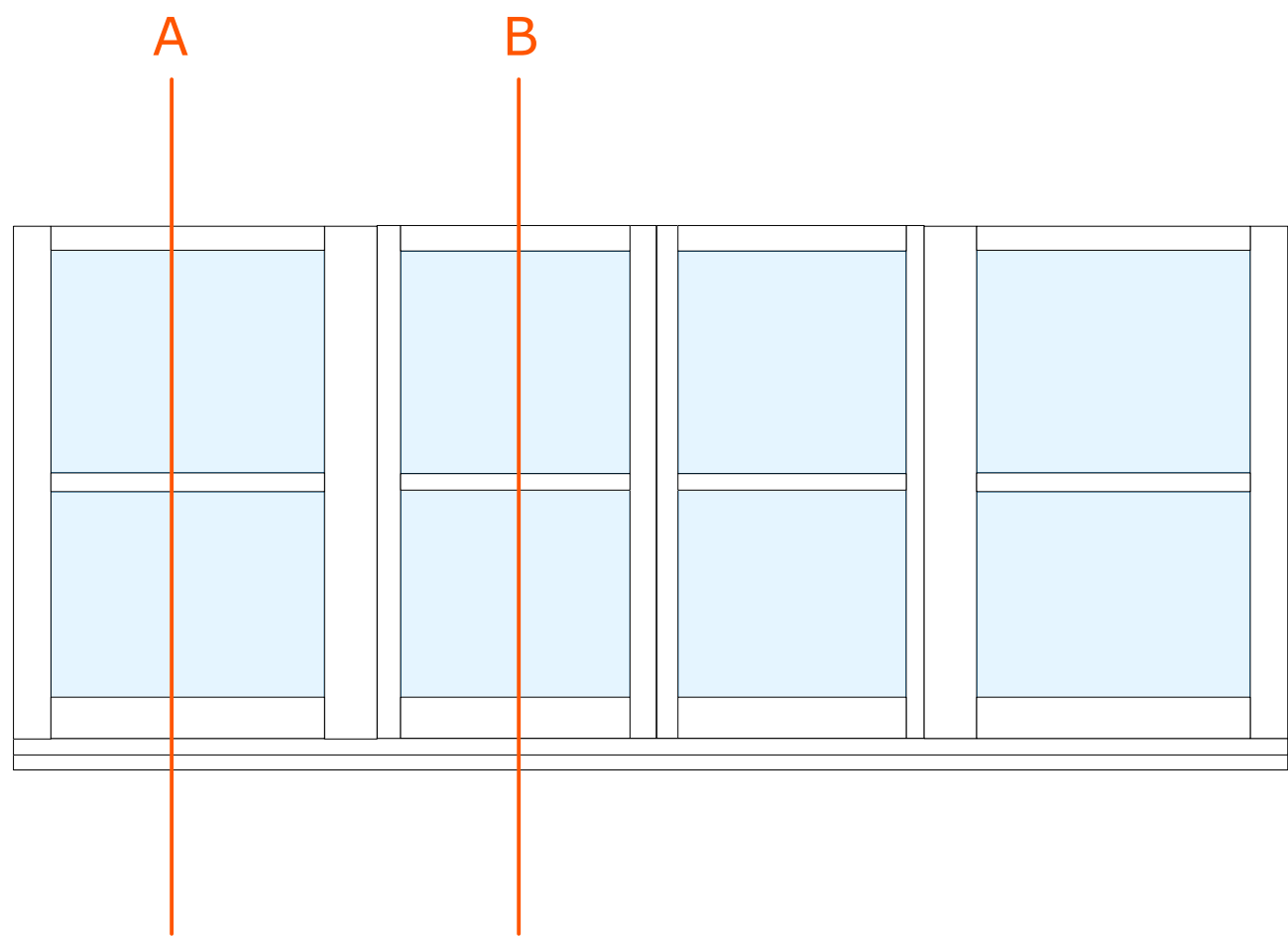

2 Internal window elevation & plan
1:10

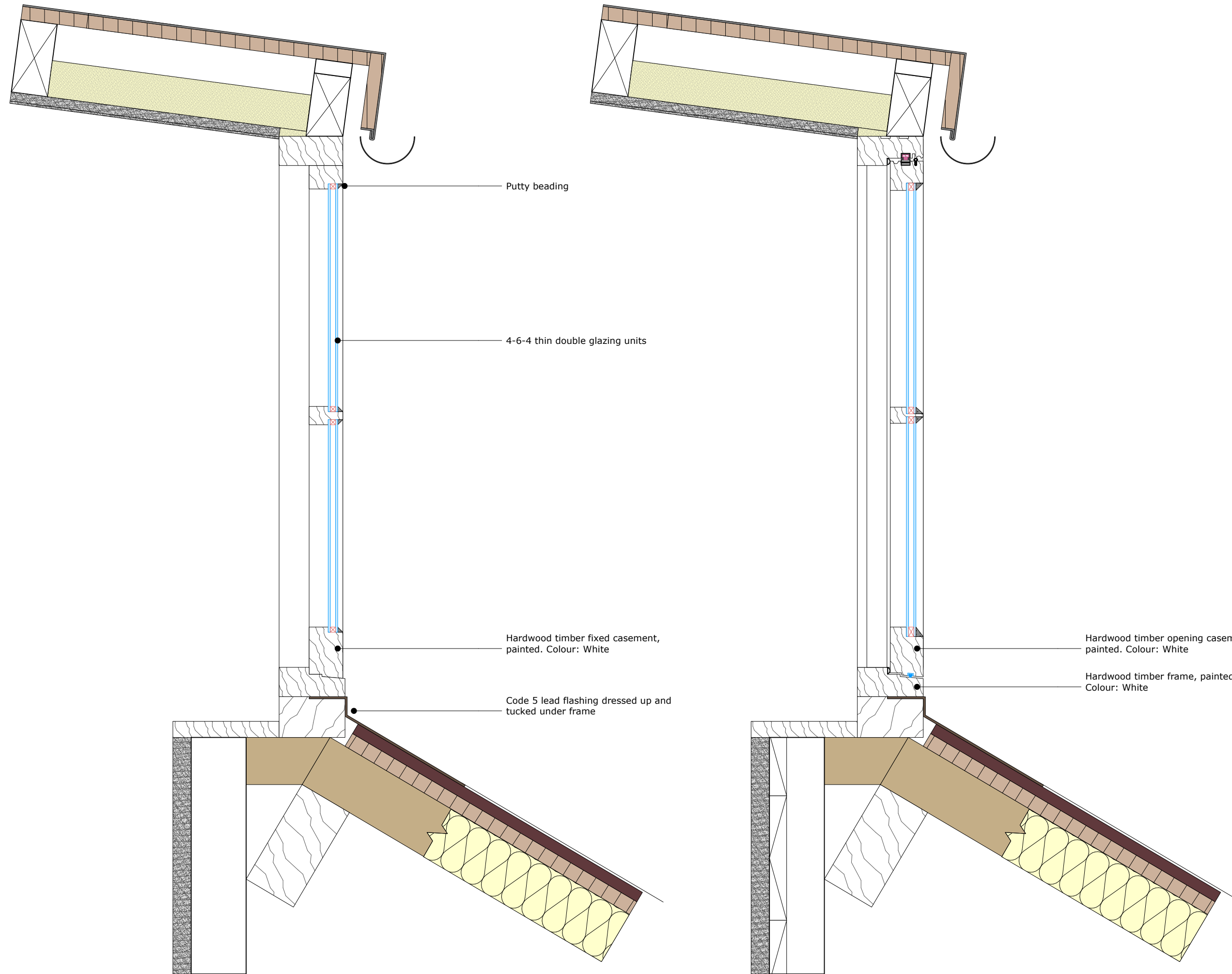
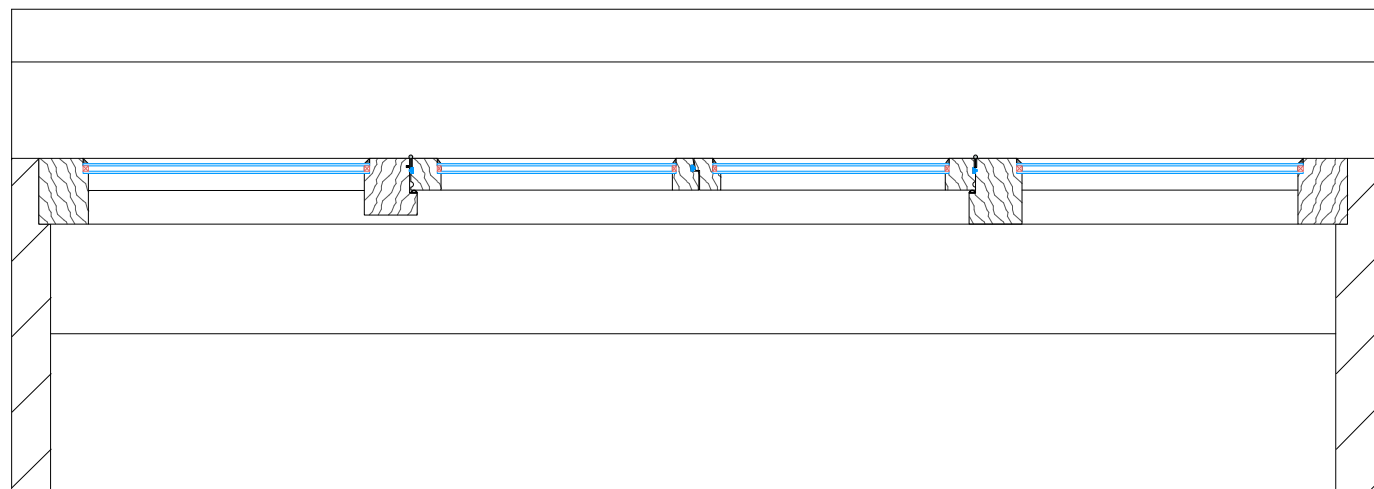

3 Section A
1:5

4 Section B
1:5

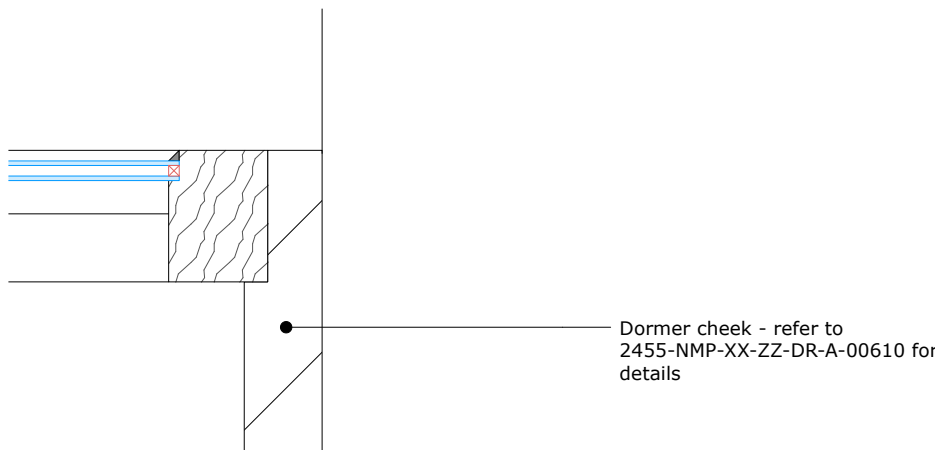
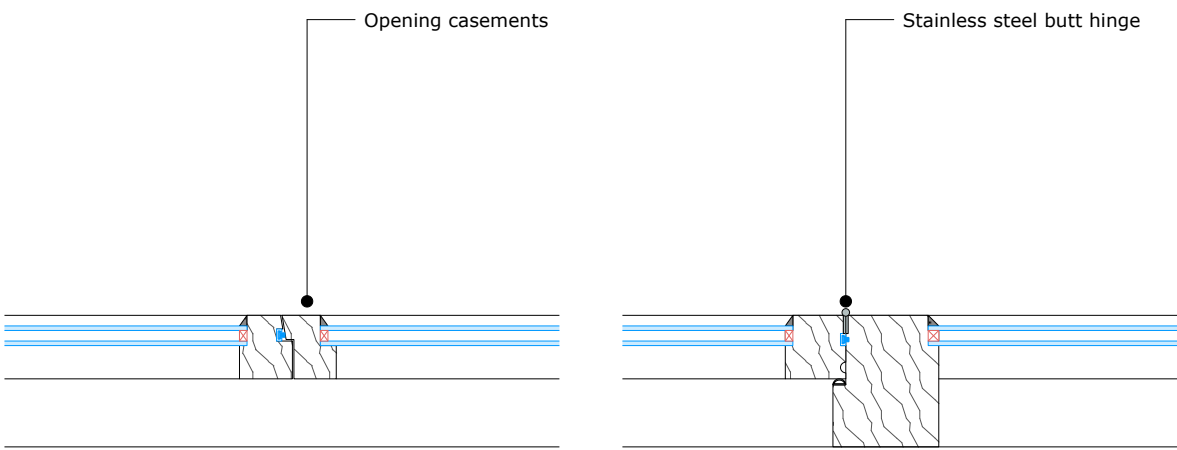

5 [Drawing Title]
1:5

Notes
Existing rafter spacing taken to be 380mm based on sample measurements taken during opening up works.
Position of rafters assumed to align with existing dormer.
Opening up works undertaken at No.4, similar arrangement of rafters assumed at No.6.