

Tree Tag: LZ01168**Stems:** 1**Species:** Ulmus sp (Elm)**Site:** LZ 25 - St. Mark's Bridge**Location:** London Zoo**Grid Ref:** TQ 28256 83667**Owner:** The Royal Parks

Inspection: 02/05/2023**Height:** 1.5-7.0 metres**Age:** Semi-mature**Trunk:** 85 mm**Spread:** 3 to 6 meters**Features:****Conditions:** Bark wounding - rubbing limb
from adjacent elm
Leaning tree**Comments:****Visited By: AC****Failure:** Likely/Foresee**Target:** Very High**Impact:** Small <10**Authority:** Camden**Recommendations:** Remove branch as specified -
prune out branch on adjacent elm
rubbing this tree's stem at 2
metres**Priority:** 4 - Low

Tree Tag: LZ01172

Stems: 3

Species: Acer campestre (Field Maple)

Site: LZ 25 - St. Mark's Bridge

Location: London Zoo

Grid Ref: TQ 28250 83671

Owner: The Royal Parks

Inspection: 11/02/2025

Height: 1.5-7.0 metres

Age: Semi-mature

Trunk: 90 mm

Spread: 3 to 6 meters

Features:

Conditions: Multi-stemmed

Comments:

Visited By: BC

Failure: None Apparent

Target: High

Impact: Small <10

Authority: Camden

Recommendations: Coppice

Priority: 4 - Low

Tree Tag: LZ01179

Stems: 1

Species: Acer campestre (Field Maple)

Site: LZ 25 - St. Mark's Bridge

Location: London Zoo

Grid Ref: TQ 28245 83668

Owner: The Royal Parks

Inspection: 13/02/2025

Height: 1.5-7.0 metres

Age: Semi-mature

Trunk: 80 mm

Spread: Up to 3 meters

Features:

Conditions:

Comments:

Visited By: BC

Failure: None Apparent

Target: High

Impact: Small <10

Authority: Camden

Recommendations: Coppice

Priority: 4 - Low

Tree Tag: LZ00833

Stems: 1

Species: Acer pseudoplatanus
(Sycamore)

Site: LZ 26 - Car Park (Pump Station)

Location: London Zoo

Grid Ref: TQ 28265 83639

Owner: The Royal Parks



Unsuitable location for tree

Inspection: 07/03/2023

Height: 1.5-7.0 metres

Age: Semi-mature

Trunk: 80 mm

Spread: 3 to 6 meters

Features:

Conditions: Other - single regrown stem upon old previously cut stump, now beginning to develop a lean out over houseboat
Unsuitable location for tree

Comments:

Visited By: AC

Failure: None Apparent

Target: Very High

Impact: Small <10

Authority: Camden

Recommendations: Fell to ground

Priority: 3 - Medium

Tree Tag: LZ03364

Stems: 1

Species: Crataegus sp. (Hawthorn)

Site: LZ 26 - Car Park (Pump Station)

Location: London Zoo

Grid Ref: TQ 28343 83617

Owner: The Royal Parks

Inspection: 28/02/2023

Height: 1.5-7.0 metres

Age: Semi-mature

Trunk: 100 mm

Spread: 3 to 6 meters

Features:

Conditions: Epicormic growth - epicormic shoots and low branches have nasty thorns quite close to footpath.
Low branches

Comments:

Visited By: AC

Failure: None Apparent

Target: High

Impact: Small <10

Authority: Camden

Recommendations: Remove epicormics base/trunk
Crown lift to 2.0m

Priority: 3 - Medium

Tree Tag: LZ03581**Stems:** 1**Species:** Crataegus monogyna
(Hawthorn)**Site:** LZ 28 - Car Park (Outer Circle)**Location:** London Zoo**Grid Ref:** TQ 28478 83544**Owner:** The Royal Parks

Dead

Inspection: 21/03/2023**Height:** 1.5-7.0 metres**Age:** Mature**Trunk:** 200 mm**Spread:** 3 to 6 meters**Features:****Conditions:** Dead - weighted to North towards
low occupancy bramblesNB new green hawthorn leaves in
foreground of photo are on
adjacent hawthorn**Comments:****Visited By: AC****Failure:** Likely/Foresee**Target:** Medium**Impact:** Medium 35-10**Authority:** Camden**Recommendations:** Fell to ground**Priority:** 3 - Medium

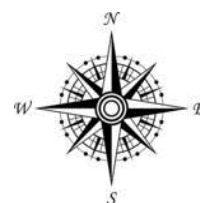

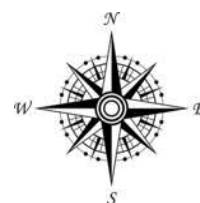
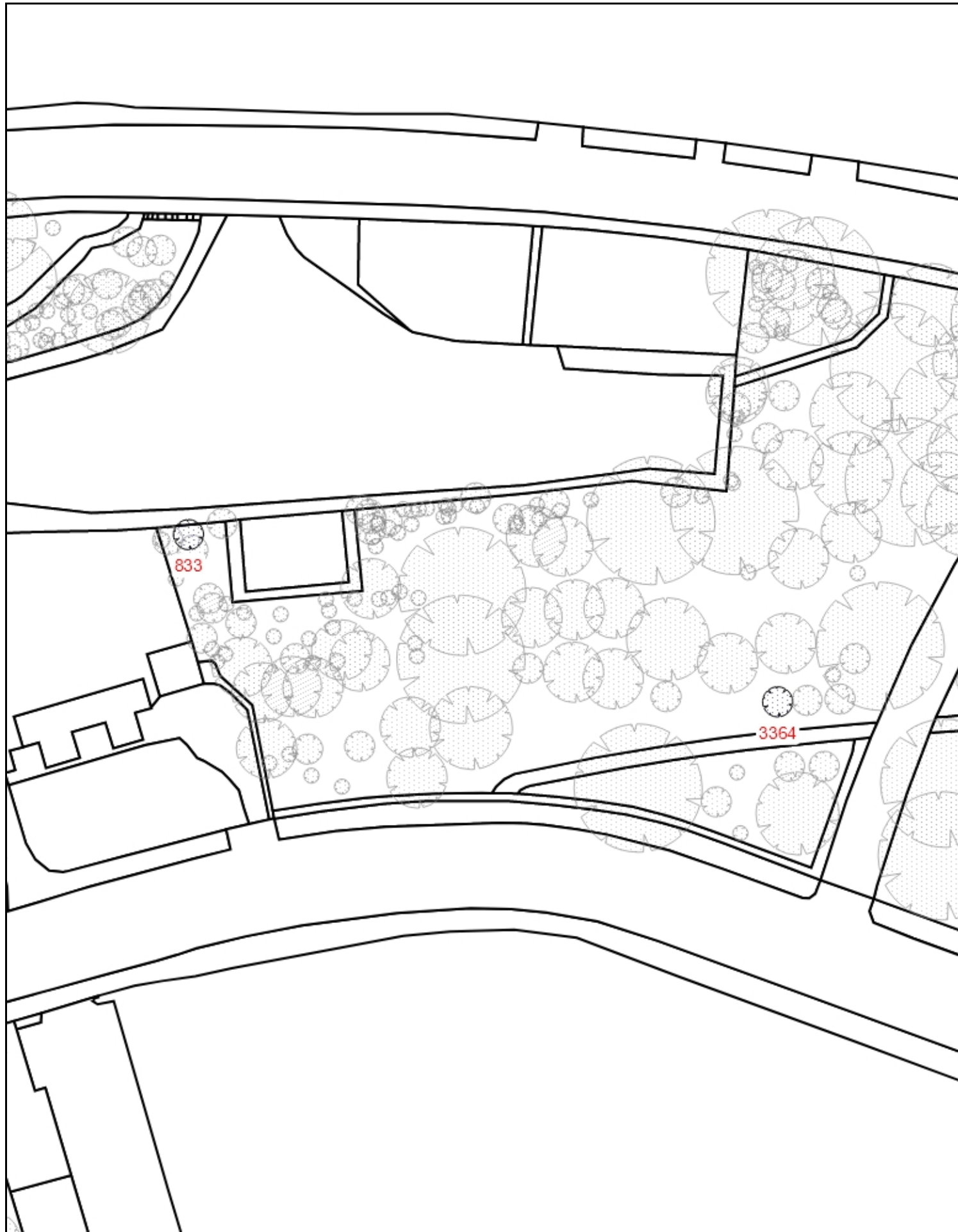

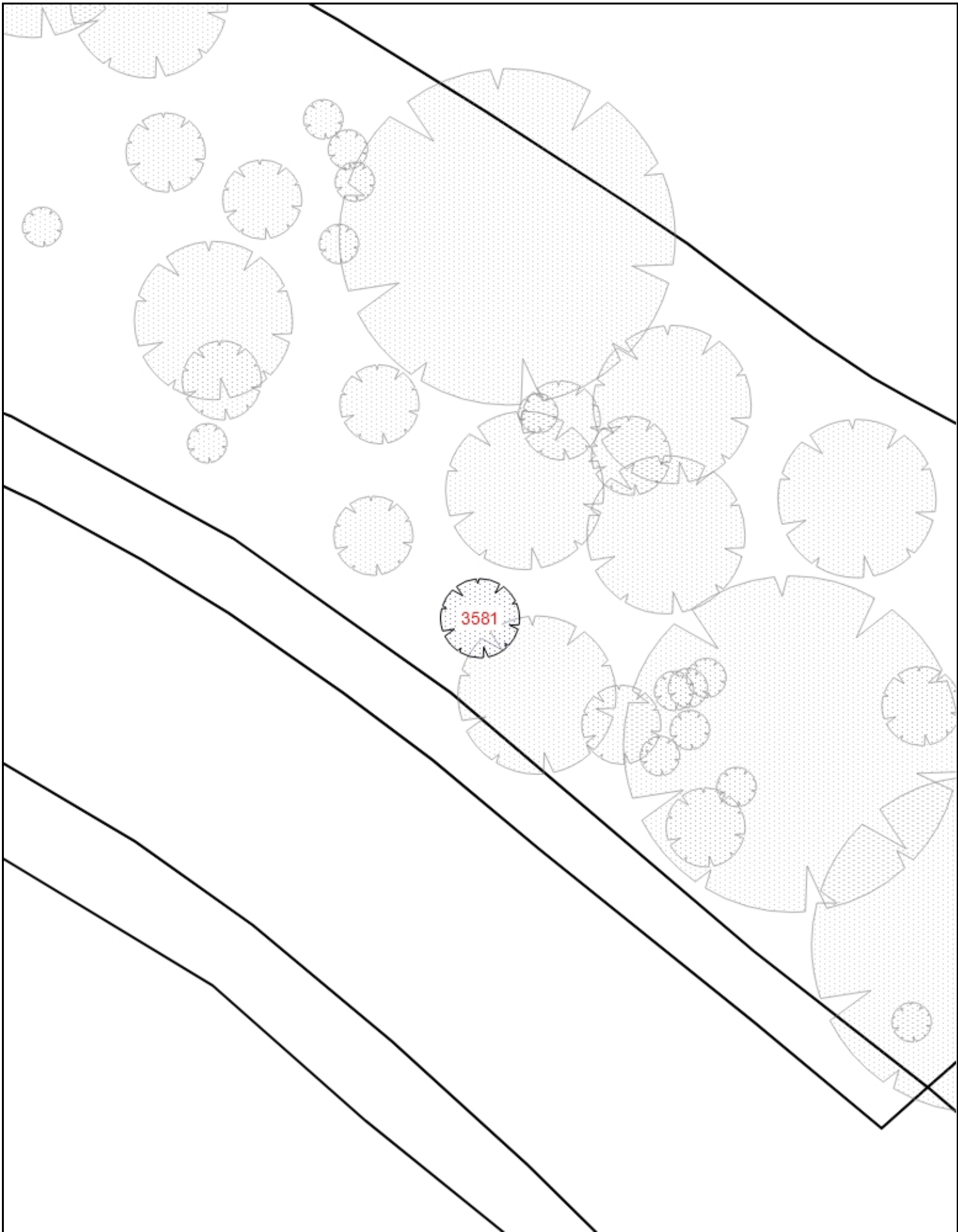

	LZ 28 - Car Park (Outer Circle)	Scale	1: 244	
		Date	28/03/2025	