

Copyright Hawkins\Brown Architects  
No implied licence exists. This drawing should not be used to calculate areas for the purposes of valuation. Do not scale this drawing. All dimensions to be checked on the site by the contractor and such dimensions to be their responsibility. All work must comply with relevant British Standards and Building Regulations requirements. Drawing errors and omissions to be reported to the architect. To be read in conjunction with Architect's specification and other consultant information.

Rev	Description	Date
P01	Plot 1 drawing update: Level 00 vent riser position (update: NE corner)	01/09/20
P02	Issued for Planning (Planning Amendments)	19/02/21
P03	Issued for Planning (Planning Amendment Updates)	29/03/22

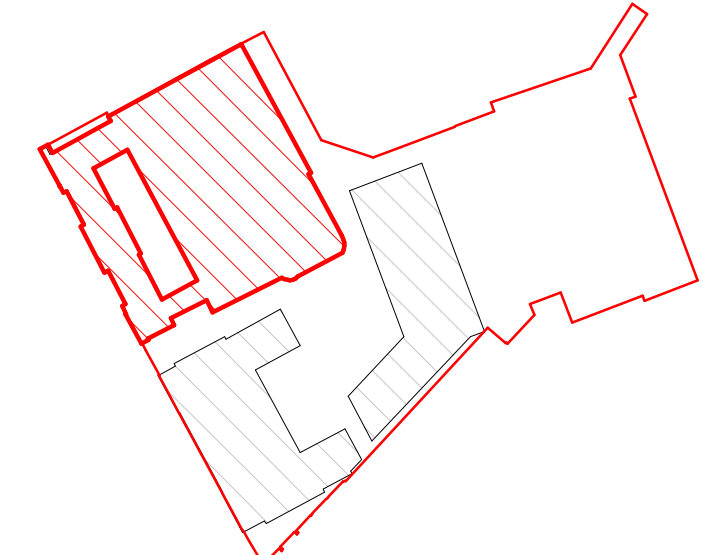

Site Plan: NTS

Planning Boundary

Note: Site boundary shown for information purposes only and does not represent a legal site demise.

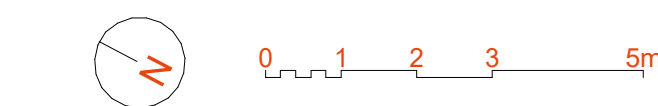

199 St John Street  
London EC1V 4QJ  
mail@hawkinsbrown.com  
hawkinsbrown.com

# Hawkins\Brown

Project  
256 Grays Inn Road  
London  
WC1X 8LD

Drawing  
Plot 1 Level 00 GA Plan - Proposed

Scale @ A0  
1 : 100  
Date  
March 2022

Drawn By  
Checked By

Job Number  
17056  
Status  
S2  
Purpose of Issue  
For Information

Drawing No.  
BEMP-HBA-P1-00-DR-A-20-1102  
Rev  
P03