

[illegible][illegible]

## Distribution

Revision prefixes:



Drawing History

Rev	Date	Description	Drawn	Checked
P1	26.08.21	For Comment	AK	MC
T1	28.09.21	For Tender	AK	MC
T2	07.10.21	For Tender	AK	MC
T3	18.01.22	For Tender	AK	MC
T4	19.06.24	For Tender	TPE	-

All cutouts to be cleanly disc cut using non percussive hand tools. Beams and lintels to be tightly dry packed into position

Unhatched walls are non-load bearing and are to be constructed to Architect's specification

U.N.O. All steelwork is to be grade S355, including plates and connections. Refer to Structural Specification

U.N.O. All bolts to be Grade 8.8

WP = 100 x 100 x 10.0 SHS Windpost

Ultimate Pile loadings:

P1 - 55kN	P10 - 65kN
P2 - 70kN	P11 - 55kN
P3 - 95kN	P12 - 70kN
P4 - 70kN	P13 - 95kN
P5 - 55kN	P14 - 70kN
P6 - 65kN	P15 - 55kN
P7 - 70kN	P16 - 65kN
P8 - 75kN	P17 - 75kN
P9 - 55kN	P18 - 65kN

New cavity walls:

- Outer leaf = 100mm thick brickwork to Architect's specification with class (iii) mortar.
- Inner leaf = 100mm thick 3.6N/mm<sup>2</sup> blockwork with class (iii) mortar.

All masonry to be frost resistant below DPC

- Denotes new 325x325 mm 20.0N/mm<sup>2</sup> Fletton brickwork pier with class (ii) mortar. All masonry to be frost resistant below DPC

Proposed Steelwork Schedule

Ref.	Serial Size
UC2	152 x 152 x 30 UC
UC3	152 x 152 x 37 UC

NOTE: Contractor, in conjunction with Arboricultural consultant, to dig and review trial holes to ascertain root locations before proceeding with piled foundation. Contractor to notify Blue Engineering if roots are found clashing with proposed pile location. Pile locations to be reviewed on site with regard to existing root locations and relocated as necessary.

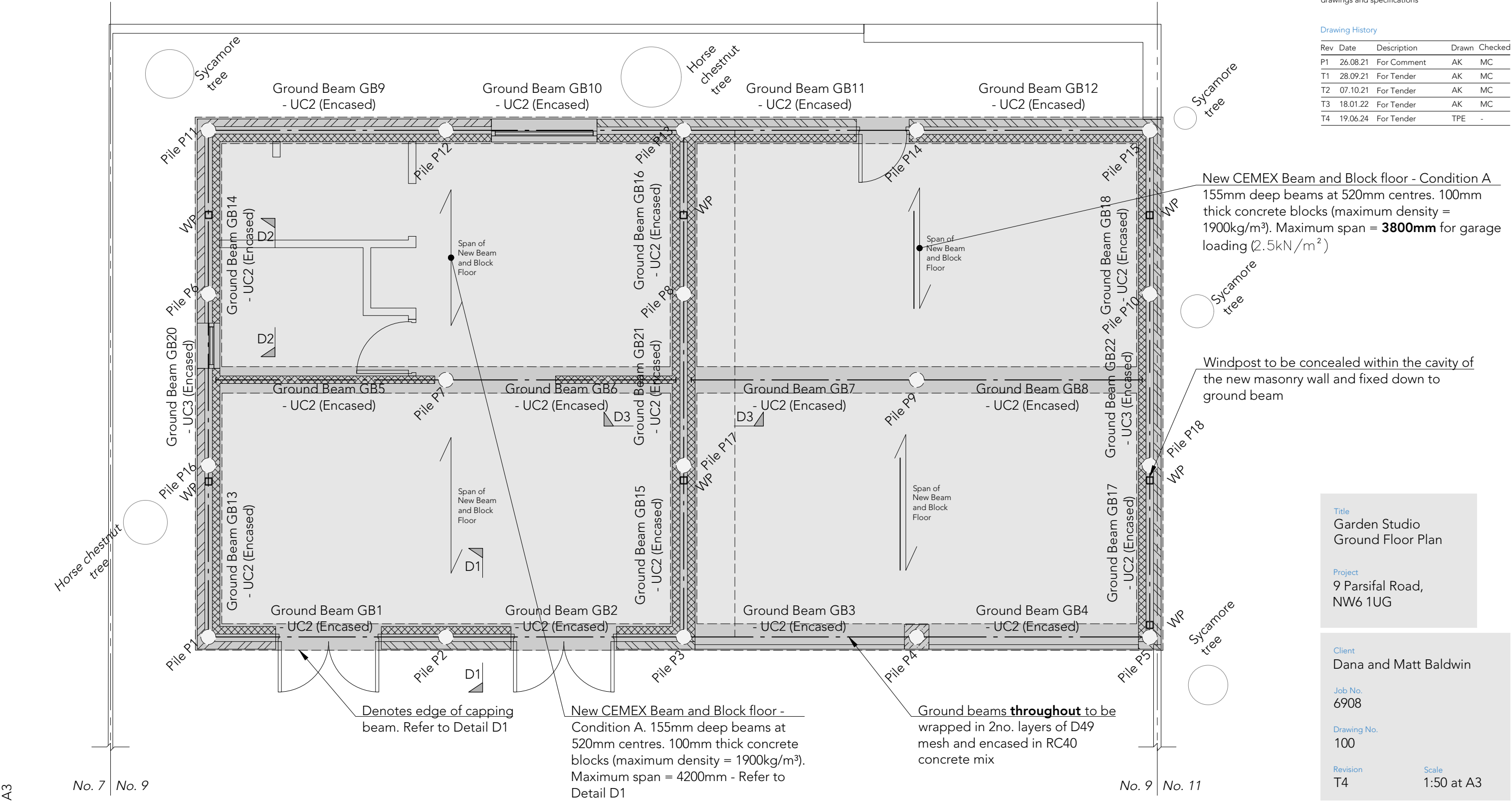

Title  
Garden Studio  
Ground Floor Plan

Project  
9 Parsifal Road,  
NW6 1UG

Client  
Dana and Matt Baldwin

Job No.  
6908

Drawing No.  
100

Revision  
T4

Scale  
1:50 at A3

All cutouts to be cleanly disc cut using non percussive hand tools. Beams and lintels to be tightly dry packed into position

U.N.O. All steelwork is to be grade S355, including plates and connections. Refer to Structural Specification

U.N.O. Steelwork to steelwork connections to be via 10mm thick end plates with 6mm full face fillet weld fixed into web of opposing beam using 4no. M16 bolts

U.N.O. All bolts to be Grade 8.8

Proposed Steelwork Schedule	
Ref.	Serial Size
UC3	152 x 152 x 37 UC

Lintel Schedule:  
L1: CG90/100

All lintels to have minimum 150mm bearing and be tightly dry packed into position

Padstone Schedule:  
P1: 300 x 100 x 15mm thick steel plate

All padstones to be tightly dry packed into position

----- Indicates line of structure under

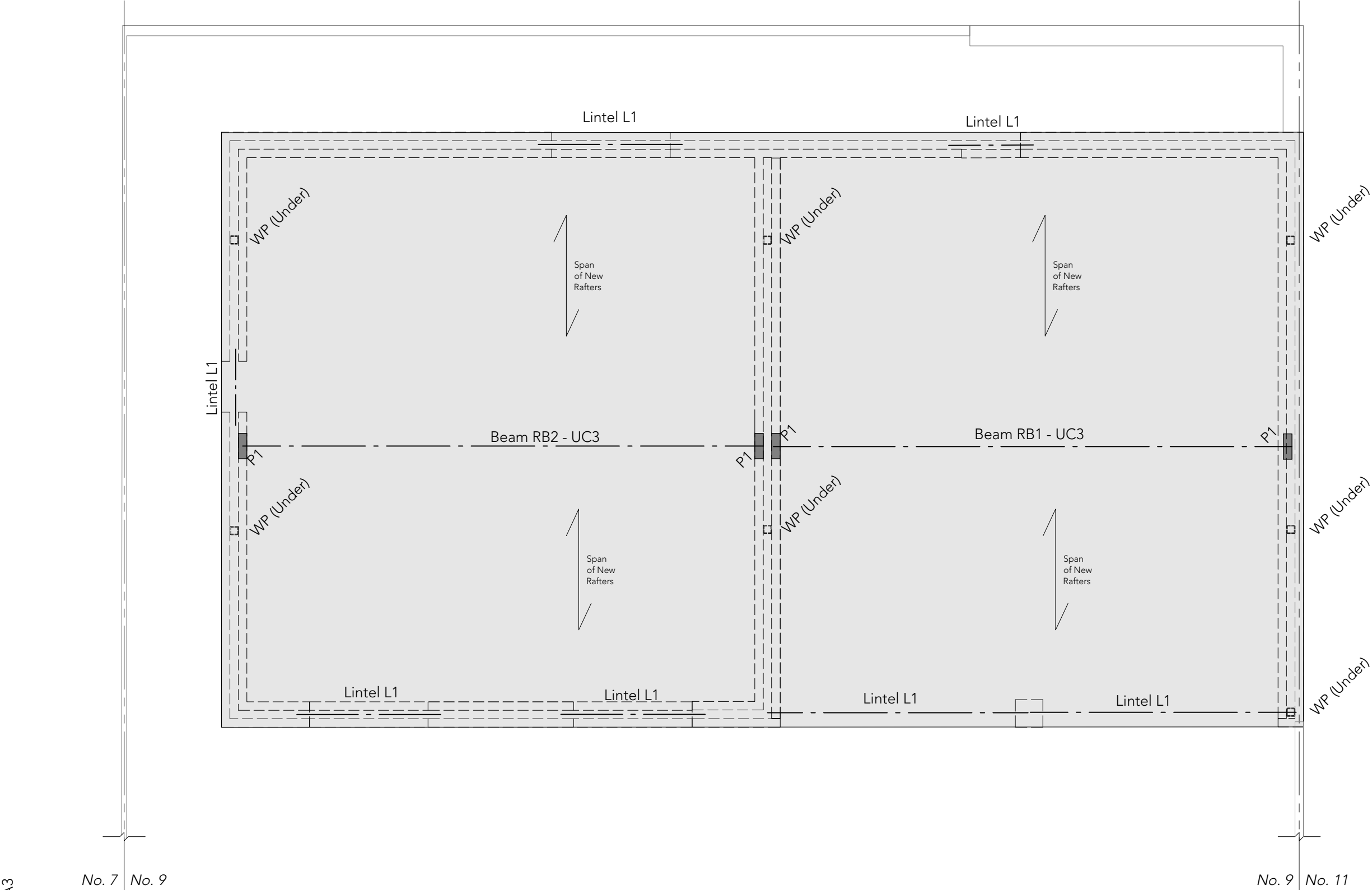

DO NOT SCALE FROM THIS DRAWING

All dimensions to be verified on site before commencing work. All error and omissions are to be reported to the Engineer. This drawing is to be read in conjunction with all relevant Design Team drawings and specifications

Drawing History				
Rev	Date	Description	Drawn	Checked
P1	26.08.21	For Comment	AK	MC
T1	28.09.21	For Tender	AK	MC

Title  
Garden Studio  
Roof Plan

Project  
9 Parsifal Road,  
NW6 1UG

Client  
Dana and Matt Baldwin

Job No.  
6908

Drawing No.  
102

Revision  
T1

Scale  
1:50 at A3

**DO NOT SCALE FROM THIS DRAWING**  
All dimensions to be verified on site before commencing work. All error and omissions are to be reported to the Engineer. This drawing is to be read in conjunction with all relevant Design Team drawings and specifications

Drawing History

Rev	Date	Description	Drawn	Checked
P1	26.08.21	For Comment	AK	MC
T1	28.09.21	For Tender	AK	MC
T3	18.01.22	For Tender	AK	MC
T4	06.03.25	For Tender	AB	TPE

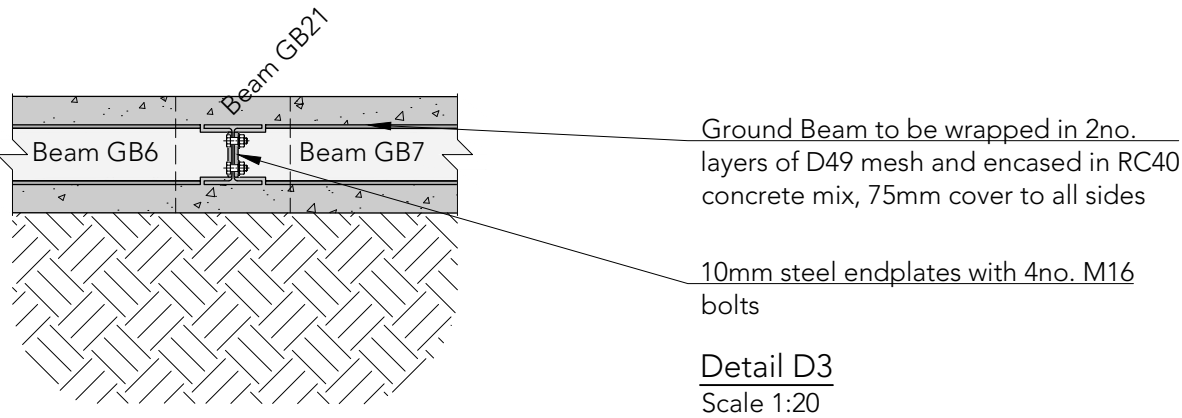
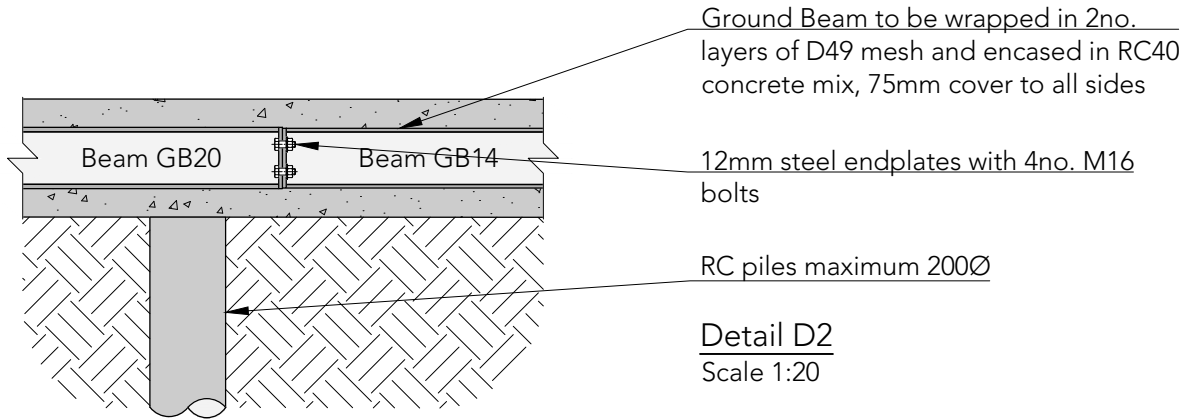
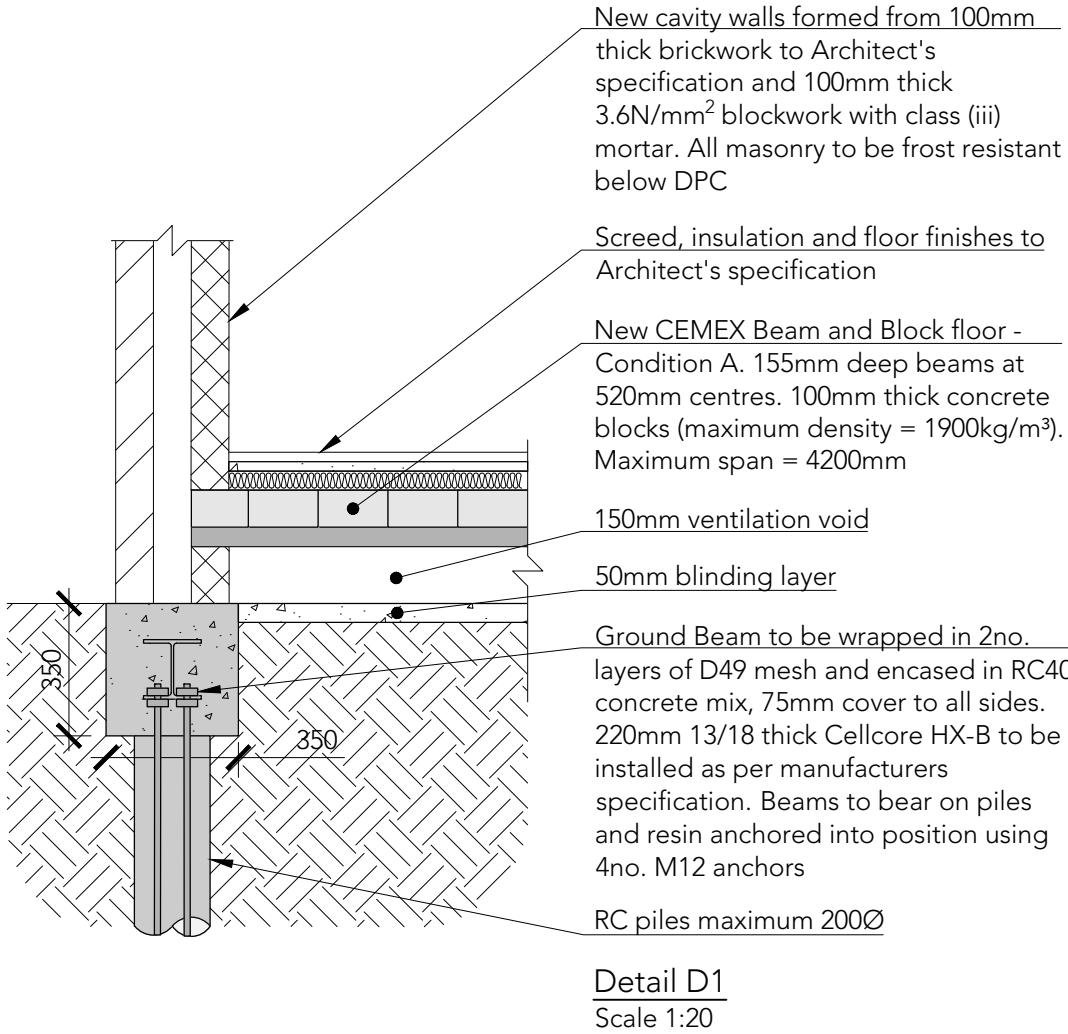

Title  
Structural Details

Project  
9 Parsifal Road,  
NW6 1UG

Client  
Dana and Matt Baldwin

Job No.  
6908

Drawing No.  
200

Revision  
T4

Scale  
1:20 at A3