

rd.18 - Top Roof Parapet

1 : 5

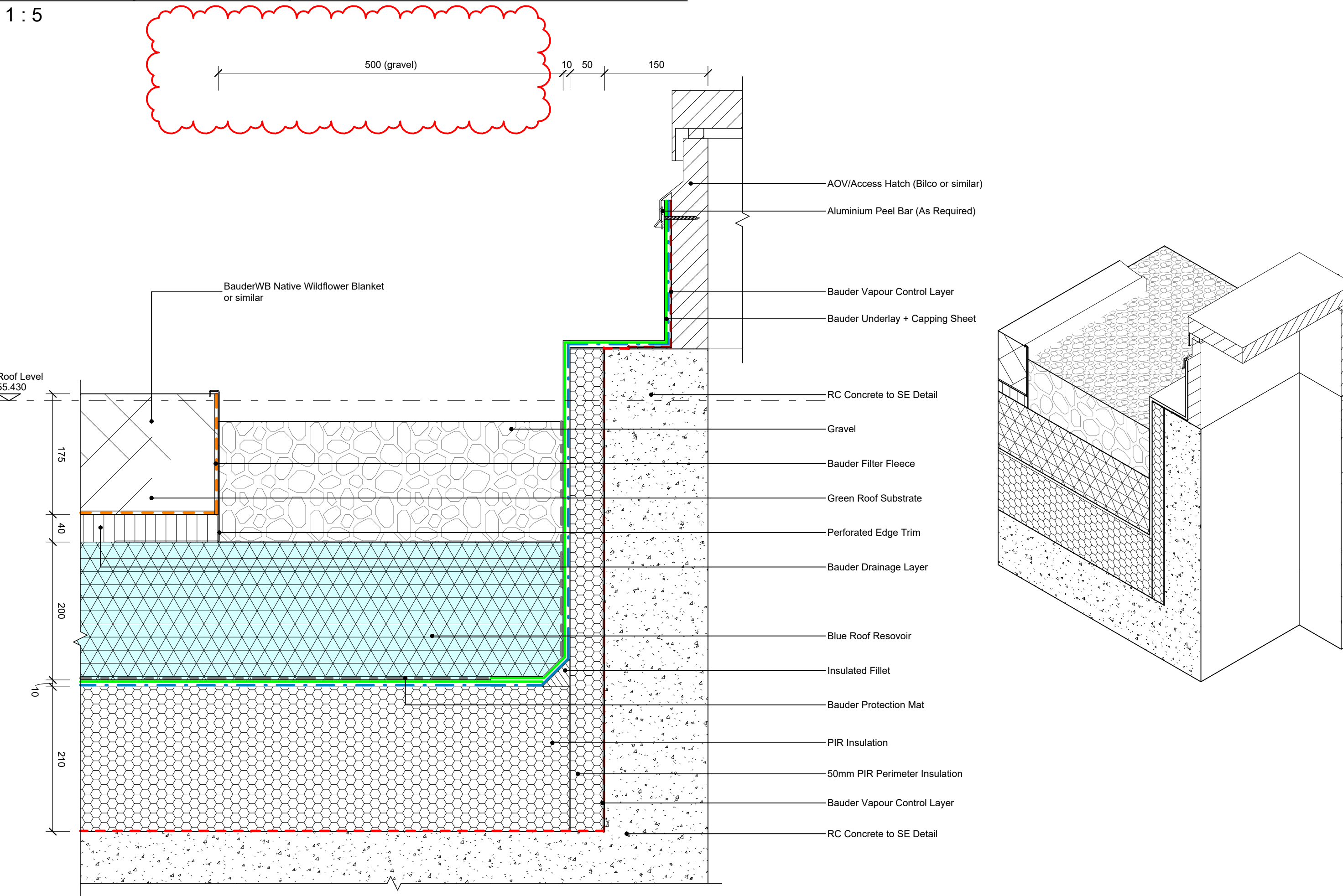

rd.19 - Top Roof AOV/Access Hatch Upstand

1 : 5

Do not scale from this drawing

© Brookes Architects Limited (BAL), all rights reserved.

This drawing has been prepared for the use of BAL's client specifically for the site titled below. It may not be used, modified, reproduced or relied upon by third parties.

Do not scale from this drawing. All areas are approximate. All dimensions are to be verified on site prior to construction. Responsibility for the reproduction of this drawing lies with the recipient to check that all information has been replicated in full when compared with the original.

This drawing must be read in conjunction with all other relevant consultants' information.

Any discrepancies and/or ambiguities within this drawing, or between it and information given elsewhere, must be reported immediately to BAL for clarification before proceeding.

All works are to be carried out in accordance with current British Standards, Building Regulations and relevant Codes of Practice.

Refer to the Construction (Design and Management) documentation where applicable. It is assumed that all works will be carried out by a competent contractor working, where necessary, to an approved method statement.

0m 0.1m 0.2m 0.3m 0.4m 0.5m

Visual Scale 1:5

CONSTRUCTION

C2	Co	Gravel width increased to 500mm	14.02.25	TL/TL
C1	Co	General updates & winter garden detail to 31-305	22.10.24	JB/AW
P3	Pr	Note added	06.12.23	AM/A
P2	Pr	Preliminary Issue	10.09.23	TL/TL
P1	Pr	Preliminary Issue	25.08.23	KT/TL
Rev	Status	Description	Issued	Drawn/Chk

Client

Myco

Project No.

5361

Project

Acorn House
Gray's Inn Road
London, WC1X 8DP

Drawing

Roof Details

Sheet 9

Parapet + AOV

Scale	Date	Drawn	Checked
1 : 5@A1	Aug '23	TL	TL

BrookesArchitects

Unit 1 - 56 Glenham Road
London SW13 9JJ

T 020 8487 1223

www.brookesarchitects.co.uk

5361-BAL-XX-XX-DR-A-27-0209	Revision C2 Co Status
-----------------------------	--------------------------------