

Front Elevation

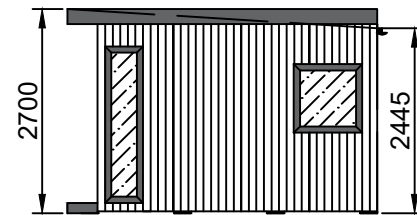

Right Elevation

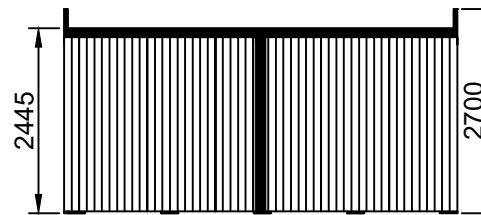

Rear Elevation

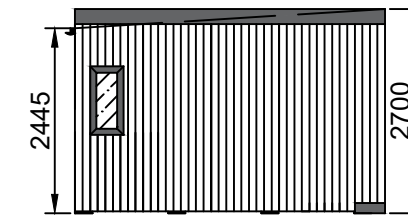

Left Elevation

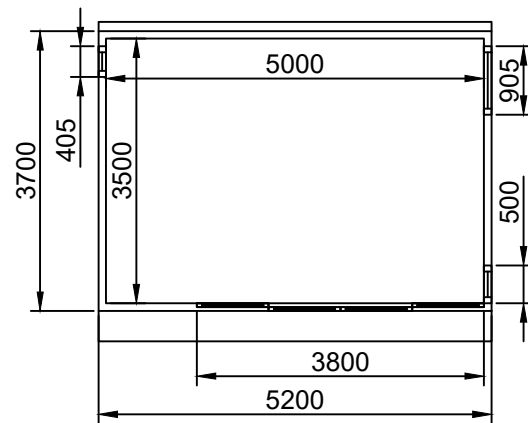

Floor Plan

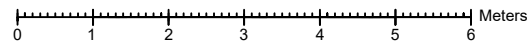

General Construction

Roof:

60mm - 95mm of high density polyurethane insulation surrounded by 1mm steel plates

Floor:

80mm Interlocking steel coated structurally insulated floor panels sit on top of foundation system.

Walls:

Timber frame (Tanalised) with 50mm of Rockwool insulated cavity incorporating breathable foiled photon wrap.

Cladding:

Tanalised shiplap vertical redwood timber cladding to all elevations.

Doors:

Sliding doors (3800mm x 2070mm) with Planitherm glass

Windows:

Vertical lozenge window (405mm x 905mm, Opening: top-hung) with Planitherm glass

Small full height window (non-opening) with Planitherm glass

Square window (905mm x 905mm, Opening: top-hung) with Planitherm glass

Drawing Title: Vasanth Padaki	Number: 1.	Scale: 1:100 All measurements in mm, setup for A3 printing.
Designed By: Becky Harper	Date: 12/03/2025	
Installation Address: 18 Aberdare Gardens London NW6 3PY	Design: G5 - 5.0m x 3.5m	
	Reference: 250200335TGOSA	