

1

Existing GF Plan

Scale: 1:100

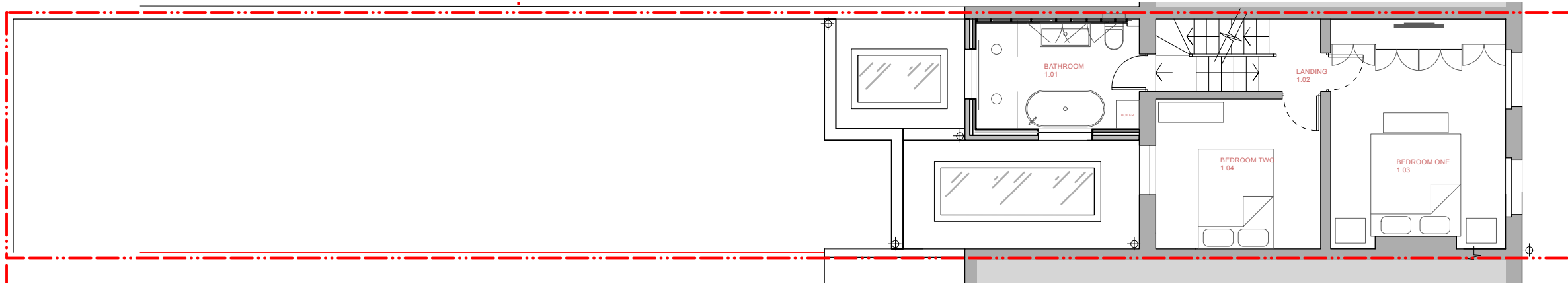

2

Existing FF Plan

Scale: 1:100

KEYS

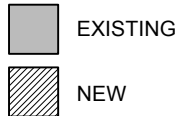

REVISION			
DATE	28.01.2025	SCALE	1:50
PROJECT	82 Harwood Street		
CLIENT	Tom Rutt		
DRAWING TITLE	Existing GF and FF Plans		
DRAWING No.	TRS027_EX_001		
ISSUE	PERMITTED DEVELOPMENT		

TR STUDIO

Architecture | Interiors

The Blackfrairs Room | St Bride
Foundation | 14 Bride Lane | London
EC4Y 8EQ

T: +44 (0)203 567 0569
E: office@trstudio.co.uk
W: www.trstudio.co.uk

This drawing must not be scaled from nor should it be used for the calculation of areas for the purposes of valuation. All dimensions are indicative and must be verified on site prior to the commencement of any works. This drawing must be read in conjunction with all necessary information from all other design consultants and contractors. All works must comply with the relevant British standards and building control requirements. Drawing errors to be reported to the Architect.