

2 PROPOSED FIRST FLOOR PLAN
Scale: 1:100

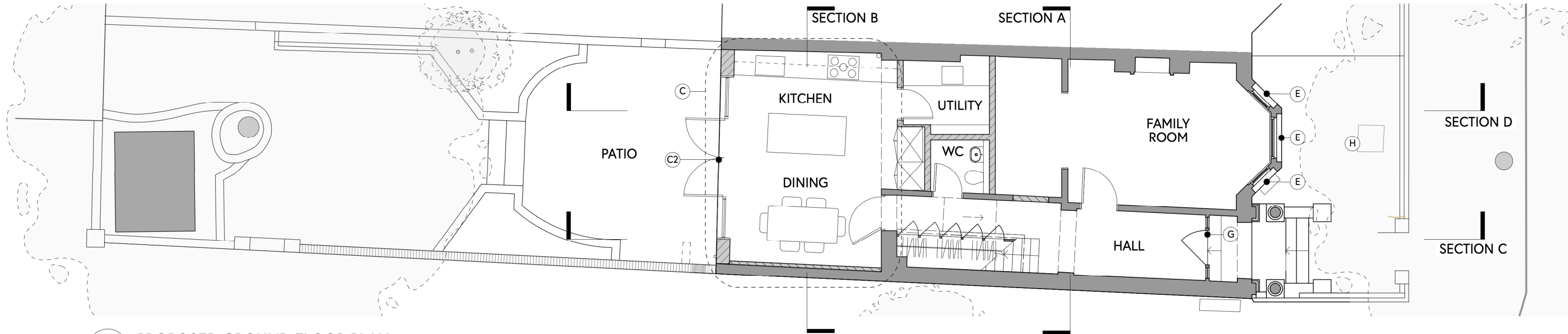

1 PROPOSED GROUND FLOOR PLAN
Scale: 1:100

DRAWING NOTES: PROPOSED

- A** Main roof replacement:
-New natural slate roof cladding to entire roof, with lead flashings and new insulation internally
-Existing primary structure retained if possible, or replaced with new structure to existing roof profile

A1 Existing side dormer replaced with similar, widened pitched-roof side dormer with slate cladding, painted timber casement window and gable infill

A2 Existing Velux-style rooflight replaced with similar, larger rooflight, in line with front roof pitch, colour to match slate

A3 New rear dormer with slate cheeks to match main roof, slate grey GRP flat roof and painted timber three-panel casement window to match side dormer
- B** Alterations to existing first floor rear extension:
-Existing retained side and end walls extended vertically to form new, enclosing flat roof parapet with soldier course detailing and continuous concrete coping
-New slate grey GRP flat roof

B1 Existing rear-facing window opening extended vertically with adjusted position in end wall, with new painted-metal casement frame, coordinating with proposed doors at ground level

B2 Existing street-facing window opening extended vertically to match height of proposed rear-facing opening, with new painted-metal three-panel casement frame, coordinating with proposed doors at ground level
- C** Alterations to existing ground floor rear extension:
-New stock brick rear wall in line with existing, to match primary elevations
-Rear wall parapet height raised to suit new roof profile and fully enclose roof, with soldier course detailing and new concrete coping
-New slate grey GRP flat roof concealed behind parapet

C1 New flat rooflight concealed behind parapet

C2 Painted metal Crittal-style fixed glazing and French doors opening to garden
- D** Existing retained side wall to street altered to hide extension roof, detailed as part of garden wall with sloped transition section and rowlock brick coping

E New heritage slimline double-glazed painted timber sash window

F Existing altered window opening restored to original proportions with modern concrete lintel removed

G New front door to match existing, with existing retained door frame, side lights, and transom.

H New inspection chamber position in front garden, relocated from interior

I New SVP position