

Glazed Light Typical Detail
As Proposed 1:20

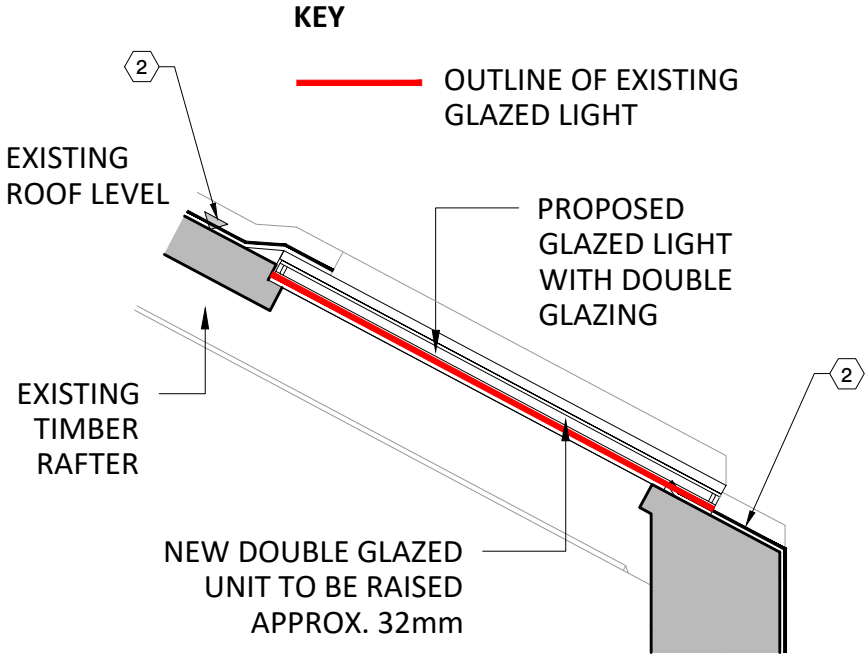

Section A-A
As Proposed 1:20

- Notes:
1. New glazing to glazed light as The Standard Patent Glazing Company Rafterline aluminium glazing bar with double glazing and lead cloaked timber roll fixed to cap. Ref UCL/08.
 2. REMOVE EXISTING PERIMETER LEAD AS REQUIRED TO ALLOW WORKS TO BE UNDERTAKEN. AS REQUIRED. PROVIDE NEW LEAD COVERING TO CLAUSE H71/110

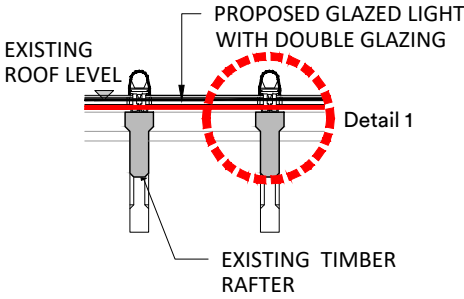

Section B-B
As Proposed 1:20

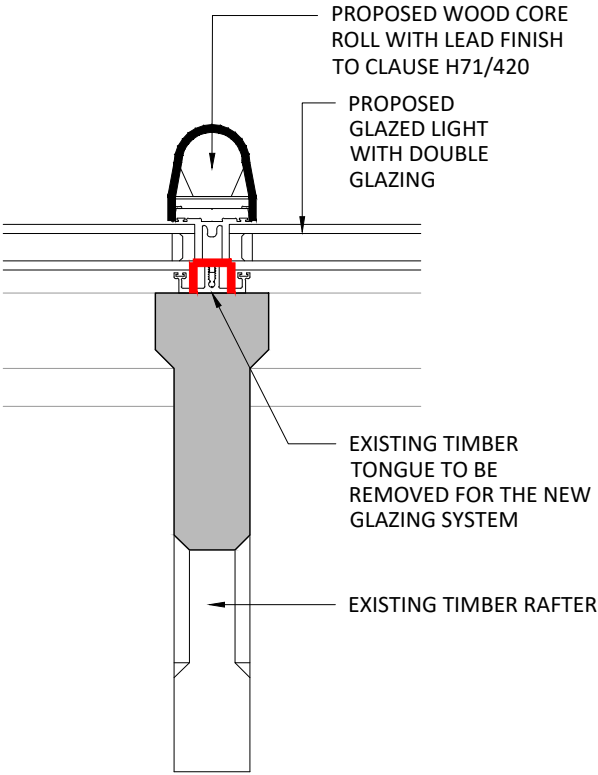

Detail 1 - Typical Glazed Light Detail
As Proposed 1:5

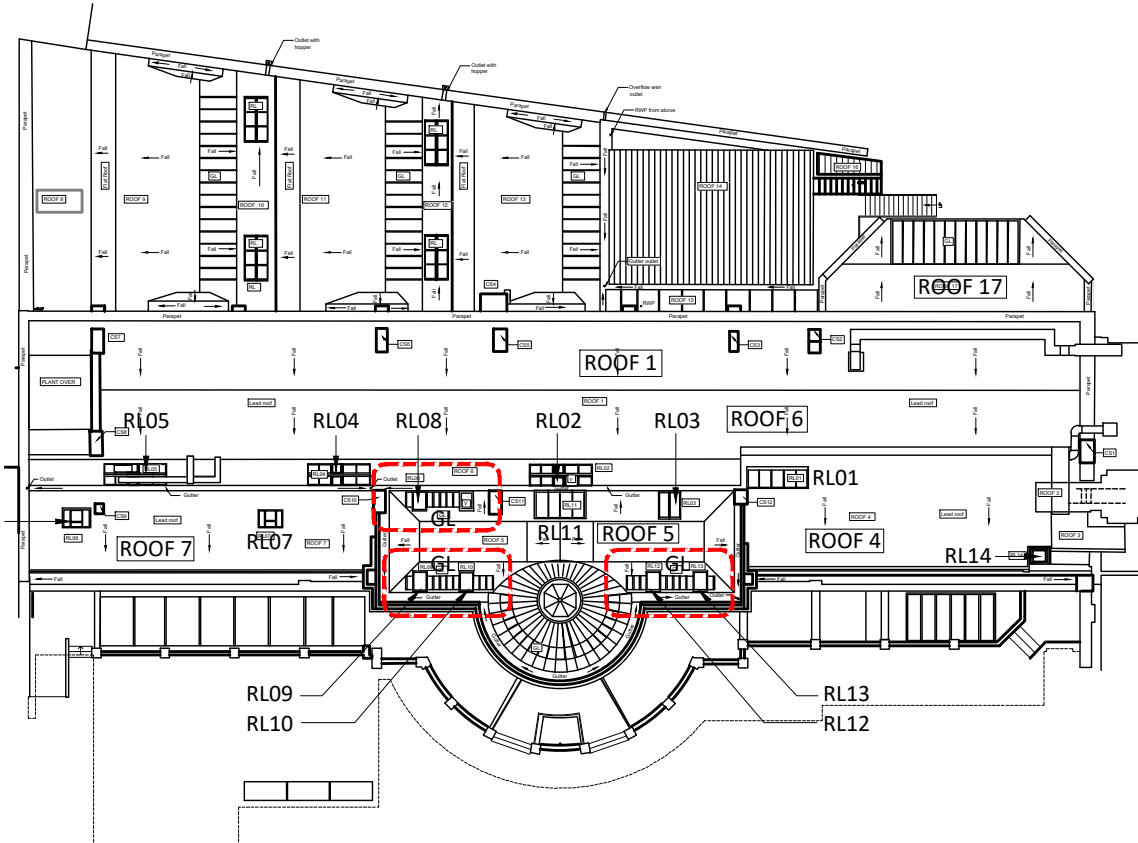
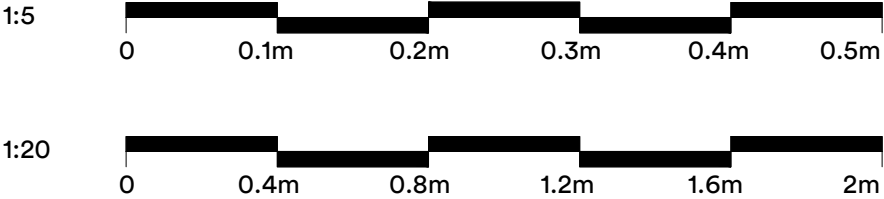

Rooflight Location Plan
NTS

P01 Issue for Planning			04:02:25		ck	
rev.	description		date	drawn	chkd	
client :						

UCL

project :

The Slade School of Fine Art
Gower St London WC1E 6BT
External Repairs

drawing title :

Glazed Light
As Proposed

FulkersBaileyRussell

London | Basingstoke | Brighton | Bristol | Cardiff | Kings Hill | Manchester

info@fulkers.co.uk // www.fulkers.co.uk // 020 3735 5792

proj no :	24 4682	scale:	1: 20 & 1:5 @A3
identifier :	4682-FBR-A1-XX-DR-A-239		
status:	S2 (For Information)	rev no:	P.01