

Rooflight RL08 RL09 RL10 RL12 RL13 & Typical Inset Glazed Panel
As Proposed 1:20

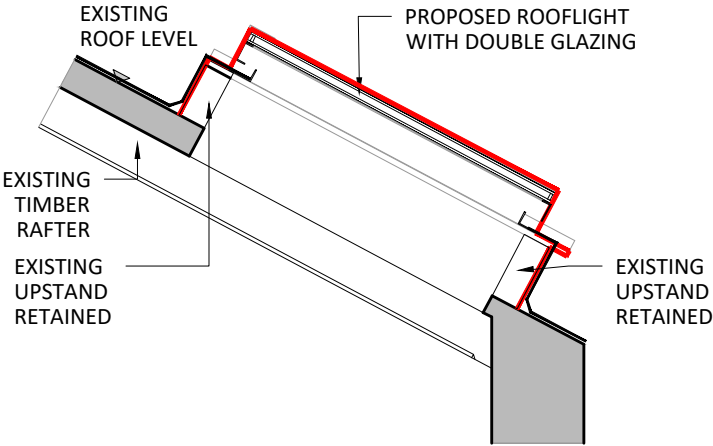

Section A-A
As Proposed 1:20

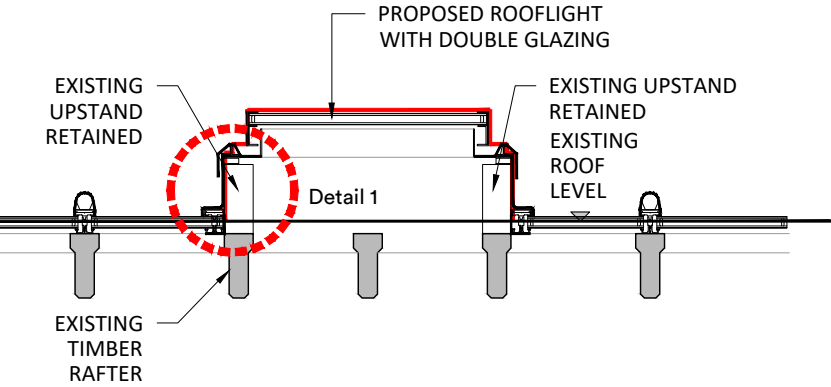

Section B-B
As Proposed 1:20

- Notes:
1. New glazing to rooflight as The Standard Patent Glazing Company No.7 'Heritage' lead covered steel glazing bar with double glazing. Ref. UCL/07 and UCL/04.
 2. REMOVE EXISTING PERIMETER LEAD AS REQUIRED TO ALLOW WORKS TO BE UNDERTAKEN. AS REQUIRED PROVIDE NEW LEAD COVERING TO CLAUSE H71/110
 3. New glazing to glazed light as The Standard Patent Glazing Company Rafterline aluminium glazing bar with double glazing and lead cloaked timber roll fixed to cap. Ref. UCL/08.

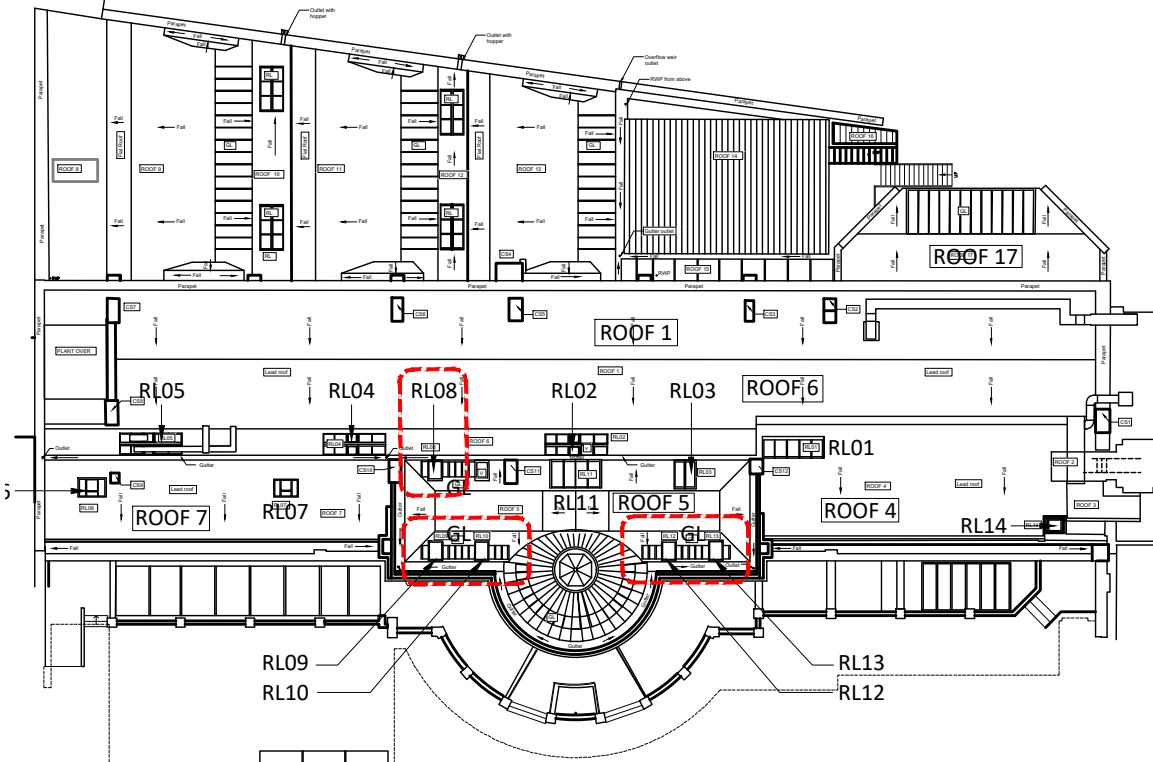

Rooflight Location Plan
NTS

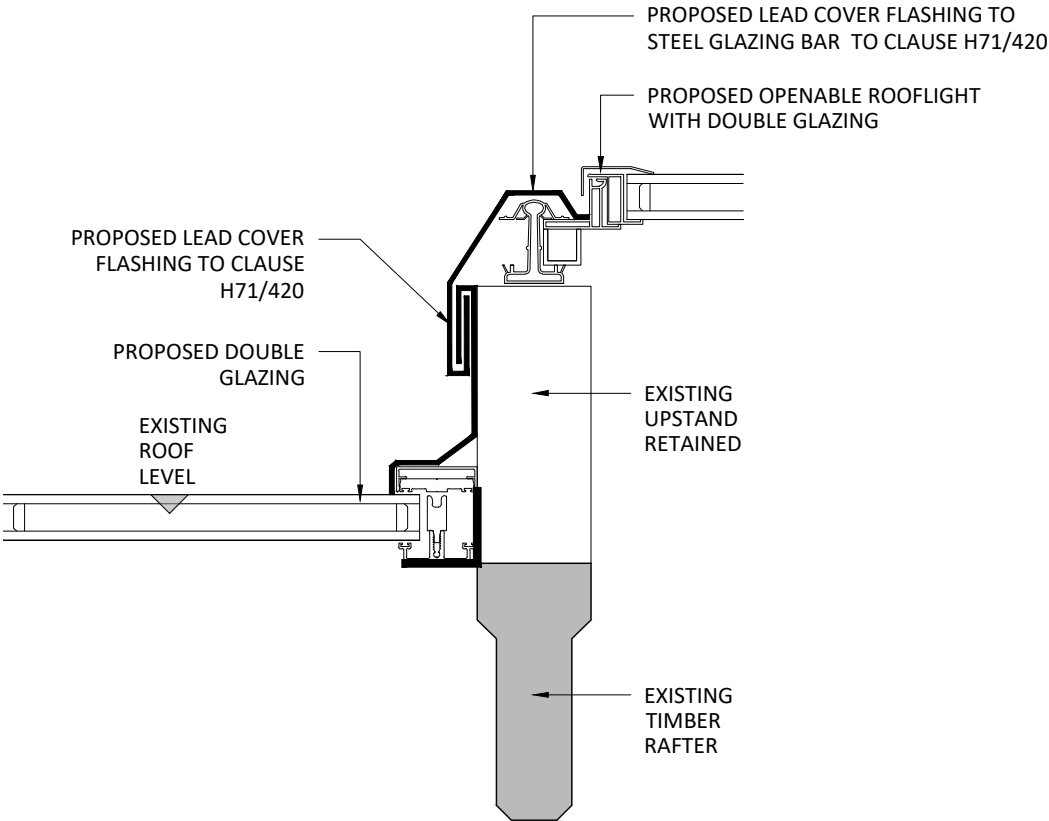

Detail 1 - Typical Rooflight Detail
As Proposed 1:5

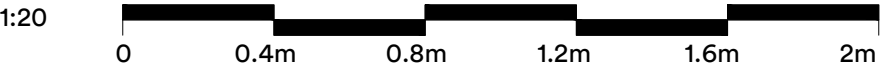
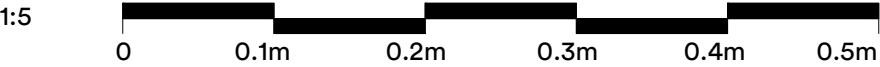

P01 Issue for Planning		03:02:25 ck	
rev.	description	date	drawn chkd

client :

UCL

project :

The Slade School of Fine Art
Gower St London WC1E 6BT
External Repairs

drawing title :

Rooflight RL08 RL09 RL10 RL12 RL13
And Typical Glazed Inset Panel
As Proposed

FulkersBaileyRussell
London | Basingstoke | Brighton | Bristol | Cardiff | Kings Hill | Manchester
info@fulkers.co.uk // www.fulkers.co.uk // 020 3735 5792

proj no : 24 4682	scale: 1: 20 & 1:5 @A3
-------------------	------------------------

identifier : 4682-FBR-A1-XX-DR-A-233

status: S2 (For Information)	rev no: P.01
------------------------------	--------------