

BUILDING DESIGN PARTNERSHIP SHALL HAVE NO RESPONSIBILITY FOR ANY USE OF THIS DRAWING FOR ANY OTHER PROJECT OR FOR ANY OTHER PURPOSE AND ANY DIMENSIONS SHOULD BE CHECKED ON SITE.
DO NOT SCALE FROM THIS DRAWING.

ANY DRAWING ERRORS OR OMISSIONS SHOULD BE BROUGHT TO THE ATTENTION OF BUILDING DESIGN PARTNERSHIP AT THE ADDRESS SHOWN BELOW.

NOTES

1. FINAL SETTING OUT OF ALL VISIBLE ELEMENTS TO BE CONFIRMED BY THE ARCHITECT/INTERIOR DESIGNERS.
2. ALL MANUFACTURES' EQUIPMENT AND SELECTIONS MUST BE APPROVED BY THE CLIENT TEAM. THE M&E TRADE CONTRACTOR IS RESPONSIBLE FOR VERIFYING ALL MANUFACTURES' EQUIPMENT PRIOR TO ORDERING OR FABRICATION OF ELEMENTS.
3. THE M&E TRADE CONTRACTOR SHALL ENSURE FULL CO-ORDINATION WITH ALL OTHER SERVICES.
4. THE M&E TRADE CONTRACTOR IS RESPONSIBLE FOR DESIGNING AND INSTALLING COMMISSIONABLE SYSTEMS.
5. IN THE EVENT THAT BDP DOCUMENTATION HAS CONFLICTING INFORMATION THE M&E TRADE CONTRACTOR SHALL RAISE THE QUERY WITH BDP ENGINEERS.
6. ALLOWANCE TO BE MADE BY M&E CONTRACTOR FOR INVESTIGATION AND TEMPORARY DIVERSION WORKS OF EXISTING SERVICES PROHIBITING ACCESS TO PROPOSED WORKS TO THE EXISTING RWMPs.
7. RAINWATER DESIGN TO BE TO BS EN 12056-3 & BUILDING REGULATIONS DOCUMENT PART H.
8. ALL CAST IRON DRAINAGE FITTINGS AND PREWORK TO BS EN 877.
9. ALL PVC-U RAINWATER PIPES AND FITTINGS AND GOODS TO BS 5751.
10. ALL EXISTING SANITARYWARE AND APPLIANCES CONNECTED TO RWMPs & WWP s TO BE TEMPORARILY DISCONNECTED TO ENABLE PROPOSED WORKS AND REINSTATED UPON COMPLETION OF STICK RENEWAL.

LEGEND

- EXISTING RAINWATER GUTTER
- NEW RAINWATER GUTTER
- EXISTING RAINWATER PIPE
- NEW RAINWATER PIPE
- ABANDONED RAINWATER PIPE

- RWP - RAINWATER PIPE
- RWG - RAINWATER OUTLET
- VP - VENT PIPE
- H/L - HIGH LEVEL
- L/L - LOW LEVEL
- FB - FROM BELOW
- TB - TO BELOW
- FA - FROM ABOVE
- TA - TO ABOVE
- RE - RODDING EYE
- A - ACCESS
- C.I - CAST IRON

P02 ISSUED FOR INFORMATION		AL	KHF	10.02.25
P01 ISSUED FOR INFORMATION		AL	KHF	04.02.25
DATE	25/04/25	DATE	25/04/25	

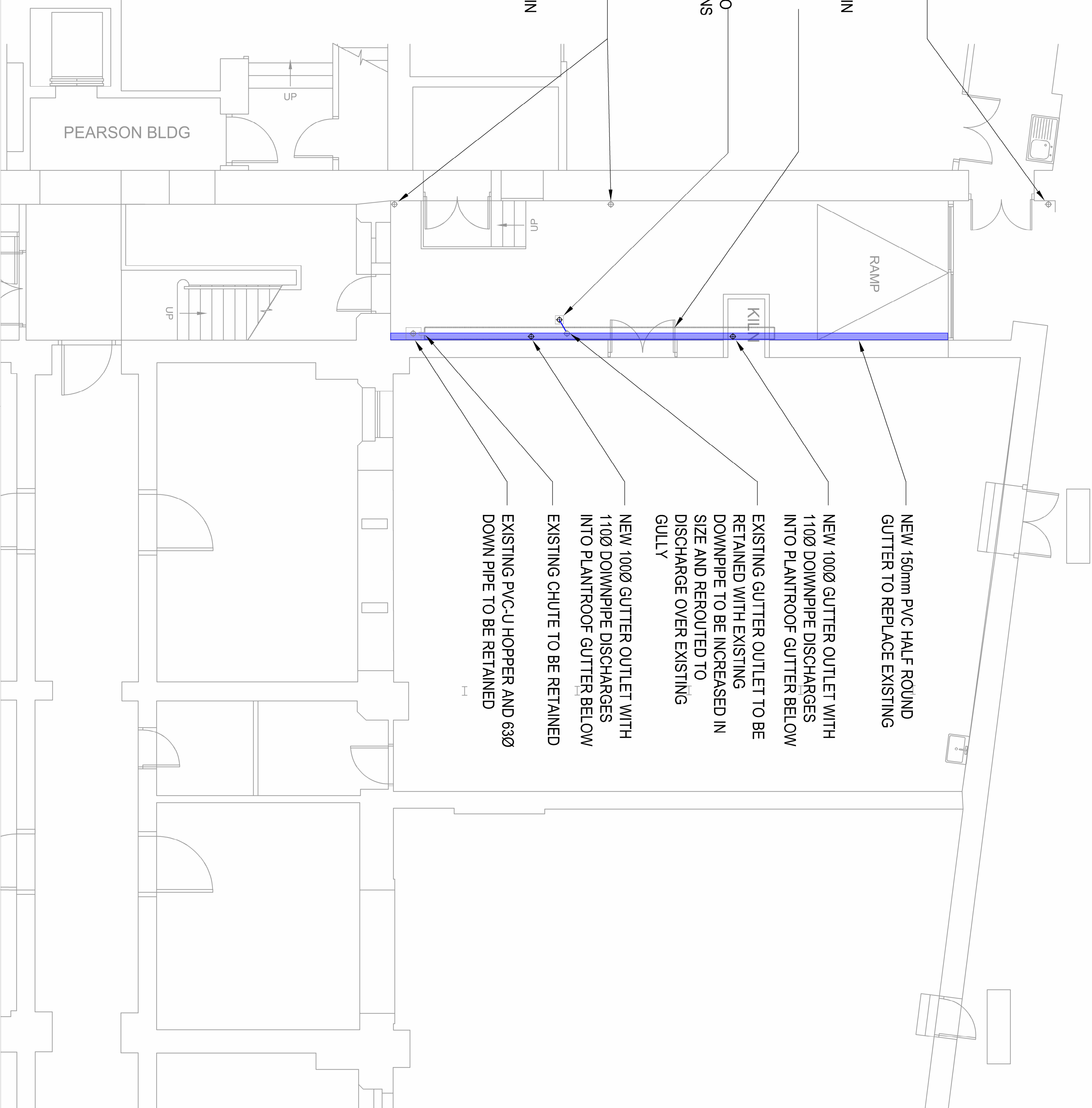

16 Brewhouse Yard
Cherrenwell
London
EC1V 4LJ
United Kingdom
T +44 (0)20 7612 3000
www.bdp.com



UCL SLADE SCHOOL OF FINE ARTS

P3002594

Rainwater Drainage Systems
External Plant space
Floor Plan Layout

UCL-BDP-XX-XX-PL-P-52-006

SCALE	@ A1
DATE	1:50
DATE	04.02.25
REVISION	P02