

- GENERAL NOTES:
1. This drawings should be read in conjunction with all relevant consultant and specialist drawings and contract documentation.
 2. Do not scale from this drawing.
 3. All dimensions are to be checked on site.
 4. The Architect is to be notified in writing, of any discrepancies before proceeding.
 5. This drawing is subject to Copyright.

WALL AND FLOOR FINISHES

1. NATURAL TEAK FLOORING
2. TECA LAMA 3X8cm
3. LARGE FORMAT MACAEL MARBLE POLISHING
4. AGED MACAEL MARBLE
5. PINK GRES MISTERY GREY
6. BRONZE MIRROR
7. GLASS
8. LED LIGHTING

FLOOR TEXTURES

- MACAEL MARBLE, AGED FINISH
- MACAEL MARBLE 80X80 cm AGED FINISH
- PINK GRES MISTERY GREY LARGE FORMAT (48.8X79) + SPECIAL PIECES
- NATURAL TEAK FLOORING

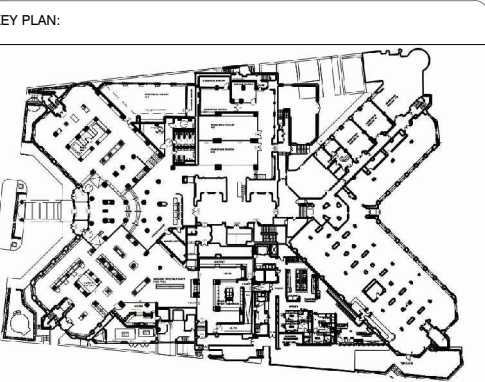
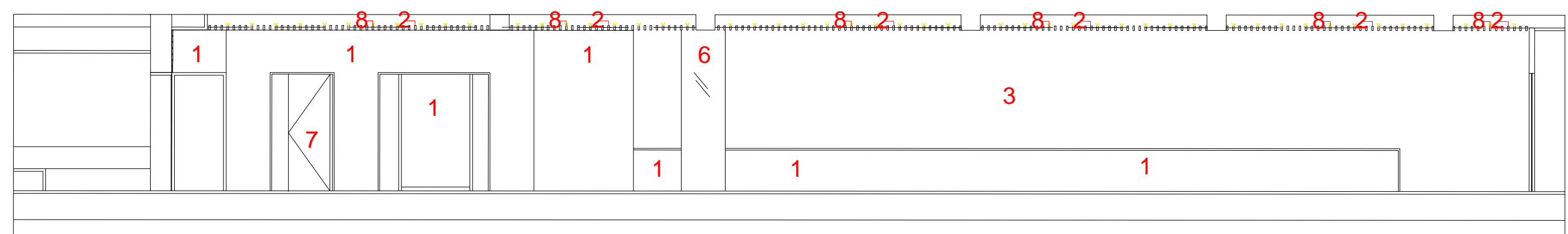
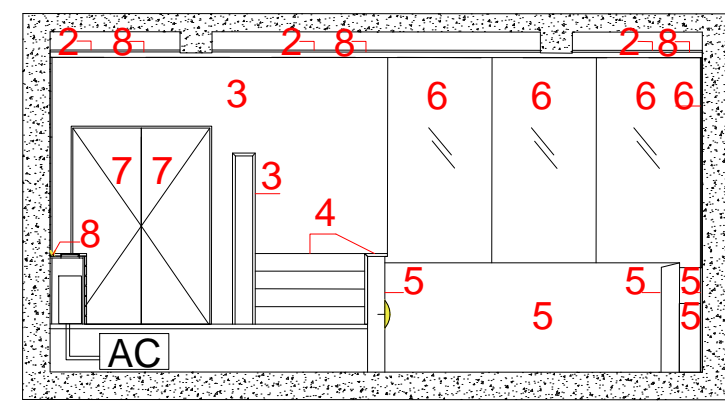
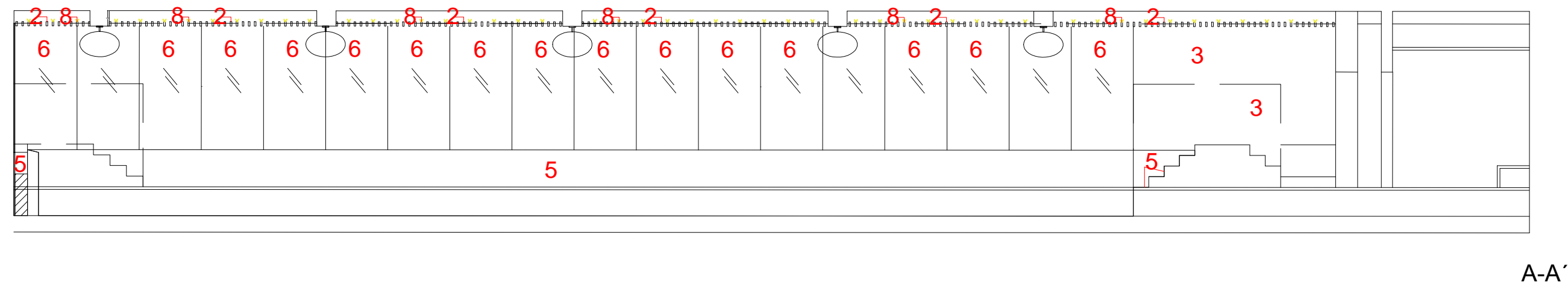

17-19 Lever St, Clerkenwell, London EC1V 3QU

PROJECT: MELIA WHITE HOUSE HOTEL

DRAWING STATUS: PLANNING

DRAWING NO: 202018_MW_PL_004

DRAWING TITLE: PROPOSAL BASEMENT FLOOR PLAN AND SECTIONS

SCALE AT A1: 1:50 SCALE AT A3: 1:100 DATE: 18/03/2025