

37 Eton Avenue NW3 3EP

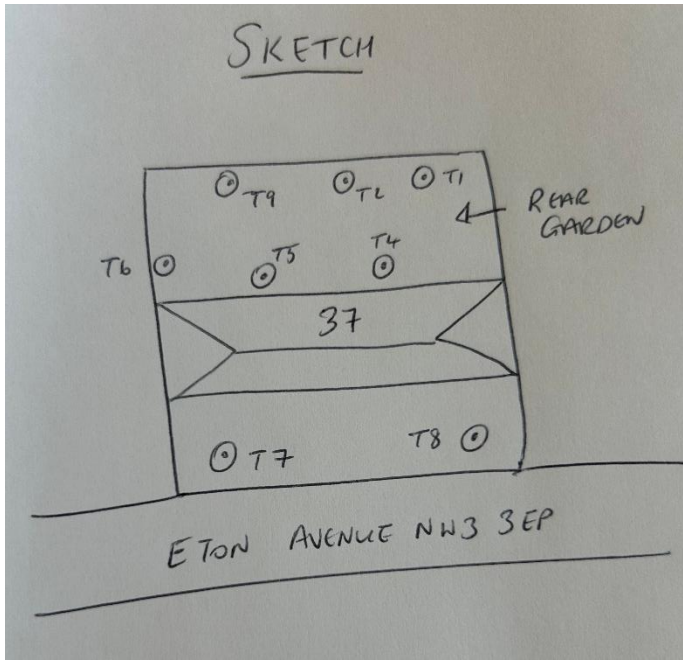





T1: Poplar (15m): Re-pollard to previous points removing 7m of growth to keep tree at a size suitable for its location and as part of regular maintenance

T2: Poplar (15m): Re-pollard to previous points removing 7m to keep tree at a size suitable for its location and as part of regular maintenance

T4: Maple (6m): Trim on house side and garden side by 1m to keep tree at a size suitable for its location and as part of regular maintenance

T5: Maple (6m): Trim on garden side only by 1m to keep tree at a size suitable for its location and as part of regular maintenance

T6: Crab apple (6m): Reduce height by 0.5m and shape to keep tree at a size suitable for its location and as part of regular maintenance

T7: Crab apple (6m): Reduce height by 0.5m and shape to keep tree at a size suitable for its location and as part of regular maintenance

T8: Crab apple (6m): Reduce height by 0.5m and shape to keep tree at a size suitable for its location and as part of regular maintenance

T9: Whitebeam (9m): Reduce height by 2m and shape to keep tree at a size suitable for its location and as part of regular maintenance