

SCREEN 02

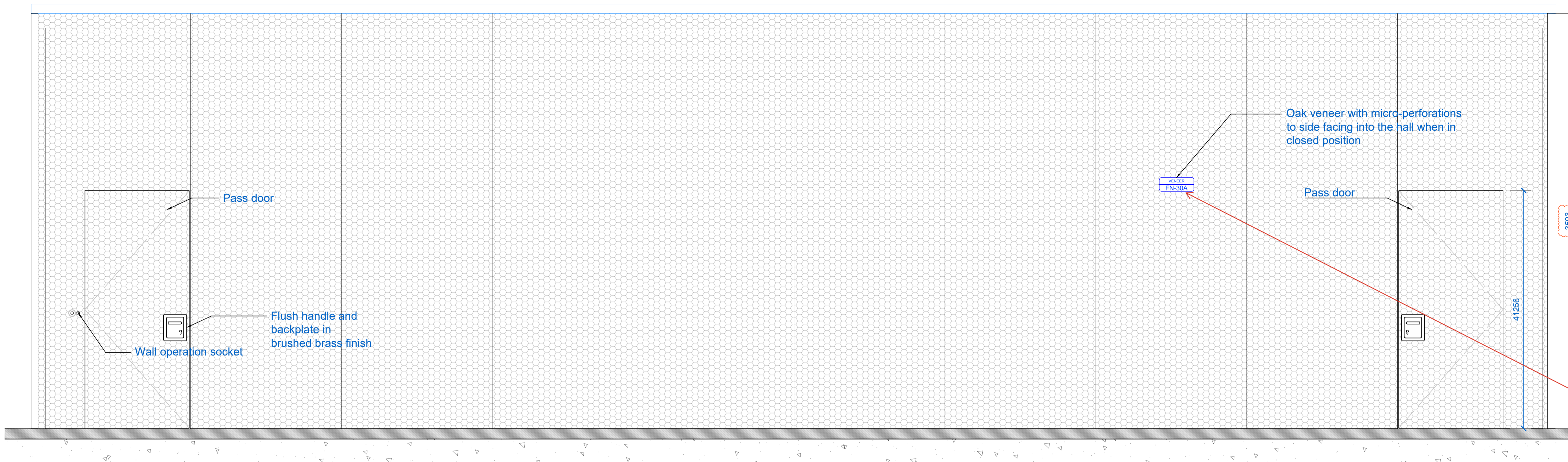

1 EVENT SPACE FOLDING PARTITION ELEVATION
6005 1:20

Notes:
 Drawings are based on survey data and may not accurately represent what is physically present.
 Do not scale from this drawing. All dimensions are to be verified on site before proceeding with the work.
 All dimensions are in millimetres unless noted otherwise.
 Purcell shall be notified in writing of any discrepancies.

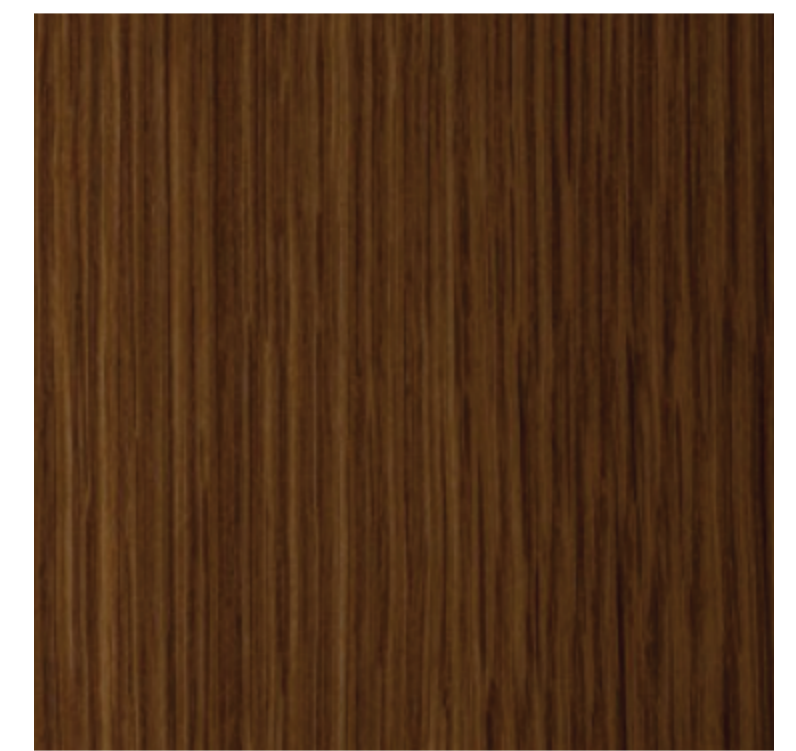
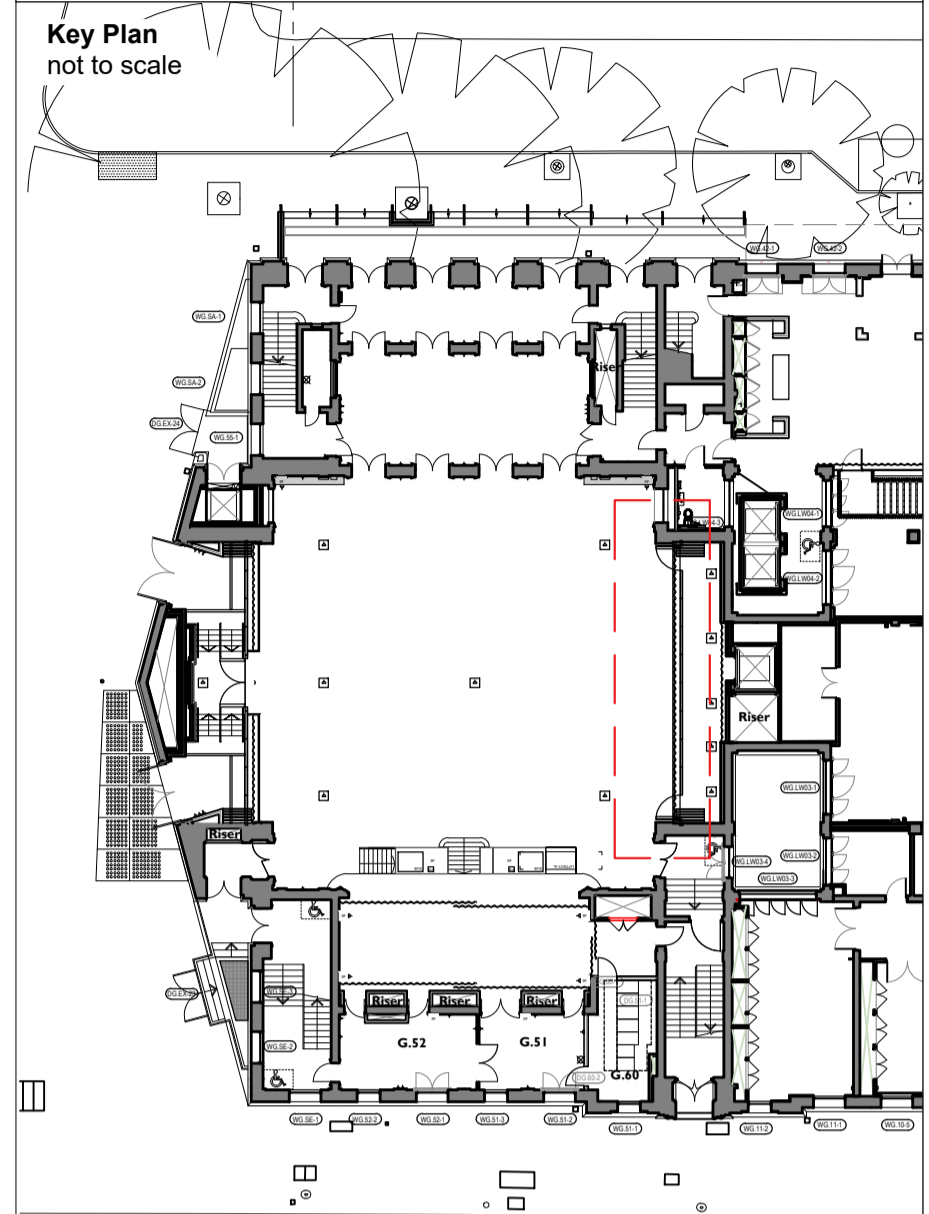

Perforated veneer

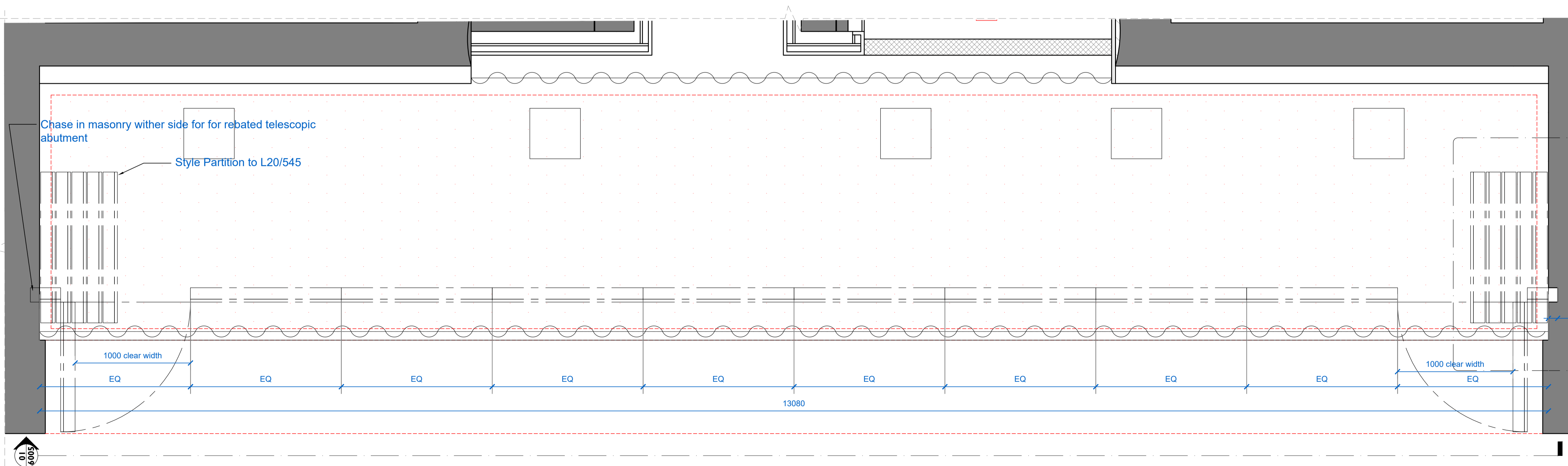

2 EVENT SPACE FOLDING PARTITION PLAN
6005 1:20

REV	DATE	BY	CHK	DESCRIPTION
C03	05.02.25	CL	JE	Update to moveable partition heights
C02	30.08.24	OB	OB	UPDATED FOR SIDE ACCESS DOORS
C01	14.06.24	ML	NS	STAGE 4 ISSUE

CLIENT
Il Bottaccio

PROJECT
Camden Town Hall Tenant Fitout

JOB NUMBER
242931

PURCELL

TITLE
EVENT SPACE MOVABLE PARTITION GA PLAN

SIZE SCALE
A1L 1:20

REV SUITABILITY/REASON FOR ISSUE
C03 A4 - Technical Design Approved

DRAWING NUMBER
242931-PUR-01-GF-DR-A-6005

PURCELL® IS THE REGISTERED TRADE NAME FOR PURCELL ARCHITECTURE LTD AND ALL SUBSIDIARY COMPANIES AND IS REGISTERED IN THE UNITED KINGDOM, EUROPEAN UNION, HONG KONG, CHINA AND AUSTRALIA. © PURCELL, 2024. www.purcell.com