

Notes:
 Drawings are based on survey data and may not accurately represent what is physically present.
 Do not scale from this drawing. All dimensions are to be verified on site before proceeding with the work.
 All dimensions are in millimetres unless noted otherwise.
 Purcell shall be notified in writing of any discrepancies.

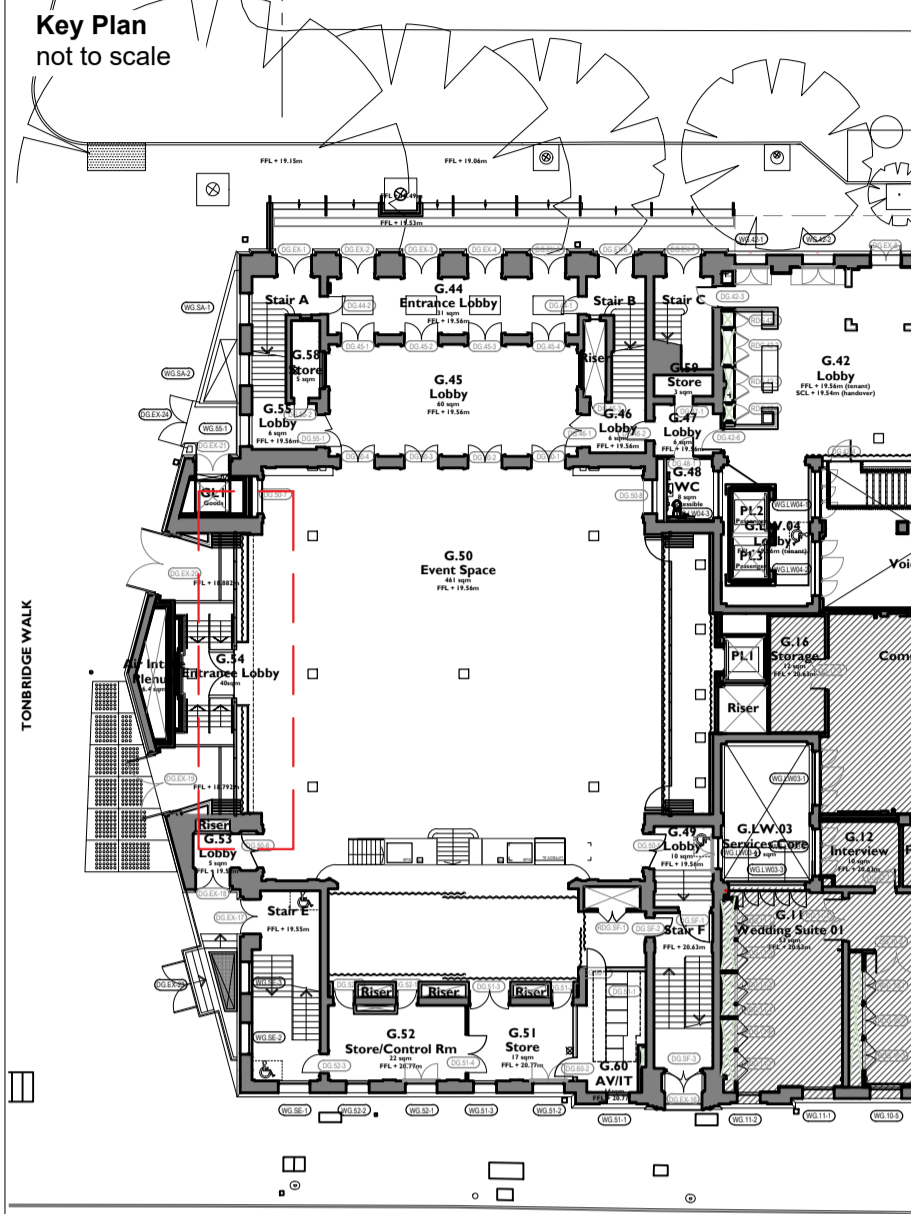

Perforated Veneer

1 TW ENTRANCE FOLDING PARTITION ELEVATION
 6004 1:20

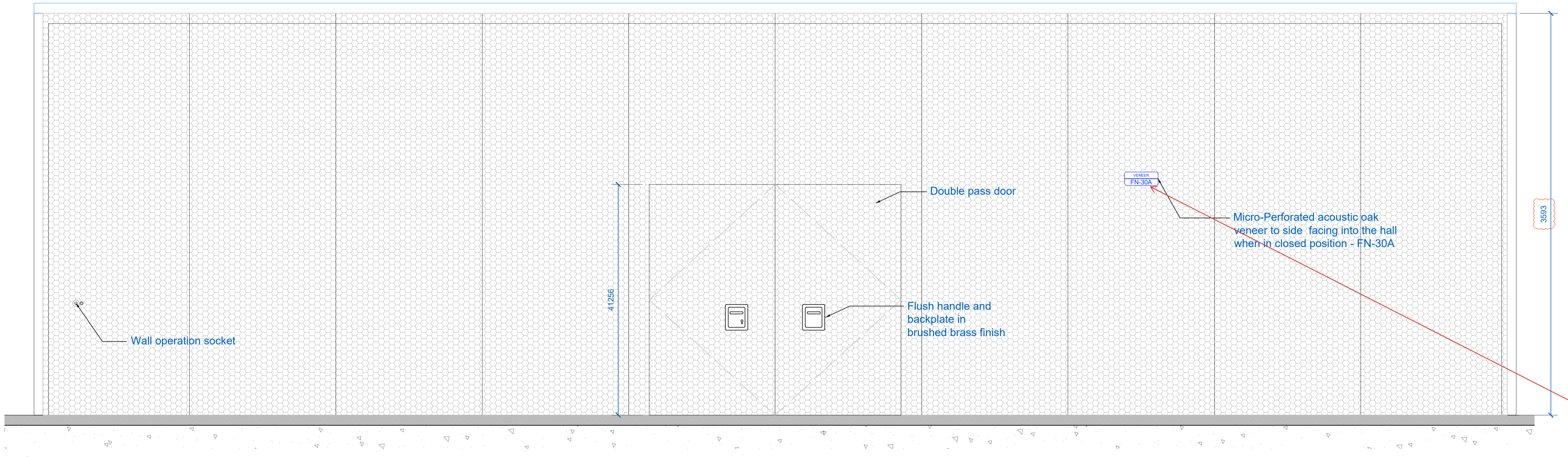
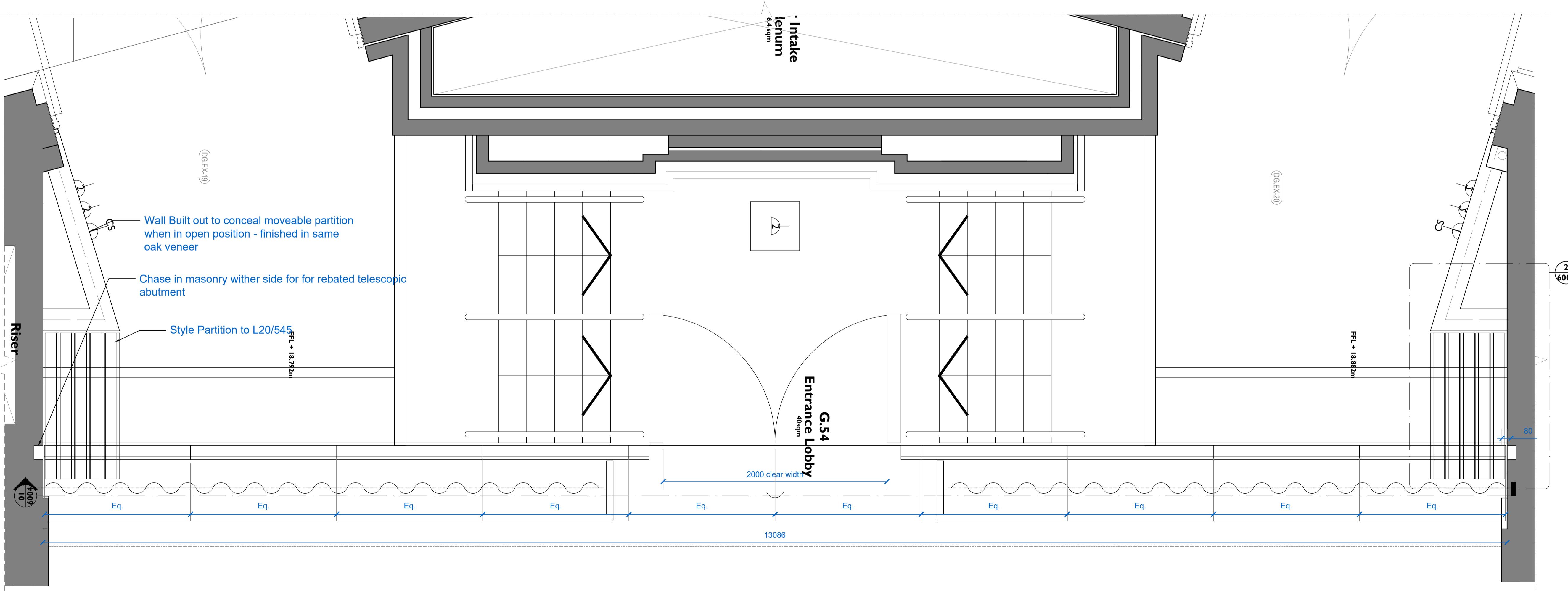

REV	DATE	BY	CHK	DESCRIPTION
C02	05.02.25	CL	JE	Update to moveable partition heights
C01	27.09.24	OB	OB	S4 First Issue

CLIENT
 Il Bottaccio

PROJECT
 Camden Town Hall Tenant Fitout

JOB NUMBER
 242931

PURCELL

TITLE
 TONBRIDGE ENTRANCE MOVEABLE PARTITION

SIZE SCALE
 A1L 1:20

REV SUITABILITY/REASON FOR ISSUE
 C02 A4 - Technical Design Approved

DRAWING NUMBER
 242931-PUR-01-XX-DR-A-6004

PURCELL® IS THE REGISTERED TRADE NAME FOR PURCELL ARCHITECTURE LTD AND ALL SUBSIDIARY COMPANIES AND IS REGISTERED IN THE UNITED KINGDOM, EUROPEAN UNION, HONG KONG, CHINA AND AUSTRALIA. ©PURCELL 2024. www.purcell.com

2 TW ENTRANCE FOLDING PARTITION PLAN
 6004 1:20