

**KEY**

Site Boundary

**Cycle Strategy Key**

Total Cycle Parking Spaces = 134

Cycle Stands (2 cycles per stand)

Accessible Cycle Spaces: 7 no.

Size for Accessible Cycle Space set out in 'Wheels for Well being Guidance'  
Enlarged Bay: W - 1500mm x L - 2000mm

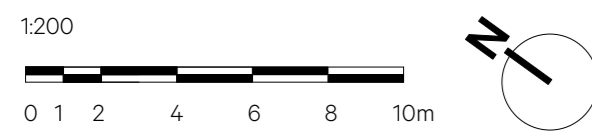
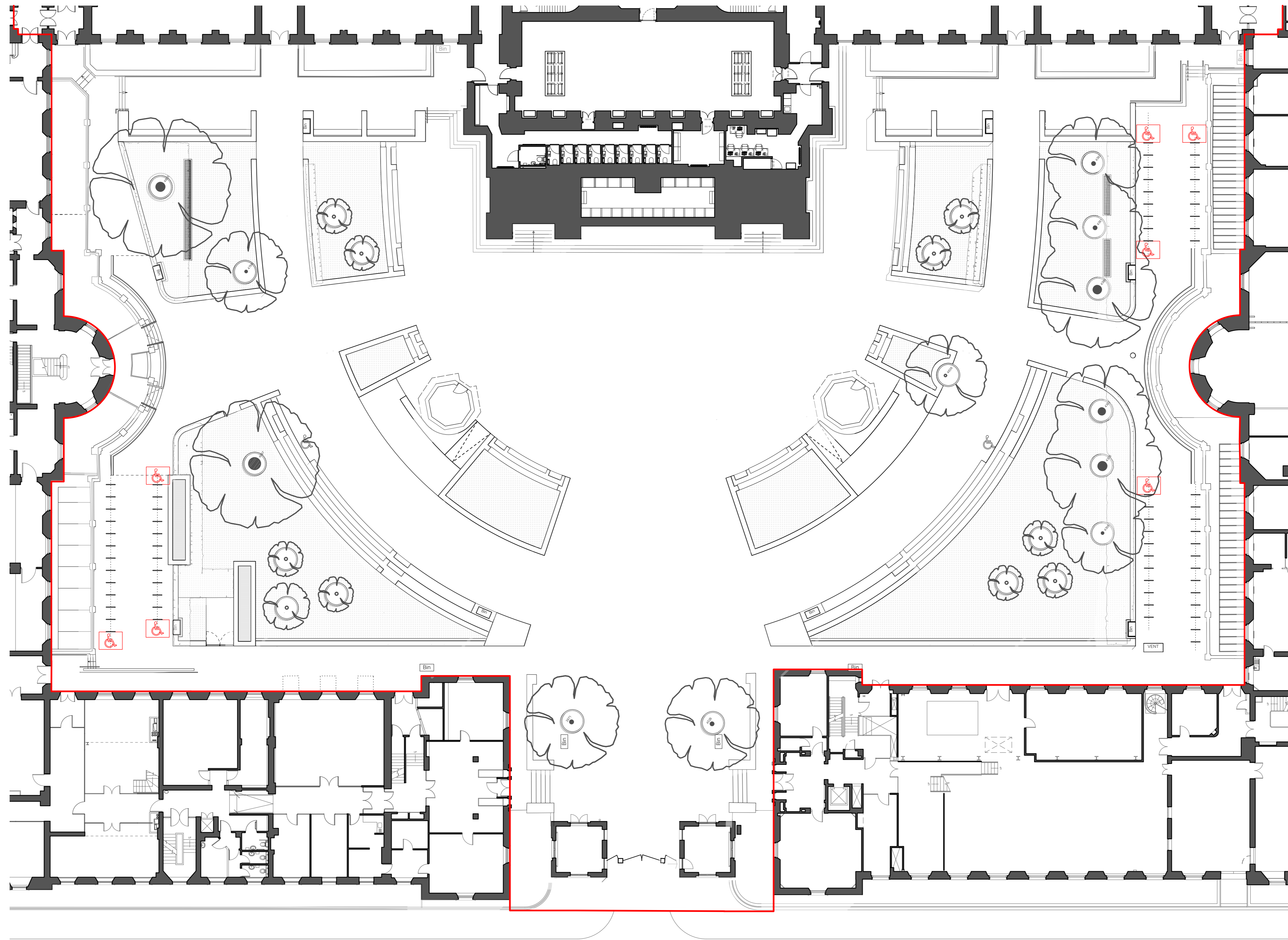

Date	Revision	Reviewed by	Issue Notes
23/05/2024	P1	GW	Preliminary Issue
04/06/2024	P2	GW	Cycle Parking adjacent to North Cloister entrances removed to accommodate new raised bed design
07/06/2024	P3	GW	Stage 03 Issue
23/07/2024	P4	GW	ISSUED FOR PLANNING - DRAFT
25/07/2024	P5	GW	ISSUED FOR PLANNING

NO DIMENSIONS ARE TO BE SCALED FROM THIS DRAWING. THE CONTRACTOR/MANUFACTURER IS RESPONSIBLE FOR CHECKING ALL DIMENSIONS AND QUERING ANY DISCREPANCIES. THIS DRAWING IS THE PROPERTY OF BURWELL ARCHITECTS LTD. COPYRIGHT IS RESERVED BY THEM AND THE DRAWING IS ISSUED ON CONDITION THAT IT IS NOT COPIED, REPRODUCED, RETAINED OR DISCLOSED TO ANY UNAUTHORISED PERSON, EITHER WHOLLY OR IN PART, WITHOUT WRITTEN CONSENT.

Project Title	UCL Bi-Centennial Main Quad & Wilkins	Project Director	NB	Project No.	979	Client	UCL London, WC1E 6BT
Drawn By	GW	Scale	1:200 @ A1	Design Firm	Unit 001 California Building Deals Gateway London SE13 7SB 020 8305 6010		
Sheet Title	Cycle Strategy	Date	19/03/2024	CAD File Name	979-G-0040 Series Main Quad GA Plan.vwx		
Revision	P5	Sheet No.	979_G_0049	Info	info@burwellarchitects.com www.burwellarchitects.com		